WESSEX



**AC120 and AX120
Sweeper
Collector**

**OPERATING MANUAL
and PARTS LIST**

WESSEX FARM MACHINERY SALES CO.

Trading Estate, Oakhanger Road, Bordon,
Hampshire, GU35 9HH.

Telephone: 01420 478111

24hrs parts hotline 01420 474319

**PLEASE READ THE FOLLOWING PAGES
CAREFULLY BEFORE USING YOUR MACHINE
AND KEEP THIS MANUAL IN A SAFE PLACE**

IMPORTANT SAFETY WARNING

All moving parts on your Wessex engine driven Sweeper-Collector are fully guarded for your protection. Ensure ALL operators are aware of the following:

1. NEVER use your Sweeper unless the safety guards are in place.
2. NEVER attempt to clear any obstructions around the rotor unless both the machine and vehicle are COMPLETELY at a standstill.
3. NEVER remove belt guards unless the machine is COMPLETELY at a standstill.
4. Take special care when tipping your Sweeper-Collector, hold winch handle **AT ALL TIMES**

HEALTH AND SAFETY - Noise at Work Regulations

In compliance with the above regulations, this machine has been tested in operation with a vehicle without a quiet cab working at 540 RPM with the following result:

READING AT THE OPERATORS EAR OF SWEEPER-COLLECTOR 85 D.B.A

WARRANTY

Your Wessex Sweeper-Collector is warranted free from defect in workmanship or manufacture for one year from date of purchase. Any parts which appear to us to be defective either in material or workmanship shall be replaced or repaired at no cost to the purchaser, subject to the following conditions:

- 1 The registration card enclosed with this booklet must be returned to us within seven days of purchase.
2. Any failure in the machine should be reported in the first instance to your dealer who will act on your behalf to resolve the matter to your satisfaction.
3. The defective parts will be returned by your dealer to us accompanied by a full statement describing the failure, and the circumstances and conditions in which the failure occurred, within 5 working days of failure.
4. The following are specifically excluded from the terms of warranty:
 - (a) Fair wear and tear, specially to belts and brushes.
 - (b) Damage to brushes caused through incorrect positioning of the rotor (See instructions).
 - (c) Damage caused by neglect or lack of lubrication.
 - (d) Damage caused by misuse or abuse.
 - (e) Damage caused while the machine is in transit.
 - (f) Damage caused to the frame of the machine by running the machine with an unbalanced rotor.
5. The warranty is for the benefit of the first user only.

SETTING UP YOUR WESSEX SWEEPER-COLLECTOR

Your Wessex Sweeper-Collector has been designed to work in a wide variety of conditions and is a very simple machine to use. There are one or two adjustments which ensure optimum performance in all conditions.

The Sweeper-Collector should be coupled to your vehicle using the ball hitch.

ADJUSTING THE ROTOR HEIGHT

The brush height can be adjusted by turning the drawbar adjuster.

The bristles should be in gentle contact with the ground for maximum pick up action (see diagram). If there is a drumming sound as the brush rotates, the brushes are set too low and should be raised immediately to avoid damage to the brushes.

The brushes alone are not designed for scarifying or thatch removal, and damage to the brushes will quickly occur if it is used for this purpose.

When using the Sweeper it is a good idea to start off with the rotor fully raised, and lower it if necessary until a satisfactory result is achieved.

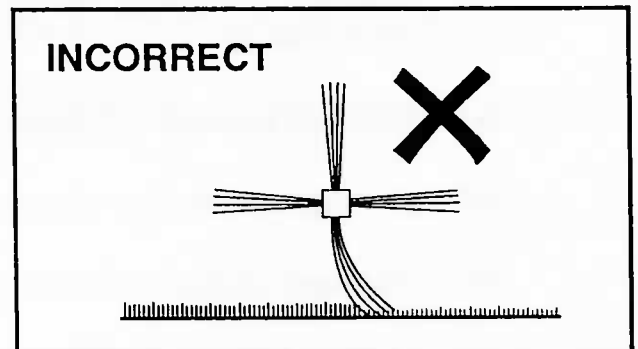
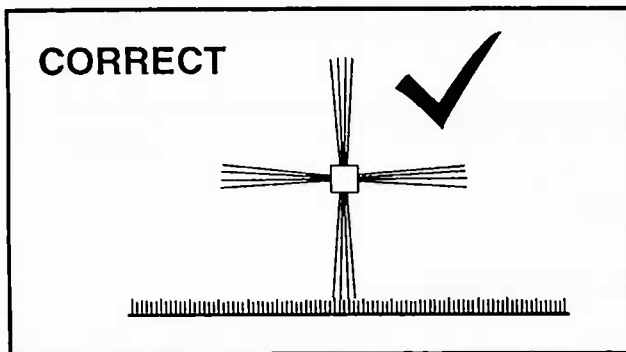

Conditions will vary on the same site from day to day, dependent on weather conditions. There are sufficient adjustments of the brush strip and of the rotor position to ensure that your Sweeper does a good job in all conditions. By experimenting with different adjustments you will quickly find the optimum setting to suit your conditions.

COMPENSATING FOR BRUSH WEAR

The bristles on your Sweeper rotor will wear in due course, and it will be necessary to adjust drawbar accordingly.

The Sweeper has been designed to work effectively until the bristles are approximately half their original length. When the bristles wear beyond this point there is insufficient momentum to throw the leaves and debris into the hopper, and it will be necessary to replace the brushes on your machine.

EMPTYING THE HOPPER

The hopper of the Wessex Sweeper tips forwards towards the vehicle using the hand winch. **REMEMBER, RETAIN HOLD OF HANDLE WHEN CLOSING HOPPER.**

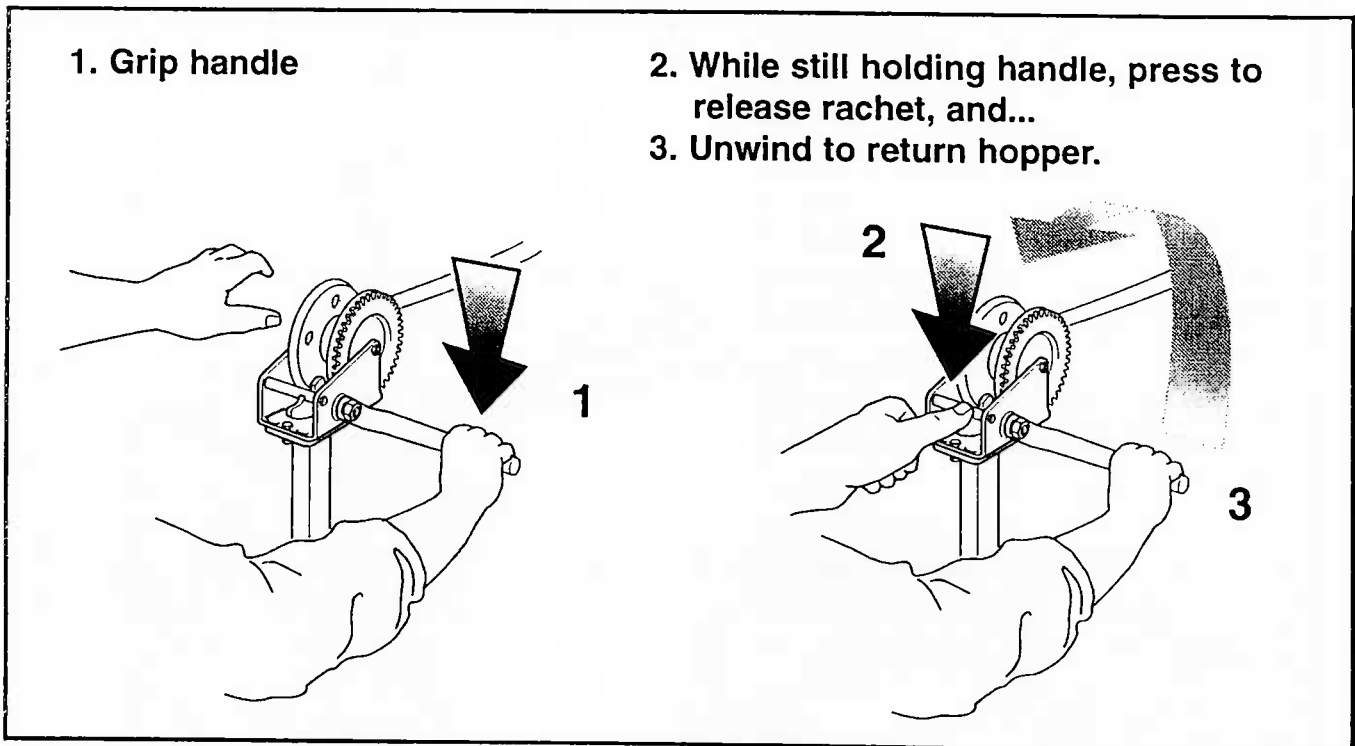

SCARIFYING OPTION

This has been designed for the sweeping of horse manure or any similar material which tends to stick in the grass.

Tines should be set a few millimetres below the brush tip to loosen any compacted material prior to sweeping.

ROUTINE MAINTENANCE

Rotor bearings & Cross
Shaft End Bearings

- Grease every 150 hours

Engine

- Refer to Engine Manual

Hopper Bearing

- Grease twice a year

Before putting the Sweeper away at the end of the season, we recommend that the inside of the rotor shroud is thoroughly cleaned, preferably with a power washer.

The rotor bearings are protected against ingress of dirt and grass but the rotor should be checked regularly and if string or other foreign objects get wound around the shaft, these should be removed immediately.

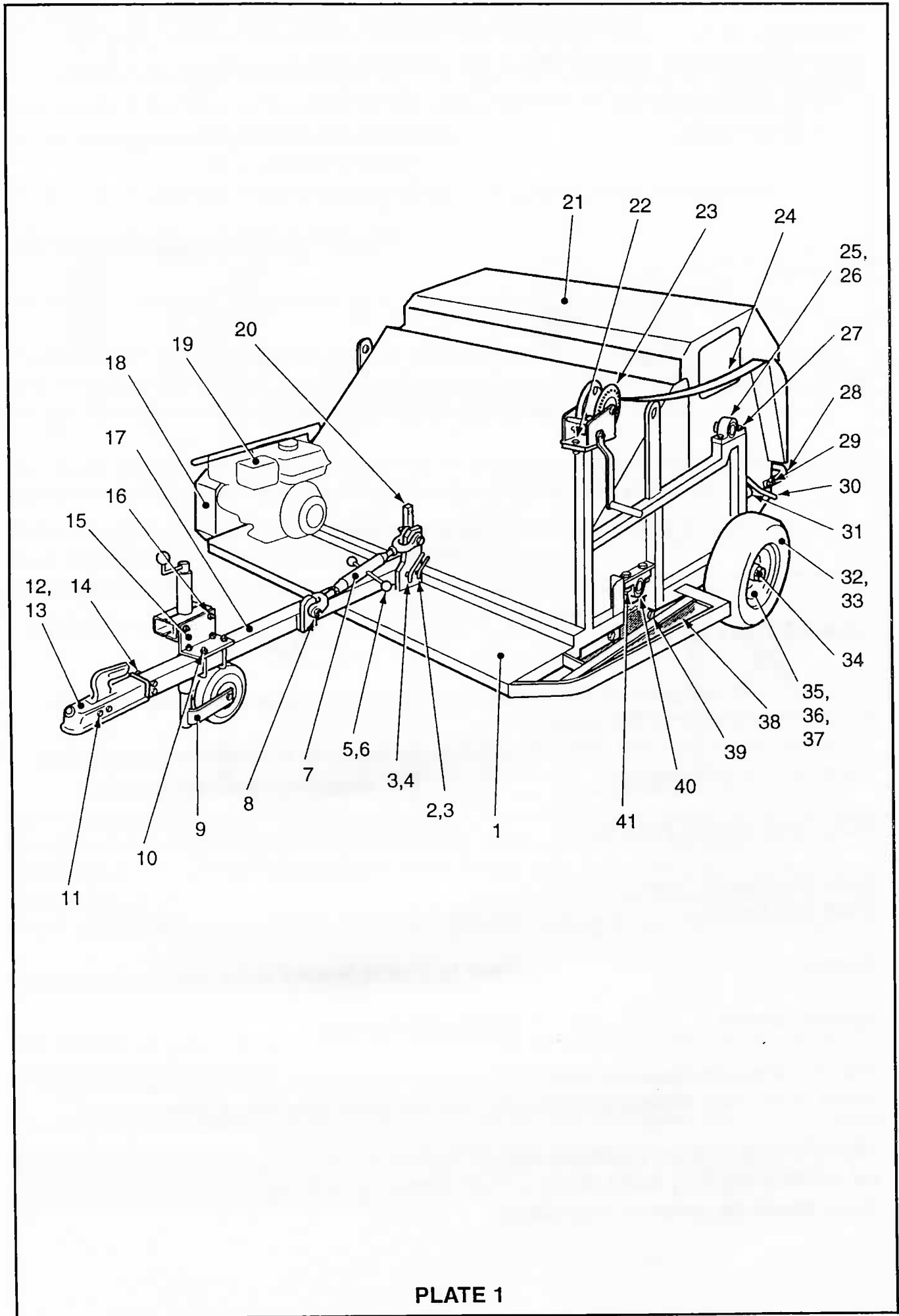

PLATE 1

PLATE 1 - PARTS LIST

<i>Position</i>	<i>Part No.</i>	<i>Qty</i>	<i>Description</i>
1	AC 7479	1	Mainframe
2	AC 5428	1	Stand Pin
3	AC 0121	1	R Clip
4	AC 3928	1	Drawbar Pin
5	AC 1129	1	Adjuster
6	AC 1129A	2	Ball Knob
7	AC 1029	1	Drawbar Adjuster
8	AC 17501	2	Fastening Set
9	AC 10956	1	Jockey Assembly
10	AC 7002	2	U Bolt Fastening Set
11	AC 9501	1	Ball Hitch Fastening Set
12	AC 9056	1	Ball Hitch
13	AC 9156	1	Swivel
14	AC 9601	1	Fastening Set
15	AC 11056	1	Jockey Bracket
16	AC 17901	1	Fastening Set
17	AC 12880	1	Drawbar
18	AC 7778	1	Belt Guard
19	AC 7757	1	B & S 5hp Engine
19	AC 7957	1	Honda 5hp Engine
20	AC 6884	1	Stand
21	AC 7579	1	Hopper
22	AC 19901	1	Fastening Set
23	AC 3430	1	Hand Winch
24	AC 3530	1	Strap
25	AC 0441	2	Hopper Bearing
26	AC 3301	2	Fastening Set
27	AC 2666	2	Hopper Trunion
28	AC 7678	1	Hopper Guard Rail
29	AC 20001	2	Fastening Set
30	AC 11156	1	Hopper Catch
31	AC 8280	2	Hopper Buffer
32	ACB 5351	2	Tube
33	ACB 5551	2	Tyre
34	AC 4951	2	Hub Cap
35	AC 1538	2	Wheel Bearing Inner
36	AC 1638	2	Wheel Bearing Outer
37	AC 0645	2	Oil Seal
38	AC 5078	1	Skirt
39	AC 20101	8	Fastening set
40	AC 0541	2	Rotor Bearing
41	AC 3301	2	Fastening Set

PLATE 2 - PARTS LIST

<i>Position</i>	<i>Part No.</i>	<i>Qty</i>	<i>Description</i>
1	AC 2266	1	Rotor
2	AC 5001	4	Fastening set
3	AC 5662	1	Drive Pulley
4	AC 1247	1	Key
5	AC 2534	2	Belt
6	AC 1062	1	Rotor Pulley
7	AC 0147	1	Key
8	AC 2870	8	Brush Strip AC120
8	AC 7570	8	Brush Strip AX120
9	AC 6902	1	Jockey Bolt
10	AC 0722	1	Circlip
11	AC 0622	2	Circlip
12	AC 1438	2	Jockey Bearing
13	AC 1862	1	Jockey Pulley
14	AC 20201	1	Nylock Nut
15	AC 0227	1	Linch Pin
16	AC 8966	1	Jockey Lever

PLATE 3 - PARTS LIST

<i>Position</i>	<i>Part No.</i>	<i>Qty</i>	<i>Description</i>
1	AX 20201	4	Fastening Set
2	AX 20501	4	Fastening set
3	AX 4158	1	Tine Mount Carrier
4	AX 20601	8	Fastening Set
5	AX 3125	8	Scarifying Tine
6	AX 3958	1	Tine Mount R.H.
7	AX 4058	1	Tine Mount L.H.
8	AX 1226	2	Shoot Bolt



ATTENTION DESCRIPTION OF PICTOGRAMS
ATTENTION DESCRIPTION DES PICTOGRAMMES
VORSICHT BESCHREIBUNG DER PIKTOGRAMMEN

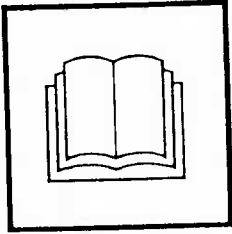

GB Read Operating manual before use.
F Lisez Manual D'Opération avant l'utilisation.
D Vor der Benutzung, Betriebshandbuch lesen.

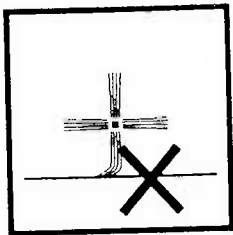

GB Damage to brushes will occur if set too low.
F Des brosses souffriront les dommages si on les règle à un niveau trop bas.
D Schäden an den Bürsten werden verursacht, wenn man sie zu niedrig einstellt.

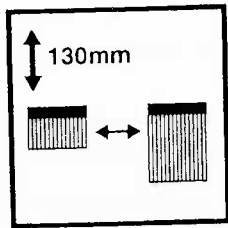

GB Replace brushes when worn to 130mm of bristle.
F Remplacer les brosses quand elles sont usées jusqu'à 130mm de poils.
D Bürsten ersetzen, wenn sie bis zu 130mm von Borsten abgenutzt werden.

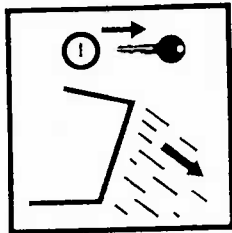

GB Always stop rotor before emptying hopper.
F Toujours arrêtez le rotor avant de vider la trémie.
D Rotor immer abstellen, bevor man den Einfülltrichter entleert.

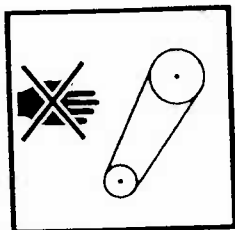

GB Never remove guards or attempt adjustment until rotor has stopped.
F Ne pas enlever ni les dispositifs de sûreté ni essayer le réglage avant que le rotor s'arrête.
D Schutzvorrichtung niemals abnehmen oder Einstellung versuchen, bevor der Rotor abgestellt.

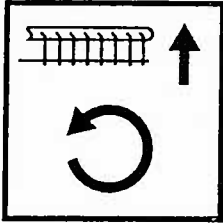

GB When scarifying, lift rotor before turning.

F Quand on scarifie, levez le rotor avant de le tourner.

D Beim skarifizierung, muß man den rotor, bevor man er umdreht.



GB Bystanders must be at least 20 metres from machine range of action

F Des spectateurs doivent s'écarter au moins 20 mètres du rayon d'action de la machine.

D Umstehenden müssen sich mindestens 20 meter vom maschinenbetriebsraum entfernen.