



ATC120 and ATX120 Sweeper Collector

OWNER'S MANUAL



Manufacturers and European Distributors of Quality Equipment

Broadwood International
Bordon Trading Estate
Oakhanger Road
Bordon
Hampshire GU35 9HH

T 01420 478111
F 01420 483000
E sales@broadwoodintl.co.uk
W www.broadwoodintl.co.uk

**PLEASE READ THE FOLLOWING PAGES
CAREFULLY BEFORE USING YOUR MACHINE
AND KEEP THIS MANUAL IN A SAFE PLACE**

IMPORTANT SAFETY WARNING

Wessex sweepers are guarded for your protection but you must always observe certain elementary precautions. Sweepers are potentially dangerous machines and should be used with the greatest respect. Ensure that ALL operators are aware of the following

1. Never attempt any adjustment whatever, unless the machine **and ALL its moving parts are COMPLETELY at a standstill.**
2. NEVER attempt to clear any obstructions around the machine unless **ALL its moving parts are COMPLETELY at a standstill, and the engine is switched off.**
3. Never remove belt guards before all moving parts have come to a **complete standstill** and the **engine is switched off.**
4. Never operate the machine with the safety guards removed. They are there for your protection.
5. NEVER operate the machine with people behind; keep everybody (especially children) at a safe distance (minimum 20 metres)
6. Stand well back from the machine when brushes are spinning
7. Read the instruction manual supplied with this booklet relating to the engine fitted to your machine.

HEALTH AND SAFETY - Noise at work Regulations -

In compliance with the above regulations, this machine has been tested in operation with the following result;

READING AT THE OPERATORS EAR

ATC / ATX Series Engine driven sweepers: 97.5 D.B.A

Depending on conditions and material being cut, this may alter; it is therefore advisable for users to do their own assessment.

WARRANTY

Your Wessex PTO driven Sweeper-Collector is warranted free from defect in workmanship or manufacture for one year from date of purchase. Any parts which appear to us to be defective either in material or workmanship shall be replaced or repaired at no cost to the purchaser, subject to the following conditions:

1. The registration card enclosed with this booklet must be returned to us within seven days of purchase.
2. Any failure in the machine should be reported in the first instance to your dealer who will act on your behalf to resolve the matter to your satisfaction.
3. The defective parts will be returned by your dealer to us accompanied by a full statement describing the failure, and the circumstances and conditions in which the failure occurred, within 5 working days of failure.
4. The following are specifically excluded from the terms of warranty:
 - (a) Fair wear and tear, especially to belts and brushes.
 - (b) Damage to brushes caused through incorrect positioning of the rotor (See instructions).
 - (c) Damage caused by neglect or lack of lubrication.
 - (d) Damage caused by misuse or abuse.
 - (e) Damage caused while the machine is in transit.
 - (f) Damage caused to the frame of the machine by running the machine with an unbalanced rotor.
5. The warranty is for the benefit of the first user only.
6. Wessex Machinery decisions will be final and binding.

SETTING UP YOUR WESSEX SWEEPER COLLECTOR

Your Wessex Sweeper-Collector has been designed to work in a wide variety of conditions and IS a very simple machine to use There are one or two adjustments which ensure optimum performance in all conditions.

The sweeper-Collector should be coupled to your vehicle using the ball hitch.

ADJUSTING THE ROTOR HEIGHT

The brush height can be adjusted by turning the adjuster.

The bristles should be in gentle contact with the ground for maximum pick up action (see diagram).

If there is a drumming sound as the brush rotates, the brushes are set too low and should be raised immediately to avoid damage to the brushes.

The brushes alone are not designed for scarifying or thatch removal, and damage caused to the brushes will quickly occur if it is used for this purpose.

When using the sweeper it is a good idea to start off with the rotor fully raised, and lower it if necessary until a satisfactory result is achieved.

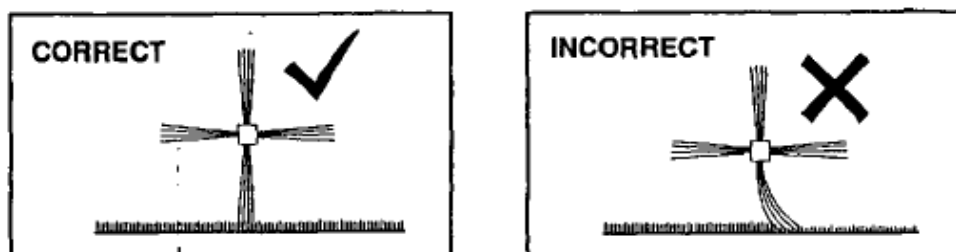

Conditions will vary on the same site from day to day, dependant on weather conditions There are sufficient adjustments of the brush strip and of the rotor position to ensure that your sweeper does a good job in all conditions By experimenting with different adjustments you will quickly find the optimum setting to suit your conditions.

COMPENSATING FOR BRUSH WEAR

The bristles on your sweeper rotor will wear in due course, and it will be necessary to adjust the height accordingly.

The sweeper has been designed to work effectively until the bristles are approximately half their original length. When the bristles wear beyond this point there is insufficient momentum to throw the leaves and debris into the hopper, and it will be necessary to replace the brushes on your machine.

EMPTYING THE HOPPER

The hopper of the Wessex Sweeper tips forward towards the vehicle using the hand winch
REMEMBER, RETAIN HOLD OF HANDLE WHEN CLOSING HOPPER.

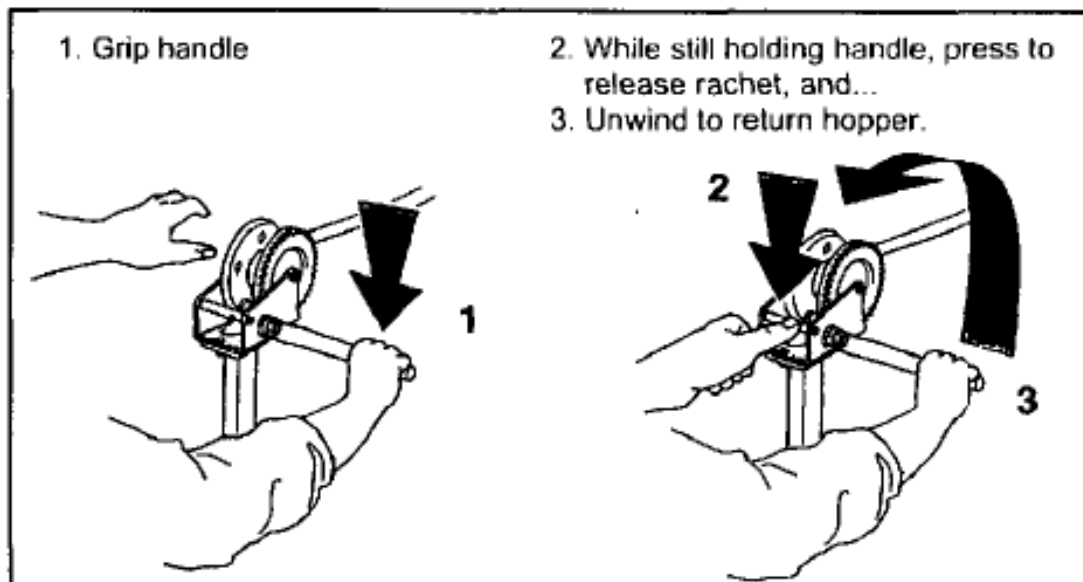

SCARIFYING OPTION

This has been designed for the sweeping of horse manure or any similar material which tends to stick in the grass

Tines should be set a few millimetres below the brush tip to loosen any compacted material prior to sweeping.

MAINTENANCE

Check ALL FASTENING SETS after first 8 hours of work.

Rotor bearings & cross

Shaft End Bearings

- Grease every 150 hours of work

Engine

- Refer to Engine Manual

Hopper Bearing

- Grease twice per year

Before putting the Sweeper away at the end of the season, we recommend that the inside of the rotor shroud is thoroughly cleaned. Preferably with a power washer

The rotor bearings are protected against ingress of dirt and grass but the rotor should be checked regularly and if string or other foreign objects get wound around the shaft. These should be removed immediately.

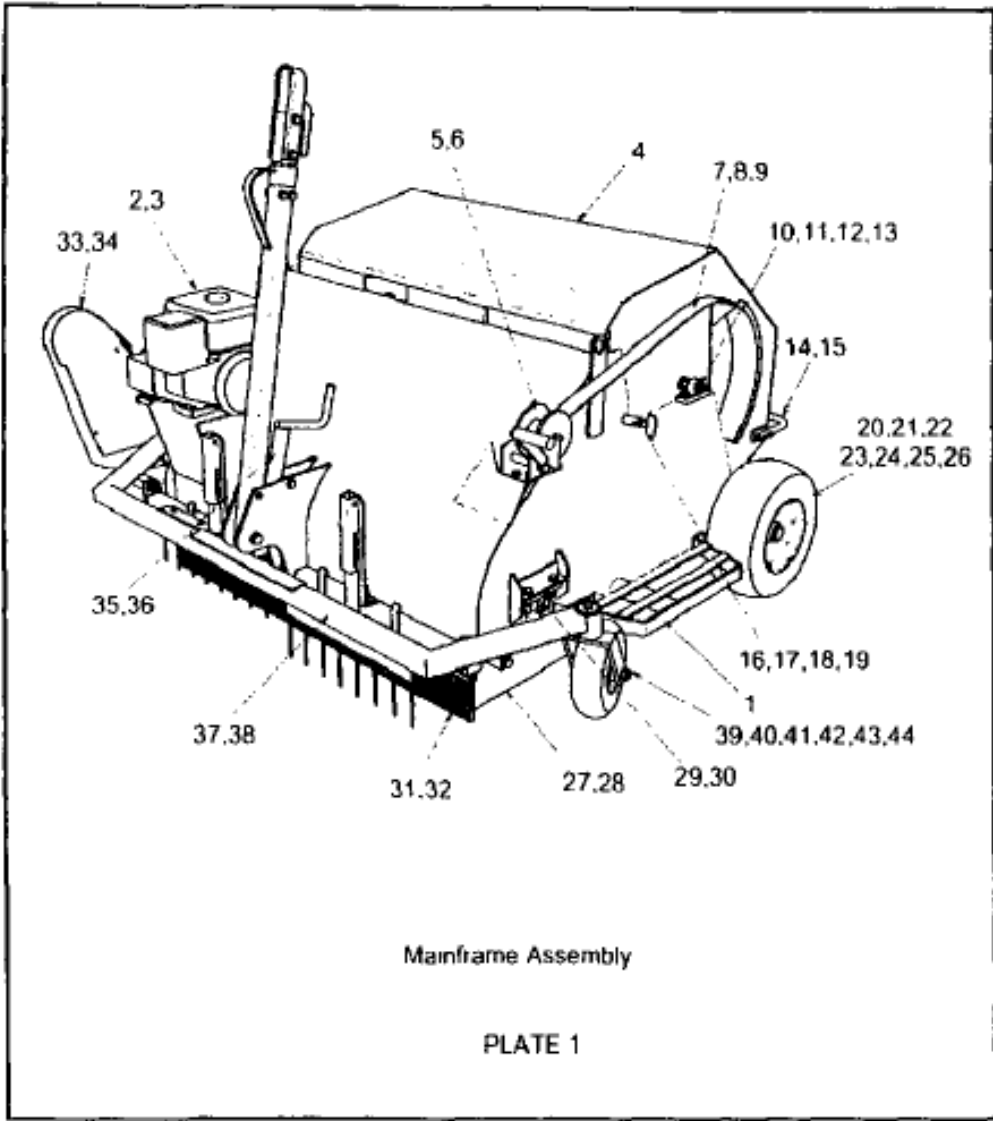

PLATE 1 - PARTS LIST - MAINFRAME

Position	Part No	Qty.	Description
1	WX-11079	1	Mainframe
2	WX-1560	1	Engine (Honda)
3	WX-26401	1	Fastening Set
4	WX-11179	1	Hopper
5	WX-3430	1	Winch
6	WX-9503	1	Fastening Set
7	WX-3530	1	Winch Strap
8	WX-9603	1	Fastening Set
9	WX-2820	1	Support Tube
10	WX-2666	2	Hopper Trunion
11	WX-9703	2	Fastening Set
12	WX-0441	1	Hopper Bearing
13	WX-26001	1	Fastening Set
14	WX-9878	1	Hopper Guard Rail
15	WX-9903	1	Fastening Set
16	WX-1626	1	Tee Knob
17	WX-1726	1	Shoot Bolt
18	WX-3625	1	Spring
19	WX-3722	1	Roll Pin
20	WX-1352	2	Wheel (complete)
21	WX-B5551	2	Tube
22	WX-B5351	2	Tyre
23	WX-4951	2	Hub Cap
24	WX-1538	2	Wheel Bearing - Inner
25	WX-1638	2	Wheel Bearing - Outer
26	WX-0645	2	Oil Seal
27	WX-10078	2	Skirt
28	WX-10203	2	Fastening Set
29	WX-0341	2	Rotor Bearing
30	WX-10803	2	Fastening Set
31	WX-1676	1	Front Brush
32	WX-10703	1	Fastening Set
33	WX-12677	1	Belt Guard
34	WX-26201	1	Fastening Set
35	WX-13880	1	Height Adjuster
36	WX-0503	1	Fastening Set
37	WX-10253	1	Front Wheel Mount
38	WX-26101	1	Fastening Set
39	WX-13151	2	Wheel Fork
40	WX-1520	2	Special Washer
41	WX-6303	2	Fastener Set
42	WX-4252	2	Mk I Front Wheel (Takes 1 inch axle)
42	WX-4352	2	MK II Front Wheel (Takes 12mm axle)
42	WX-4552	2	MK III Front Wheel (White with solid Tyre)
43	WX-4451	2	Mk I Wheel Axle (1inch)
43	WX-6003	2	MK II/III Wheel Axle (12mm)
44	WX-4551	4	Front Axle Spacer

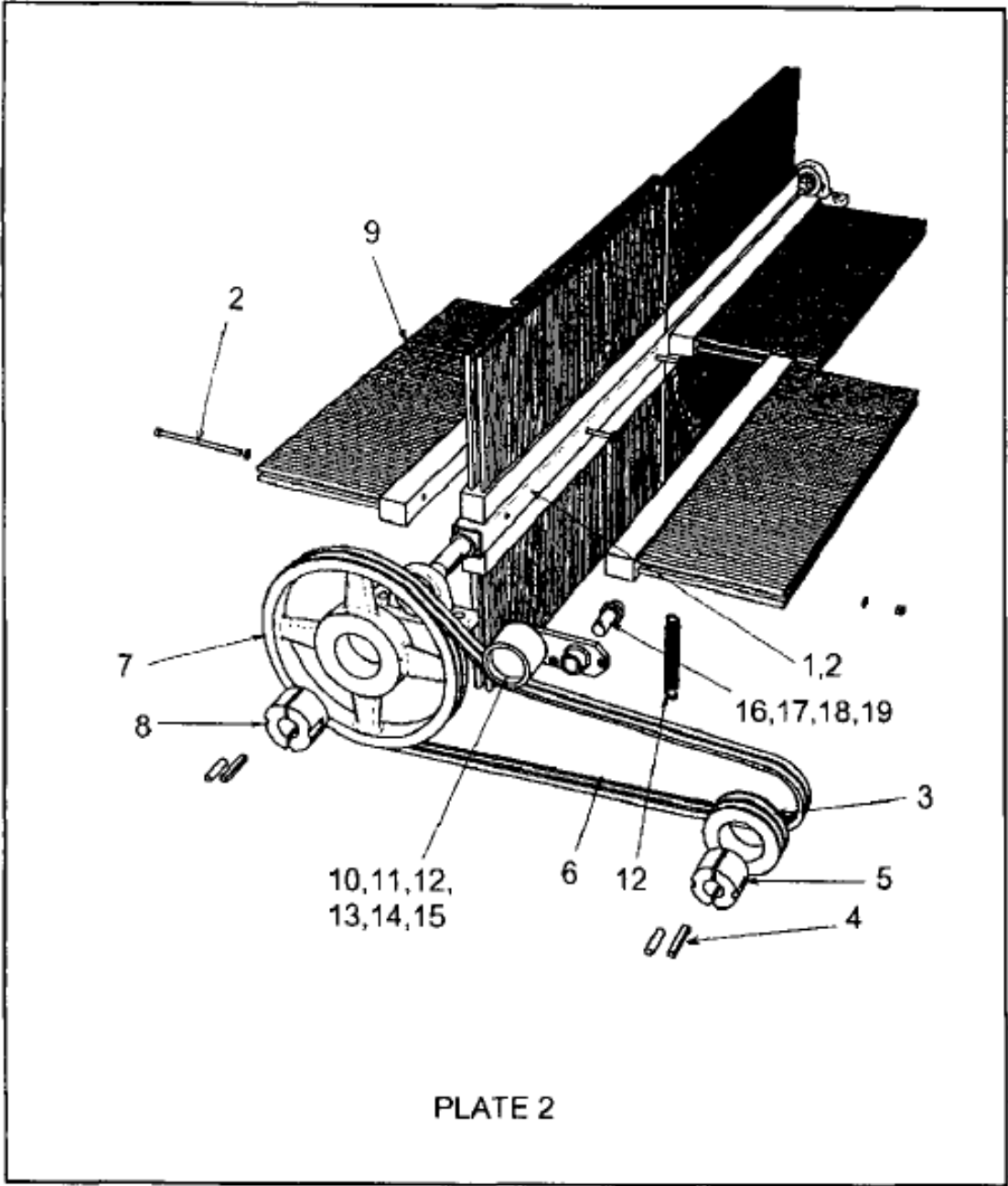

PLATE 2

PLATE 2 - PARTS LIST - BRUSH ROTOR

Position	ATC 120 Part No.	Qty	ATX 120 Part No.	Qty	Description
1	WX-11066	1	WX-11066	1	Brush Rotor
2	WX-5001	4	WX-5001	4	Fastening Set
3	WX-6262	1	WX-6262	1	Pulley
4	WX-0147	2	WX-0147	2	Key
5	WX-6362	1	WX-6362	1	Taper Lock
6	WX-3634	2	WX-3634	2	Drive Belt
7	WX-6462	1	WX-6462	1	Pulley
8	WX-6562	1	WX-6562	1	Taper Lock
9	WX-2870	8	WX-7570	8	Brush Strip
10	WX-1862	1	WX-1862	1	Jockey Pulley
12	WX-1438	2	WX-1438	2	Jockey Bearings
13	WX-0622	2	WX-0622	2	Circlip
14	WX-0722	1	WX-0722	1	Circlip
15	WX-2466	1	WX-2466	1	Jockey Bracket
16	WX-0425	1	WX-0425	1	Spring
17	WX-1738	1	WX-1738	1	Bush
18	WX-2566	1	WX-2566	1	Pivot
19	WX-0715	1	WX-0715	1	Washer

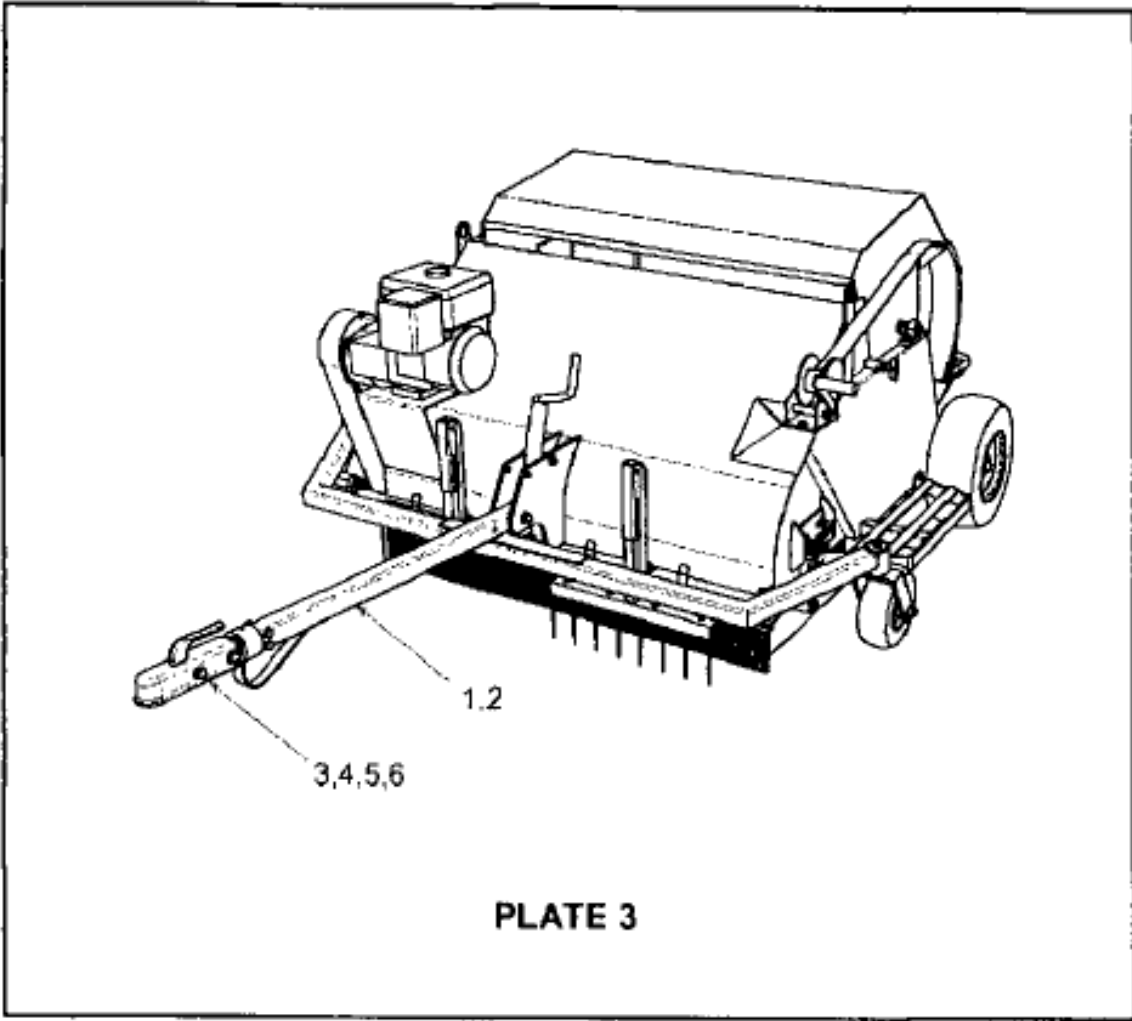

PLATE 3

PLATE 3 - PARTS LIST - DRAWBAR ASSEMBLY

Position	Part No.	Qty	Description
1	WX-12880	1	Drawbar
2	WX-4503	1	Fastener Set
3	WX-2356	1	Tow Hitch
4	WX- 1503	1	Fastening Set
5	WX- 12156	1	Tow Hitch Swivel
6	WX-1403	1	Fastening Set

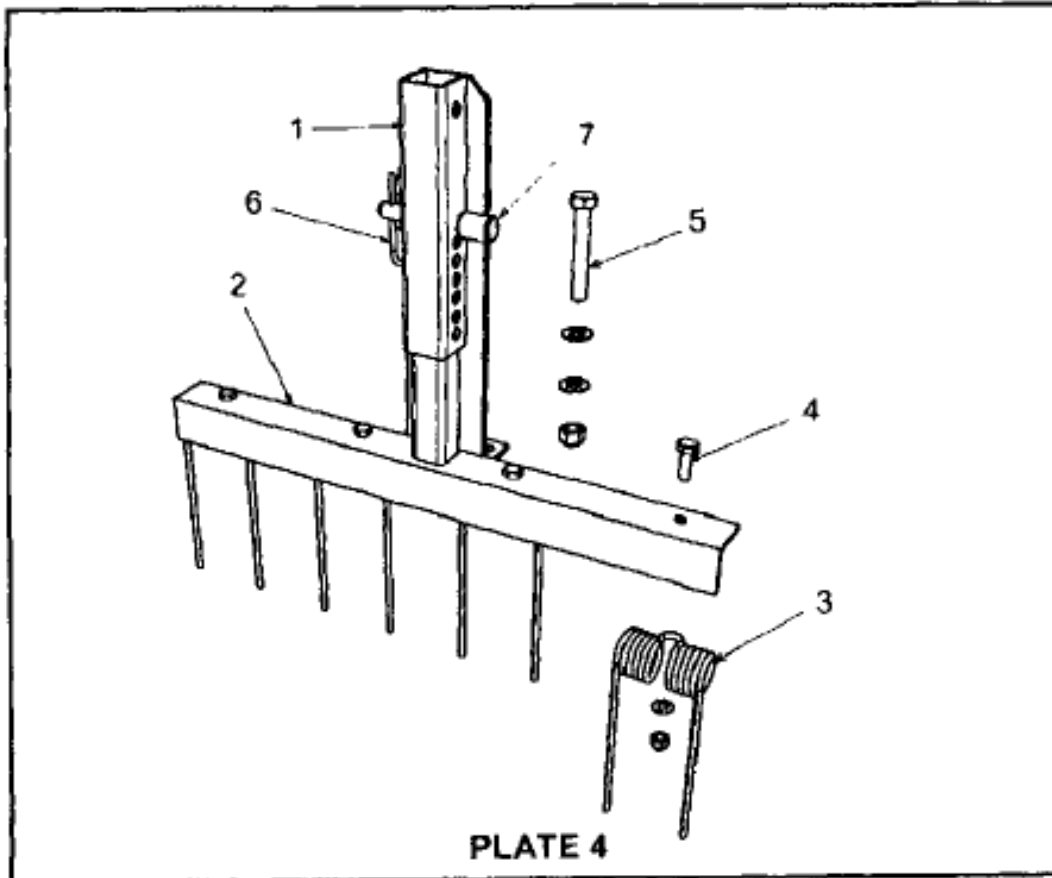

PLATE 4 - PARTS LIST - TINE SET, OPTION

Position	Part No.	Qty	Description
1	WX-7158	2	Tine Bracket
2	WX-7258	2	Tine Bar
3	WX-3125	8	Tine
4	WX-11303	2	Fastener Set
5	WX-26301	2	Fastener Set
6	WX-0121	2	R Clip
7	WX-1128	2	Retaining Pin

SAFETY LABELS



1	<ul style="list-style-type: none"> • GB • F • D 	ATTENTION ATTENTION VORSICH	DESCRIPTION OF PICTOGRAMS DESCRIPTION DES PICTOGRAMMES BESCHREIBUNG DER PIKROGRAMMEN
2	<ul style="list-style-type: none"> • GB • F • D 	Do not use without p.t.o. sharft guard. Ne pas utilise sans le dipositif de sûreté de l'arbre p.t.o. (arbre d'entraînement). Nicht benutzen ohne p.t.o. (antriebswelle) schutzvorrichtung	
3	<ul style="list-style-type: none"> • GB • F • D 	Never remove guards or attempt adjustment until rotor has stopped. Ne pas enlever ni les dispositifsde sûreté ni essayer le regal ge avant que le rotor s'arrête. Schutzvorrichtung niemals abnehmen oder einstellung versuchen, bevore der rotor abstellt.	
4	<ul style="list-style-type: none"> • GB • F • D 	Read operating manual before use. Lisez Manual D'Opéreation avant l'utilisation. Vor der, Betriebshandbuch lesen.	
5	<ul style="list-style-type: none"> • GB • F • D 	Ear defenders must be worn. Des serre-têtes doivent être portés. Ohrenschützer müssen getragen warden.	
6	<ul style="list-style-type: none"> • GB • F • D 	Bystanders must be at least 20 metres from machine range of action. Des spectateurs doivent s'écarter au moins metres du rayon d'action de la machine. Umstehenden müssen sich mindestens 20 meter vom maschinenbetriebsraum entfernen.	

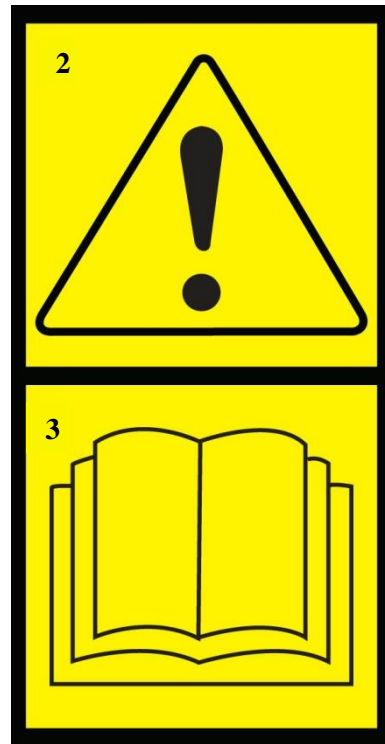

1	<ul style="list-style-type: none"> • GB • F • D 	<p>Protective eyewear, footwear, gloves and ear protectors must be worn.</p> <p>Lunettes de protection, chaussures, gants, protégés-oreilles doivent être portées.</p> <p>Schutzbrille, schuhe, handschuhe und Gerhorschutz getragen werden muss.</p>
2	<ul style="list-style-type: none"> • GB • F • D 	<p>ATTENTION DESCRIPTION OF PICTOGRAMS</p> <p>ATTENTION DESCRIPTION DES PICTOGRAMMES</p> <p>VORSICH BESCHREIBUNG DER PICTOGRAMMEN</p>
3	<ul style="list-style-type: none"> • GB • F • D 	<p>Read operating manual before use.</p> <p>Lisez Manual D'Opération avant l'utilisation.</p> <p>Vor der, Betriebshandbuch lesen.</p>

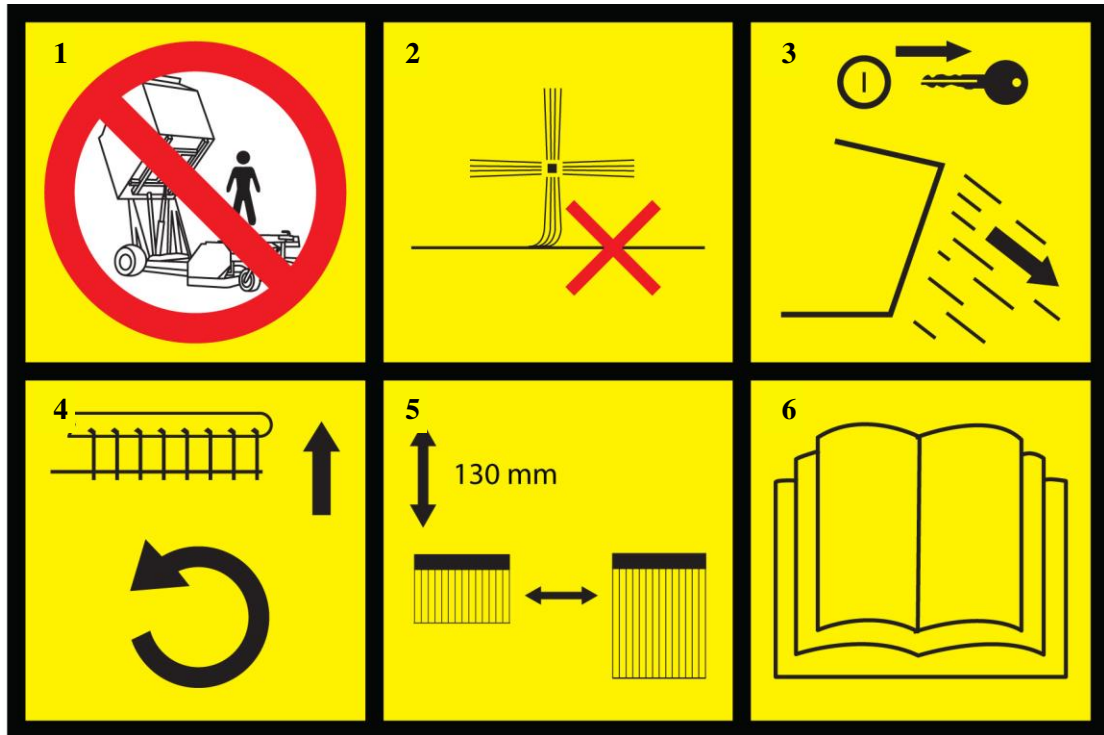

1	<ul style="list-style-type: none"> • GB • F • D 	<p>Keep clear of unpropped body Reculez de la machine élévee. Nicht in die ungeschützte Maschine fassen</p>
2	<ul style="list-style-type: none"> • GB • F • D 	<p>Damage to brushes if set too low Ne montez pas la brosse très bas Bürsten können beschädigt werden, wenn sie zu tief eingestellt sind.</p>
3	<ul style="list-style-type: none"> • GB • F • D 	<p>Always stop rotor before emptying hopper. Arrêtez le rotor avant de vider la trémie Rotor muss vor Entleerung des Behälters zum Stillstand Kommen.</p>
4	<ul style="list-style-type: none"> • GB • F • D 	<p>When scarifying, lift rotor before turning. À la course de rayer, élevez le rotor avant de tourner la machine Beim vertikutieren (Grasnarbe aufreißen) muss der Rotor vor Richtungsveränderungen (Kurven) angehoben werden.</p>
5	<ul style="list-style-type: none"> • GB • F • D 	<p>Replace brushes when worn to 130mm of bristle. Remplacez la brosse à 130 mm de longueur de poil. Die Bürsten sind zu wechseln, wenn die Borsten nur noch 130mm lang sind.</p>
6	<ul style="list-style-type: none"> • GB • F • D 	<p>Read operating manual before use. Livre d'exploitation lire avant tout utilisation. Less die Bedienungsanleitung vor dem Gebrauch.</p>



Certificate of CE Conformity

Machine Model: ATC 120, ATX 120

Description: Collector

*I hereby certify that the machine detailed hereon
conforms to:*

European Directives 89/392EEC

as amended 91/368EEC - 93/44EEC - 93/68EEC

Signed:

A handwritten signature in black ink, appearing to be a stylized name, possibly "R. J. ...".

Date: 6th June 2008

Quality Manager



Broadwood International

Trading Estate, Oakhanger Road, Bordon, Hampshire GU35 9HH
T: 01420 478111 F: 01420 483000 E: info@broadwoodintl.co.uk