

FIELDMASTER PASTURE TOPPERS

3/70 3/90 3/105

PARTS LIST and OPERATING INSTRUCTIONS.

WESSEX
Wessex Farm Machinery Sales Co.

Trading Estate
Oakhangor Road, Bordon
Hampshire GU35 9HH
Telephone: 0420 478111
24 hr. Parts Hot Line: 0420 474319

PLEASE READ THE FOLLOWING
PAGES CAREFULLY BEFORE
USING YOUR MACHINE

C. O. S. H. H.

NOISE AT WORK REGULATIONS

In compliance with the above regulations now in force, this machine has been tested in operation with a Compact Tractor without a quiet cab and working at 540 R.P.M. with the following result:-

Reading at the operators ear	FIELDMASTER	3/70	97.5	D.B.A.
		3/90	98	D.B.A.
		3/105	95	D.B.A.

IMPORTANT SAFETY WARNING

Fieldmaster mowers are guarded for your protection but you must always observe certain elementary precautions. Rotary mowers are potentially dangerous machines, and should be used with the greatest respect. Ensure that all operators are aware of the following:

1. Never attempt any adjustment whatever unless the machine is **completely** at a standstill.
2. Never attempt to clear any obstruction around the mower unless the machine is **completely** at a standstill.
3. Never remove belt guards unless the machine is **completely** at a standstill.
4. Never remove safety guards which are provided for your protection.
5. Never operate the mower with people behind; keep everybody (especially children) at a safe distance.
6. Stand well back from the machine, when cutters are spinning.
7. Regularly, inspect the blades and fixing bolts to ensure that they are in tip-top condition. Replace blades immediately any fracture or excessive wear becomes apparent. Serious damage which is excluded from our warranty conditions may result from using your Fieldmaster with an unbalanced rotor. When replacing blades, always fit new mounting bolts and nuts.
8. If operating in public areas be sure to fit rubber safety guards, which are available as an optional extra. These are fitted to prevent flying stones.

WARRANTY

Your Fieldmaster rotary mower is warranted free from defect in workmanship or manufacture for 1 year from date of purchase, with the exception of gearbox seals (ninety days). Any parts which appear to us to be defective either in material or workmanship shall be replaced or repaired at no cost to the purchaser, subject to the following conditions:

1. The registration card enclosed with this booklet must be returned to us within seven days of purchase.
2. Any failure in the machine should be reported in the first instance to your dealer who will act on your behalf to resolve the matter to your satisfaction.
3. The defective parts will be returned by your dealer to us accompanied by a full statement describing the failure, and the circumstances and conditions in which the failure occurred, within five working days of failure.
4. The following are specifically excluded from the terms of warranty:
 - (a) Fair wear and tear, specially to blades and belts.
 - (b) Damage caused by neglect or lack of lubrication.
 - (c) Damage caused by misuse or abuse.
 - (d) Damage caused while the machine is in transit.
 - (e) Damage caused to the frame of the machine by running the machine with an unbalanced rotor.
5. The warranty is for the benefit of the first user only.

OPERATING INSTRUCTIONS

LUBRICATION

- Daily**
- Grease the spindle assemblies through the grease nipple on the oil seal housing, under the secondary vee pulleys. (This nipple greases both top and bottom bearing).
 - Grease both cross and bearings on the P.T.O. shaft.
 - Grease the tube of the P.T.O. shaft.
 - Check the oil level in the gearbox. (The bottom of the filler elbow is the level). Fill with E.P. 90 grade oil (or equivalent).
 - Fieldmaster 150T and 120T models, grease the nipple on top of the jockey pulley.
- Regularly**
- Grease the wheels.
 - Fieldmaster 150T, 120T and 90T models, oil height adjustment screw.

SETTING THE MOWER UP FOR WORK

Your Fieldmaster rotary mower will give first class results in a wide variety of conditions, but it is important to set the machine up correctly to achieve best results.

HEIGHT ADJUSTMENT

Fieldmaster 3/70 & 3/90

1. Cutting height of skid machines is altered simply by repositioning the side skid on the mower body.
2. Cutting height of wheeled machines is altered by repositioning each axle mounting bar, in its sleeve locating with the pin provided. Ensure that both wheels are set at the same position.
3. After setting the cutting height, adjust the tractor top link so that the mower is cutting level. This is most important because FIELDMASTER mowers have cutter heads staggered, ensuring a 100% cut across the width of the machine. If the top link is not set correctly a "striping" effect in the grass will quickly become apparent because the front and rear rotors are cutting at different heights.

Fieldmaster 150T, 120T & 90T

Fieldmaster trailed models have an infinitely variable cutting height achieved by turning the screw handle at the rear, altering the pitch of the axle relative to the mower body.

There is also provision for levelling the machine on the tow hitch.

BELT ADJUSTMENT

Fieldmaster belts are tightened by moving the gearbox assembly. First slacken the four bolts which hold the gearbox bracket to the deck, and turn the adjusting screw, moving the gearbox, until the belts are tensioned correctly.

The belts should be tight so they can be moved about $\frac{1}{2}$ " under finger pressure. If over tightened they become inflexible and tend to "drum" putting too much stress on driven parts.

When the belts are adjusted correctly, retighten the four gearbox holding bolts.

Wing belts on the 150T and 120T are tensioned with a jockey pulley. First slacken the holding bolts, and adjust the jockey pulley, retightening when the correct tension is achieved.

P.T.O. DRIVE SHAFT

Because Fieldmaster mowers are designed to work with a wide variety of tractors it is impossible to provide a drive shaft of the correct length to suit every tractor.

You should therefore ensure that the p.t.o. shaft is of the correct length to suit your tractor. This is particularly important with mounted models.

Fieldmaster p.t.o. shafts have a tube, which is easily cut with a hack saw.

USING YOUR FIELDMASTER MOWER

You will obtain best results from your Fieldmaster rotary mower when a p.t.o. speed of 540 r.p.m. is maintained consistently and you should select a forward speed accordingly.

For greater efficiency, work your Fieldmaster clockwise around a field, i.e. always turning right, avoiding sharp turning when changing direction.

In heavy wet grass, it may be necessary to make two passes, lowering the cutters after the first cut. If you try to clear 8" – 10" of dense grass at one pass, excessive belt slip, resulting in an unsatisfactory performance may occur.

When cutting regularly maintained grass areas where a height of 1" – 3" is required, take special care that your Fieldmaster is cutting level, and work at a fast walking speed. This prevents the machine from bouncing, which will inevitably cause "scalping" on a smooth surface.

AMENDMENTS TO PARTS LIST

ALWAYS QUOTE MODEL AND SERIAL NUMBER WHEN ORDERING PARTS.

FIELDMASTER 3/105

See illustration of cutter assemblies 3/70 on page 10, and frame assembly 3/90 on page 8 but substitute the following plate numbers:

41 — Part No. W0428	128 — Part No. W3651
52 — Part No. W0634	164 — Part No. W1179
75 — 74	Front strip guards, pair — W2477
77 — 76	Belt covers, pair — Part No. W3377
115 — Part No. W0952	No's 139 & 140 not applicable.

FIELDMASTER 3/90 FROM SERIAL NUMBER F8031674

Front strip guards added 2 off part no. W3477.

Lower link pin, plate no. 41 now part no. W0326.

FIELDMASTER 3/70 FROM SERIAL NUMBER P37T8031663.

Front strip guard added 1 off part no. W3477.

Tailgate no. 142 discontinued.

Rear strip guard (Skid machine only) 1 off part no. W3577.

PARTS LIST

PLEASE

ALWAYS QUOTE SERIAL NUMBER

AND PART NUMBER WHEN

ORDERING PARTS

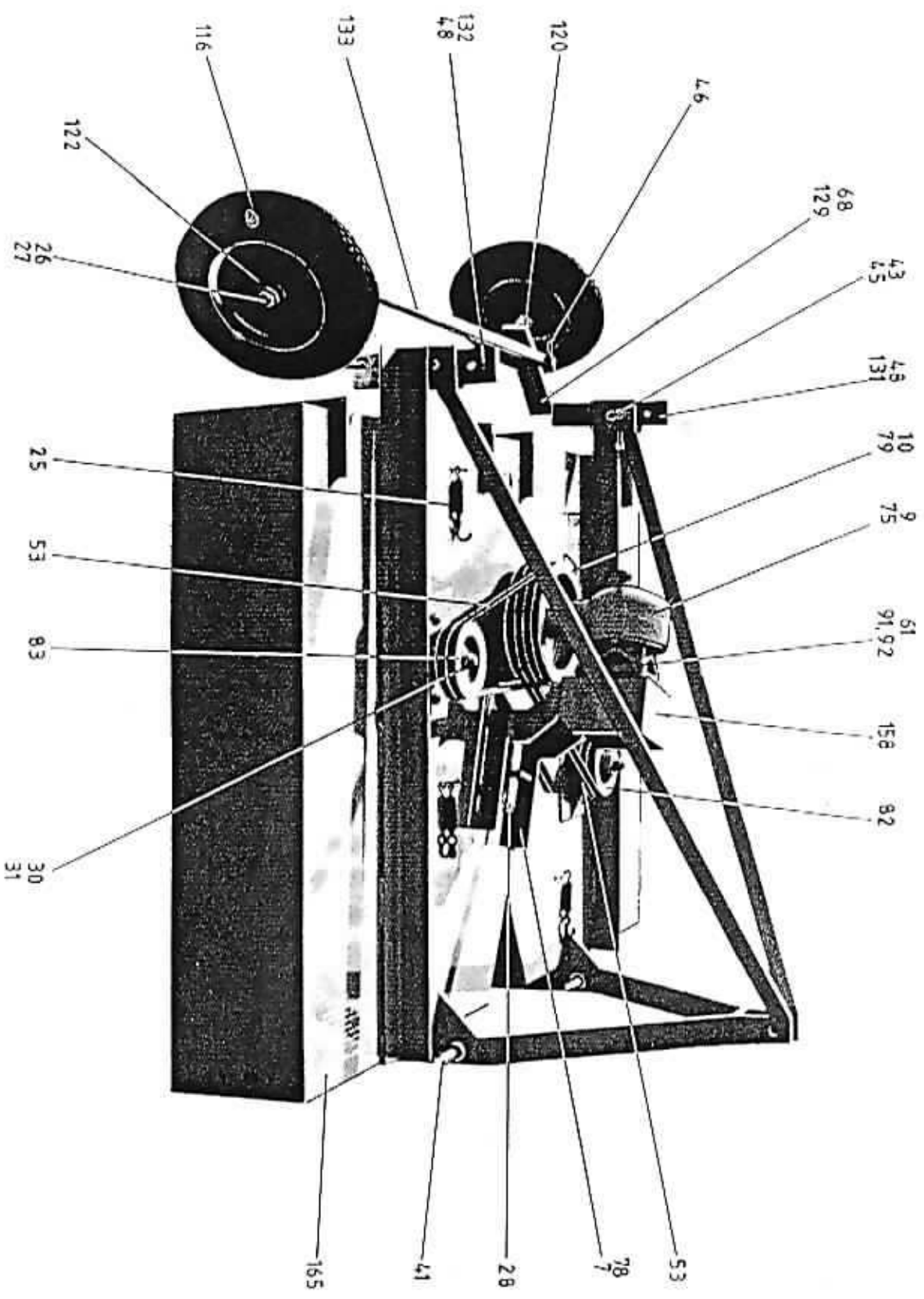

Skids & Covers not shown

FRAME ASSEMBLY 3/70

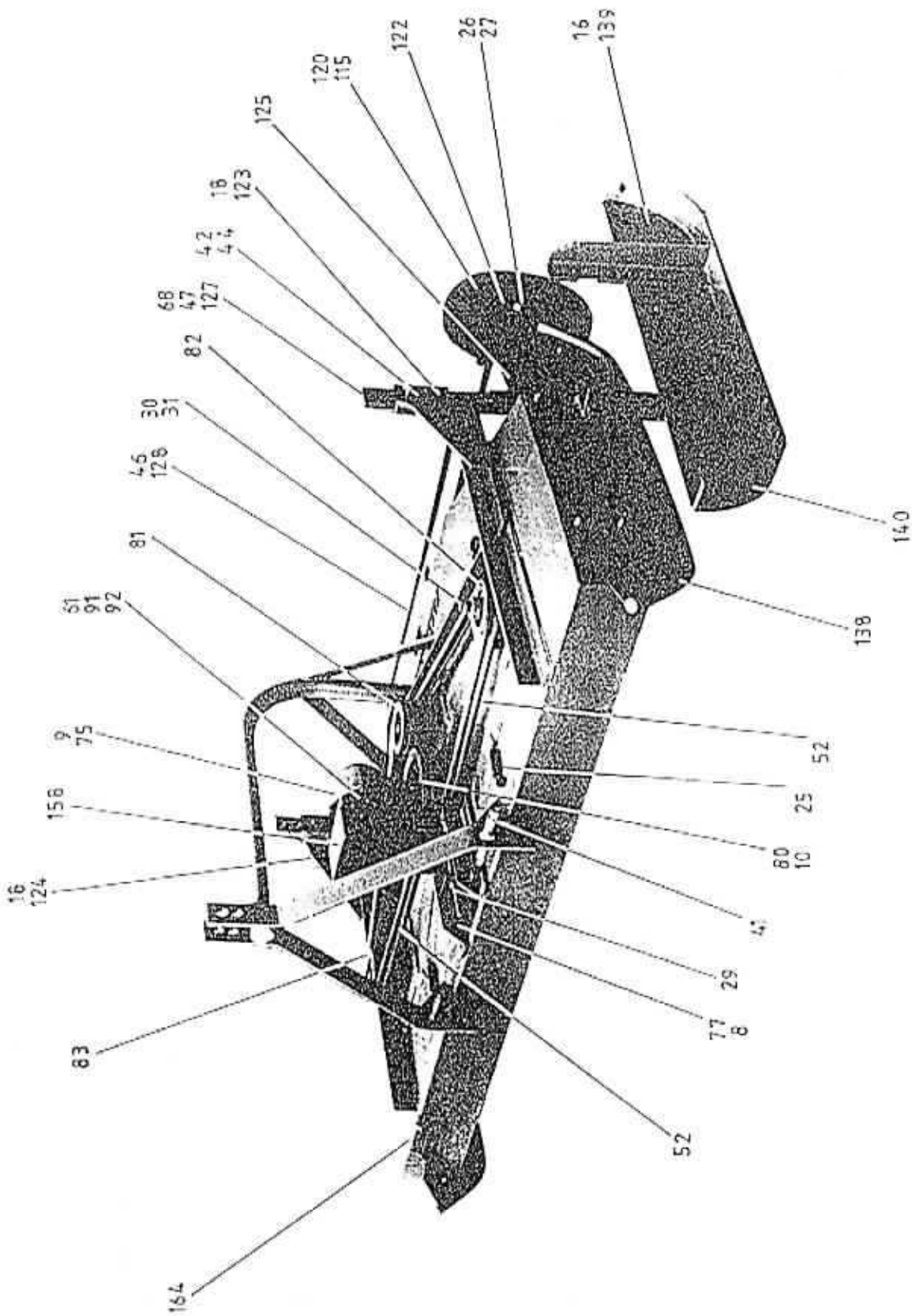

Covers not shown

FRAME ASSEMBLY 3190 - 3/105

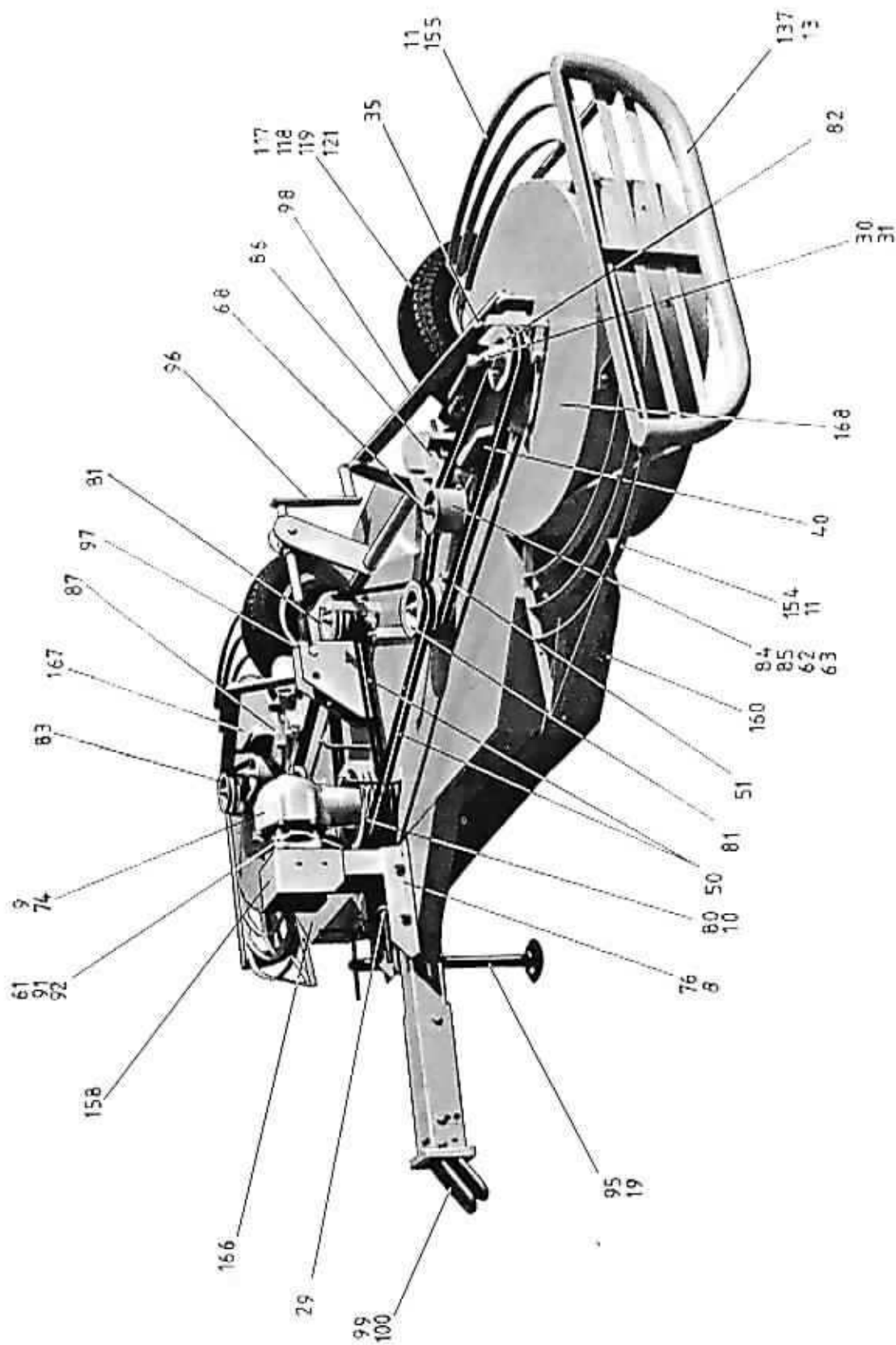

Covers & Main Stripguards not shown

FRAME ASSEMBLY 150T, ALSO 120T & 90T

No.	Description	No.	No.	Description	No.
1	Fastening set — Oil seal housing (item 90) Comprising: Hex head screw — 4 off Spring washer — 4 off	W0101	* 14	Fastening set — End strip guard (item 156) (alternative to wing skid) 150T, 120T Comprising: Hex head screw — 2 off & 1 off Self locking nut — 3 off	W1401
2	Fastening set — Spindle housing (item 89) for 150T, 120T, 90T, and 3/90 centre spindle Comprising: Hex head screw — 4 off Spring washer — 4 off Hex nut — 4 off	W0201	* 15	Fastening set — Cover plate (item 159) 120T, 90T Comprising: Hex head screw — 2 off Hex nut — 2 off	W1501
3	Fastening set — Spindle housing (item 89) for 3/90 outer spindles and 3/70 Comprising: Hex head screw — 4 off Spring washer — 4 off Hex nut — 4 off	W0301	16	Fastening set — Optional skid 3/90 (item 139) Comprising: Hex head screw — 4 off Hex nut — 4 off Spring washer — 4 off	W1601
4	Fastening set — Cutter head mounting (all machines) Comprising: Hex head screw — 4 off Self locking nut — 4 off	W0401	* 17	Fastening set — Optional skid 3/70 (item 141 & 142) Comprising: Hex head screw — 4 off Hex nut — 4 off Spring washer — 4 off	W1701
5	Fastening set — Cutter bar (all machines) Comprising: Hex head screw — 8 off Self locking nut — 8 off	W0501	18	Fastening set — Wheel assembly bracket — 3/90 (left or right hand) — wheeled machines only Comprising: Hex head screw — 2 off) Hex nut — 2 off) per side Spring washer — 2 off)	W1801
6	Fastening set — Flail cutter (all machines) Comprising: Hex head screw — 1 off Self locking nut — 1 off	W0601	19	Fastening set — Front jack (item 95) 150T, 120T, 90T Comprising: Hex head screw — 2 off Hex nut — 2 off Spring washer — 2 off	W1901
7	Fastening set — Gearbox bracket to frame — 3/70 Comprising: Hex head screw — 4 off Hex nut — 4 off Plain washer — 4 off Spring washer — 4 off	W0701	20	Fastening set — Gearbox cover (item 158) Wing unit belt covers (item 146 & 147) Comprising: Hex head screw — 4 off Self locking nut — 4 off	W2001
8	Fastening set — Gearbox bracket to frame — 150T, 120T, 90T, and 3/90 Comprising: Hex head screw — 4 off Hex nut — 4 off Plain washer — 12 off Spring washer — 4 off	W0801	21	Fastening set — Skid shoes — 3/90 Comprising: Countersunk head socket screw — 6 off Nut — 6 off Spring washer — 6 off	W2101
9	Fastening set — Gearbox to bracket (all machines) Comprising: Hex head screw — 4 off Hex nut — 4 off Spring washer — 4 off	W0901	25	Cover fastener — 3/90, 3/70	W0125
10	Fastening set — Drive pulley to gearbox (all machines) Comprising: Hex head screw — 4 off Spring washer — 4 off	W1001	26	Nut — 3/90 & 3/70 stub axle	W0412
11	Fastening set — For strip guards as follows:- Front — 150T, 120T, 90T (item 152) Wing front — 150T, 120T (item 154) Wing rear — 150T, 120T (item 155) 3/90 rear (item 157) Comprising: Hex head screw — 2 off & 1 off Self locking nut — 3 off	W1101	27	Washer — 3/90 & 3/70 stub axle	W0415
* 12	Fastening set — for rear strip guard 150T, 120T, 90T (item 153) Comprising: Hex head screw — 3 off Plain washer — 2 off Self locking nut — 3 off	W1201	28	Adjusting screw — belt tension — 3/70 Order also — nut (part no. 0210)	W0102
13	Fastening set — For optional wing skid 150T, 120T (item 137) Comprising: Hex head screw — 5 off & 2 off Self locking nut — 7 off	W1301	29	Adjusting nut — belt tension	W0210
			30	Self locking spindle top nut	W0113
			31	Plain washer — spindle top	W0515
			32	Spindle locking nut	W0166
			33	Spindle lock tab washer	W0120
			34	Spacer sleeve — spindle	W0266
			35	Wing nut — main cover 150T, 120T, 90T	W0502
			40	Hinge pin — wing unit — 150T & 120T Order also — Plain washer — 4 off — Cotter pin — 4 off	W0128 W0615 W0222

Item No.	Description	Part No.	Item No.	Description	Part No.
41	Lower hitch pin — 3/90 & 3/70	W0126	79	Pulley, 4 groove, primary drive — 3/70	W0162
42	Height adjustment pin — 3/90 wheeled machine	W0228	80	Pulley, 4 groove, primary drive — 150T, 120T, 90T, 3/90	W0262
43	Height adjustment pin — 3/70 wheeled machine	W0328	81	Pulley, 4 groove, secondary drive	W0362
44	Lynch pin — 3/90 wheeled machine	W0127	82	Pulley, 2 groove, secondary drive — left hand	W0462
45	'R' clip — 3/70 wheeled machine	W0121	83	Pulley, 2 groove, secondary drive — right hand	W0562
46	'R' clip — tie rod — 3/90 & 3/70 wheeled machines	W0221	84	Jockey pulley — 150T, 120T	W0662
47	Cotter pin — 3/90 wheeled machine	W0122	85	Spacer — jockey pulley	W0366
48	Cotter pin — 3/70 wheeled machine	W0222	86	Bracket — left hand jockey pulley Order also — grease nipple (part no. 0146)	W0466
50	Drive belt — 150T, 120T, 90T	W0134	87	Bracket — right hand jockey pulley Order also — grease nipple (part no. 0146)	W0566
51	Drive belt — wing unit — 150T, 120T	W0234	88	Cutter spindle	W0866
52	Drive belt — 3/90	W0334	89	Spindle housing	W0666
53	Drive belt — 3/70 0634(105/3)	W0434	90	Oil seal housing — spindle Order also — oil seal (part no. 0145) & grease nipple (part no. 0146)	W0766
*55	Wheel bearing, inner — 150T, 120T, 90T	W0140	91	Bearing housing — extension shaft	W0657
*56	Wheel bearing, outer — 150T, 120T, 90T	W0240	92	Extension shaft — 6 spline	W0757
*57	Wheel bearing, inner — 3/90, 3/70	W0138	*93	Gearbox filler elbow	W0857
58	Wheel bearing, outer — 3/90, 3/70	W0238	95	Front jack assembly — 150T, 120T, 90T	W0156
59	Spindle bearing — upper	W0338	96	Handle assembly — height adjustment, 150T, 120T, 90T	W0256
60	Spindle bearing — lower (sealed one side)	W0438	97	Screwed cross — height adjustment, 150T, 120T, 90T	W0356
61	Bearing — extension shaft	W0538	98	Wing stay bar — 150T, 120T	W0180
62	Bearing — upper, 150T, 120T Jockey pulley — 1 off	W0638	NS	Wing stay bar fixing screws — 2 off	W0307
63	— lower, (sealed one side) — 1 off	W0738	NS	Wing stay bar wing nuts — 2 off	W0402
65	Oil seal — spindle	W0145	99	Tow hitch — 150T, 120T, 90T	W0280
*66	Oil seal — wheel, 3/90, 3/70	W0245	NS	Tow hitch bolts — 2 off	W0403
*67	Oil seal — wheel, 150T, 120T, 90T	W0345	NS	Tow hitch nuts — 2 off	W0309
68	Grease nipple — spindle, and jockey pulley, 3/90, 3/70 wheel assemblies	W0146	NS	Tow hitch spring washers — 2 off	W0616
*69	Grease nipple — wheel, 3/90, 3/70	W0246	100	Tow jaw	W0380
70	Drive key — spindle	W0147	NS	Tow jaw belt — 1 off	W0403
74	Gearbox complete — 150T, 120T, 90T (see sheet 16 for breakdown of parts)	W0157	NS	Tow jaw nut — 1 off	W0309
75	Gearbox complete — 3/90, 3/70 (see sheet 15 for breakdown of parts)	W0257	NS	Tow jaw spring washer — 1 off	W0616
76	Mounting bracket — gearbox 150T, 120T, 90T	W0357	101	Flail cutter assembly — 150T, 120T, 90T, 3/90	W0169
77	Mounting bracket — gearbox 3/90	W0457		Comprising:	
78	Mounting bracket — gearbox 3/70 Order also — adjusting screw and nut (part no. 0102)	W0557		Mounting plate (part no. 0270) — 1 off	
				Cutter (part no. 0470) — 2 off	
				Fastening set (part no. 0601) — 2 off	

Item No.	Description	Part No.	Item No.	Description	Part No.
102	Flail cutter assembly — 3/70 Comprising: Mounting plate (part no. 0370) — 1 off Cutter (part no. 0570) — 2 off Fastening set (part no. 0601) — 2 off	W0269	127	Wheel adjusting bar — 3/90 wheeled machine Order also — Plain washer & cotter pin (part nos. 0815, 0122)	W1151
103	Cutter bar assembly — 150T, 120T, 90T 3/90 Comprising: Mounting plate (part no. 0370) — 1 off Cutter bar 30" (part no. 0670) — 1 off Fastening set (part no. 0501) — 1 off	W0369	128	Tie rod — 3/90 wheeled machine	W1251
104	Cutter bar assembly — 3/70 Comprising: Mounting plate (part no. 0370) — 1 off Cutter bar 36" (part no. 0770) — 1 off Fastening set (part no. 0501) — 1 off	W0469	129	Axle bracket, left hand — 3/70 wheeled machine	W1351
105	Mounting plate, flail — 150T, 120T, 90T, 3/90	W0170	*130	Axle bracket, right hand — 3/70 wheeled machine	W1451
106	Mounting plate, flail — 3/70	W0270	131	Wheel adjusting bar, left hand — 3/70 wheeled machine Order also — plain washer & cotter pin (part nos. 0715, 0222)	W1551
107	Mounting plate, cutter bar	W0370	132	Wheel adjusting bar, right hand — 3/70 wheeled machine Order also — Plain washer & cotter pin (part nos. 0715, 0222)	W1651
108	Flail cutter, cranked — 150T, 120T, 90T, 3/90	W0470	133	Tie rod — 3/70 wheeled machine	W1751
109	Flail cutter, straight — 3/70	W0570	*134	Axle Fabrication 150T, 120T, 90T	W1851
110	Cutter bar, 30" — 150T, 120T, 90T, 3/90	W0670	*135	Wheel conversion unit complete, for converting 3/90 skid machine to wheeled machine	W0150
111	Cutter bar, 36" — 3/70	W0770	*136	Wheel conversion unit complete, for converting 3/70 skid machine to wheeled machine	W0250
*114	Axle casting 150T, 120T, 90T	W1951	137	Wing skid — 150T, 120T (optional extra) complete with stays. Order also — Fastening set (part no. 1301)	W0174
115	Wheel complete, including tyre — 3/90	W0152	138	Anti-scalp skid set — 3/90 wheeled machine Comprising: Skid — 1 off Stay bar — 1 off Bracket — 1 off Order also: Hex head screw (part no. 0406) — 3 off Self locking nut (part no. 0212) — 3 off Fastening set (part no. 1701)	W0274
116	Wheel complete, including tyre — 3/70	W0252	139	Skid — 3/90 non wheeled machine Order also — Skid shoe set (part no. 0175) — 1 off Fastening set (part no. 1601) — 1 off Fastening set (part no. 2101) — 1 off	W0374
117	Wheel and tyre — 150T, 120T, 90T	W0352	140	Skid shoe set — 3/90 skid (part no. 0374) Comprising: Skid shoe — 2 off Order also — Fastening set (part no. 2101)	W0175
118	Hub assembly — 150T, 120T, 90T wheel complete	W0151	*141	Skid, 3/70 pair, non wheeled machine Order also — Fastening set (part no. 1701) — 2 off	W0474 N.L.A.
119	Stub axle — 150T, 120T, 90T wheel (welded in)	W0251	142	Tail gate 3/70 Order also — Hex head screw (part no. 0506) — 2 off Self locking nut (part no. 0212) — 2 off	W2077
120	Stub axle — 3/90, 3/70 wheel (welded in)	W0351	*145	Belt cover, main unit — 150T, 120T, 90T Order also — Wing nuts & plain washers (part nos. 0802 & 0215)	W0177
121	Hub cap — 150T, 120T, 90T wheel	W0451			
122	Hub cap — 3/90, 3/70 wheel	W0651			
123	Wheel assembly bracket, left hand — 3/90 wheeled machine. Order also — Fastening set (part no. 1801)	W0751			
124	Wheel assembly bracket, right hand — 3/90 wheeled machine Order also — Fastening set (part no. 1801)	W0851			
125	Axle bracket, left hand — 3/90 wheeled machine	W0951			
*126	Axle bracket, right hand — 3/90 wheeled machine	W1051			

Item No.	Description	Part No.	Item No.	Description	Part No.
*146	Belt cover, left hand wing unit — 150T, 120T Order also — Wing nuts & plain washers (part nos. 0802 & 0215) and fastening set (part no. 2001)	W0277	168	Main wing fabrication, left hand <i>*Not referenced on illustrations.</i>	W0679
*147	Belt cover, right hand wing unit — 150T, 120T Order also — Wing nuts & plain washers (part nos. 0802 & 0215) and fastening set (part no. 2001)	W0377			
*148	Belt cover, 3/90, pair	W0477			
*151	Belt cover, 3/70, pair	W0777			
*152	Strip guard, front — 150T, 120T, 90T Order also — Fastening set (part no. 1101)	W0877			
*153	Strip guard, rear — 150T, 120T, 90T Order also — Fastening set (part no. 1201)	W0977			
154	Strip guard, wing unit, front — 150T, 120T Order also — Fastening set (part no. 1101)	W1077			
155	Strip guard, wing unit, rear — 150T, 120T Order also — Fastening set (part no. 1101)	W1177			
*156	Strip guard, end — 90T or 150T, 120T if wing skid not fitted Order also — Fastening set (part no. 1401)	W1277			
*157	Strip guard, rear — 3/90 non wheeled machine Order also — Fastening set (part no. 1101)	W1377			
158	Cover, gearbox — all machines Order also — Fastening set (part no. 2001)	W1477			
*159	Cover plate — 120T, 90T (in place of wing unit) Order also — Fastening set (part no. 1501)	W1577			
160	Stone guard set — 150T (optional extra) Comprising: Rubber strip Hex head screws Hex nuts Special washers	W1677			
*161	Stone guard set — 120T (optional extra) Comprising: Rubber strip Hex head screws Hex nuts Special washers	W1777			
*162	Stone guard set — 90T (optional extra) Comprising: Rubber strip Hex head screws Hex nuts Special washers	W1877			
*163	Stone guard set — 3/90 (optional extra) Comprising: Rubber strip Hex head screws Hex nuts Special washers	W1977			
164	3/90 main fabrication	W0179			
165	3/70 main fabrication	W0279			
166	150T main fabrication	W0379			
167	Main wing fabrication, right hand	W0479			

GEARBOX T - 4A

Fitted to Fieldmaster 3/70, 3/90 and P.18

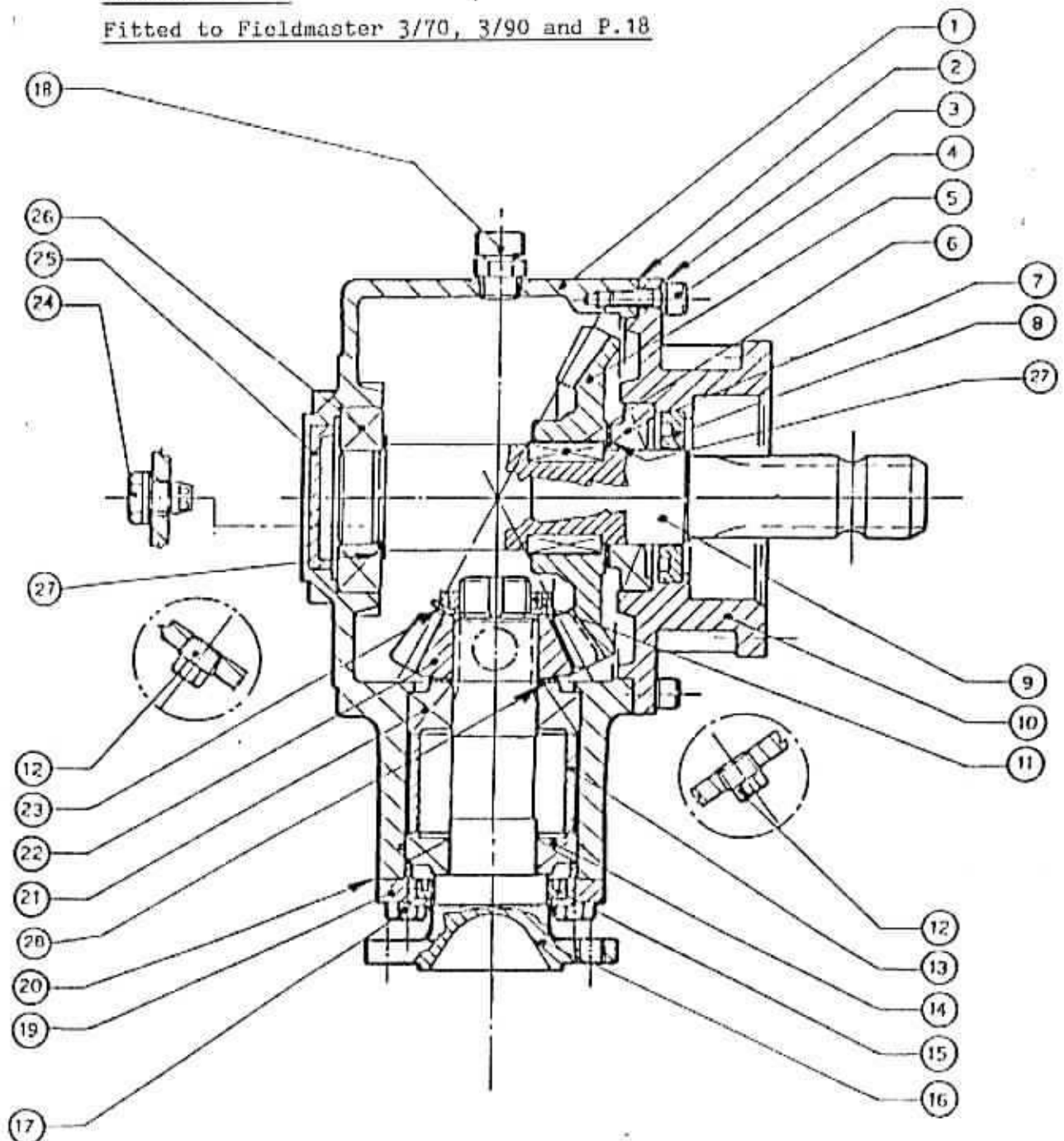

Position	Drawing No.	Description	Position	Drawing No.	Description
1	0.244.0508.00	Casing	15	8.7.3.00101	Oil Seal
2	0.247.7201.00	Gasket	16	0.244.2201.00	Shaft
3	8.3.7.00140	Spring Washer	17	8.1.1.00041	Bolt
4	8.1.2.00785	Bolt	18	8.6.7.00161	Oil Filler Plug
5	0.244.6203.00	Gear	19	0.244.1510.00	Cover
6	8.4.1.00057	Parallel Key	20	0.244.7202.00	Gasket
7	8.0.9.00024	Bearing	21	8.0.9.00127	Bearing
8	8.7.3.00407	Oil Seal	22	0.244.5205.00	Pinion
9	0.244.3213.00	Shaft	23	8.3.8.00549	Spring Washer
10	0.244.1507.00	Cover	24	8.6.4.00673	Lev. Warning Light
11	8.2.5.00548	Locknut	25	8.7.0.00743	Cap
12	8.6.5.00006	Plug	26	8.0.1.00871	Bearing
13	0.244.7120.00	Spacer	27	0.244.7500.00	Shim
14	8.0.9.00600	Bearing	28	0.259.7500.00	Shim

USE AND MAINTENANCE OF P.T.O. DRIVE SHAFT

LUBRICATION
Carefully respect the frequency as shown on the Application Chart.

LINK UP
Check the correct timing of drive shaft to P.T.O.

LENGTH ADJUSTMENT
Make sure that length of drive shaft is compatible with different working positions of implement.

SAFETY PRECAUTIONS
Use fully guarded drive shafts only and make sure that P.T.O.'s are covered for protection.

SAFETY CHAIN
Fasten chain loosely to allow greatest joint articulation.

WORKING ANGLES
Avoid joint articulation over 35°.

TURNING
Disengage P.T.O. during sharp turns.

MAINTENANCE
After any period of standard inspection and grease drive shaft before pulling into operation.

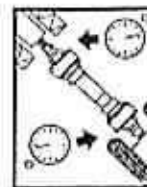
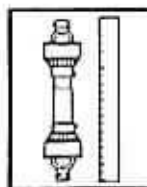

LUBRICATING INSTRUCTIONS FOR DRIVE LINE

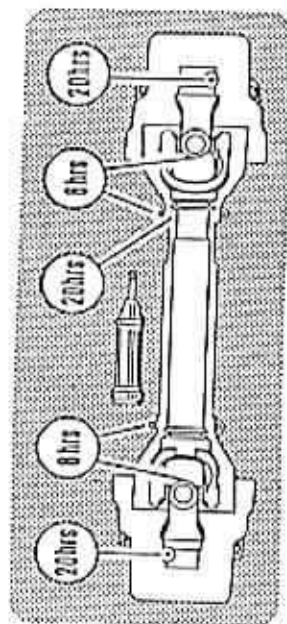

LUBRICATING INSTRUCTIONS FOR CONSTANT VELOCITY JOINT

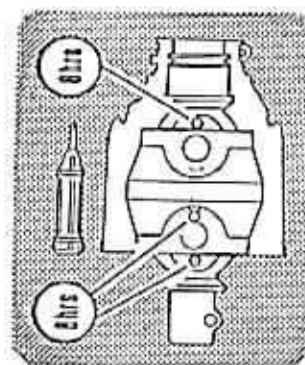

CAUTION

PLEASE READ CAREFULLY THE
ENCLOSED INSTRUCTIONS ON HOW
TO USE AND MAINTAIN A DRIVE LINE
BEFORE HOOKING ON TO TRACTOR
P.T.O.

Rotating drive shaft - fitted with restraining chains.

Check that P.T.O. implement input shaft, and drive shaft are all properly guarded.

Check drive shaft is securely fastened to both P.T.O. and implement.

Check restraining chains are secured to prevent guard rotation.

Stay clear of drive shaft when it is working.

Lubricate according to instructions.



BYPY TRANSMISSIONS LTD
Burway Trading Estate, Ludlow, Shropshire SY6 1SW, England
Tel: (01684) 3012/3/4, Telex: 33472 CODES, BYPY UUGOW.