

---

# WESSEX

---



FM 380

# Pasture Topper

## OPERATING MANUAL & Parts List

**WESSEX FARM MACHINERY SALES CO.**

Trading Estate, Oakhanger Road, Bordon,  
Hampshire, GU35 9HH.  
Telephone: 0420 478111

24hrs parts hotline 0420 474319

---

**PLEASE READ THE FOLLOWING  
PAGES CAREFULLY BEFORE  
USING YOUR MACHINE  
AND RETAIN THIS MANUAL**

**IMPORTANT SAFETY WARNING**

Wessex Toppers are guarded for your protection but you must always observe certain elementary precautions. Rotary mowers are potentially dangerous machines, and should be used with the greatest respect. Ensure that ALL operators are aware of the following:-

1. NEVER attempt any adjustment whatever unless the machine is COMPLETELY at a standstill.
2. NEVER attempt to clear any obstructions around the mower unless the machine is COMPLETELY at a standstill.
3. NEVER remove belt guards unless the machine is COMPLETELY at a standstill.
4. NEVER remove safety guards which are provided for your protection.
5. NEVER operate the mower with people behind; keep everybody (especially children) at a safe distance.
6. Stand well back from the machine, when cutters are spinning.
7. Regularly, inspect the BLADES AND FIXING BOLTS to ensure that they are in tip-top condition. Replace blades IMMEDIATELY any fracture or excessive wear becomes apparent. Serious damage which is excluded from our warranty conditions may result from using your mower with an unbalanced rotor. When replacing blades always fit new mounting bolts and nuts.
8. When working in public areas always fit the optional public authority guarding kit.

**HEALTH & SAFETY – Noise at Work Regulations**

In compliance with the above regulations, this machine has been tested in operation with a Tractor without a quiet cab and working at 540 R.P.M. with the following result:-

**READING AT THE OPERATORS EAR FM 380 Pasture Topper 94.5 D.B.A.**

## WARRANTY

Your Wessex Topper is warranted free from defect in workmanship or manufacture for 1 year from date of purchase, with the exception of gearbox seals (ninety days). Any parts which appear to us to be defective either in material or workmanship shall be replaced or repaired at no cost to the purchaser, subject to the following conditions:-

1. The registration card enclosed with this booklet must be returned to us within seven days of purchase.
2. Any failure in the machine should be reported in the first instance to your dealer who will act on your behalf to resolve the matter to your satisfaction.
3. The defective parts will be returned by your dealer to us accompanied by a full statement describing the failure, and the circumstances and conditions in which the failure occurred, within five working days of failure.
4. The following are specifically excluded from the terms of warranty:
  - (a) Fair wear and tear, specially to blades and belt.
  - (b) Damage caused by neglect or lack of lubrication.
  - (c) Damage caused by misuse or abuse.
  - (d) Damage caused while the machine is in transit.
  - (e) Damage caused to the frame of the machine by running the machine with an unbalanced rotor.
5. The warranty is for the benefit of the first user only.

# OPERATING INSTRUCTIONS

## SETTING UP YOUR WESSEX FM 380 TOPPER

1. Reverse your Tractor up to the Machine, and either connect to the Tractor with the drawbar pin, or connect with Tractor quick hitch.
2. Connect the PTO Shaft, ensuring that the Shaft is not too long for the Tractor. If need be, shorten the Shaft in accordance with the instructions in the back of this book.
3. Fold the PTO Stand down and fully raise the parking jack, turning tightly to lock it in the up position before moving.
4. For road transport the height adjustment handle should be screwed out to lift the machine well clear of the ground.
5. Set the cutting height of your machine, by lowering it with the height adjustment handle. Now ensure that the machine is level by adjusting the towing bracket or turning the towing eye.
6. Now remove the wing securing pin and carefully lower the wing units, taking care that the drive belts are correctly positioned in the grooves.
7. The adjustable links, located on the extremity of each wing should now be fitted and secured with the pins and linch pins provided, and adjusted to take up any play.
8. Belt covers can now be released from the transport position and secured in place with nuts provided.

## USING YOUR WESSEX TOPPER

You will obtain the best results from your Wessex Topper when a PTO Speed of 540 rpm is maintained consistently, and you should select a forward speed accordingly.

For greater efficiency, work your Wessex Topper clockwise around a field, to improve the spread of cut material.

In heavy wet grass, it may be necessary to make two passes, lowering the cutters after the first cut.

Care should be taken not to drive too fast as bouncing on the tyres may occur which will inevitably cause an uneven cut or scalping.

## **HEIGHT ADJUSTMENT**

The height of cut can be adjusted by turning the adjustment handle at the rear of the machine, but it is important to re-level the machine by adjusting the towing bracket or eye, or the machine will leave strips of grass cut at different heights.

## **BELT ADJUSTMENT**

Wessex Topper belt adjustment has always been simple yet positive feature. The four bolts which hold the gearbox mounting bracket to the deck should be loosened and the nut in the middle tightened. This will move the whole gearbox assembly away from the central rotor pulley, thus tightening all four belts simultaneously. It is advisable to turn the belts as they are tightened to spread the tension. Correct belt tension is when the belt can be deflected 15mm under thumb pressure. Finally the four bolts should be re-tightened.

The wing belt adjustment is simply by loosening the nut clamping the jockey bracket to the deck. The nut on the adjustment thread is then tightened. Belts should be turned to spread the tension and when the correct tension of 15mm under thumb pressure is obtained the clamping nut should be re-tightened.

## **REPLACING BLADES**

When replacing blades always ensure that the two blades on one rotor are equally worn, or both new, to avoid imbalance and the resulting vibration.

Always ensure that the flat washer is replaced under the blade fixing nut.

## **LUBRICATION**

- Daily
  - Grease the spindle assemblies through the nipple under each rotor pulley. (This lubricates both top and bottom bearings.)
  - Grease the jockey pulley bearings through the nipple in the centre.
  - Grease both cross journals on the PTO Shaft.
  - Grease the tubes of the PTO Shaft.
- Regularly
  - Check the oil level in the gearbox. (The centre line of the input shaft being the level.) Top up with EP 90 Grade Gear Oil.
  - Grease the wheels.
  - Grease the height adjustment handle.
  - Oil the wing hinge pins.

# WESSEX FM 380 SPINDLE ASSEMBLY AND PARTS LIST

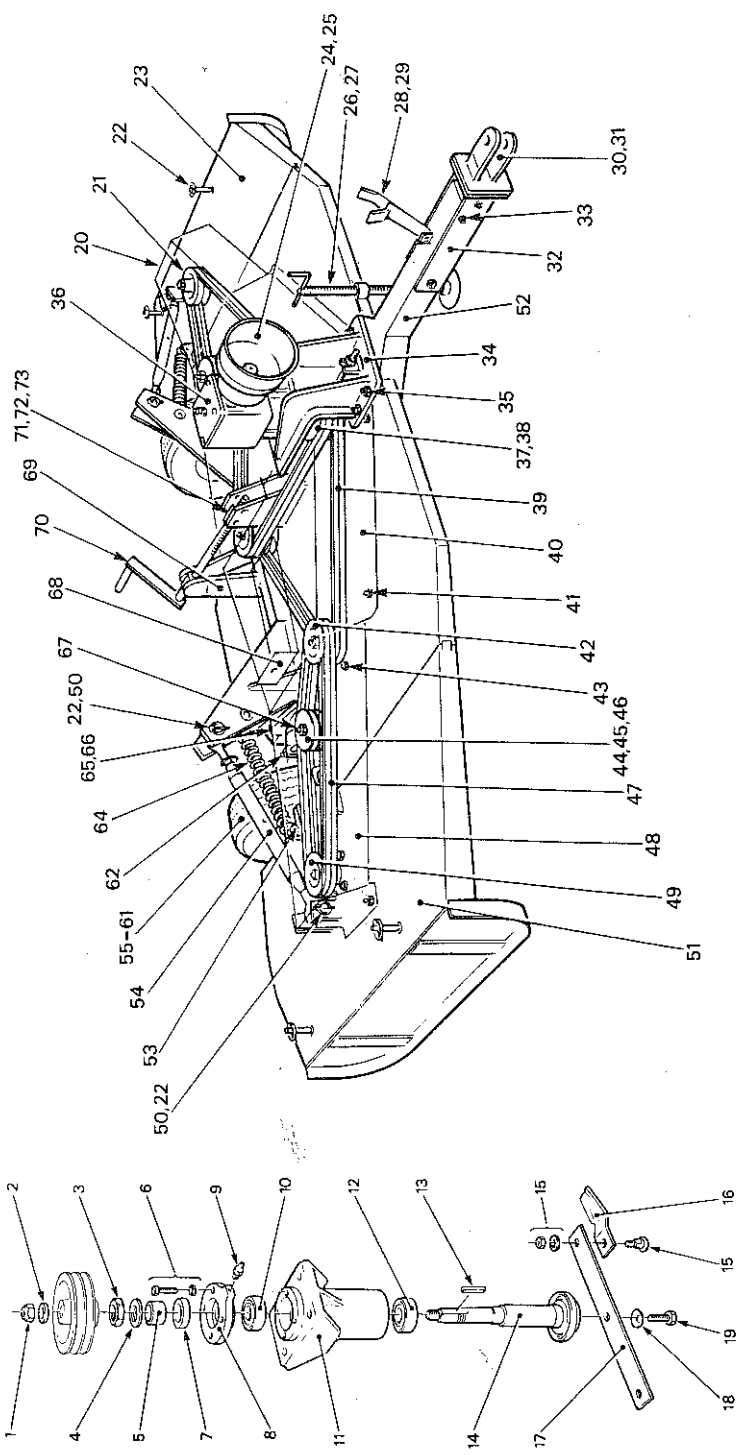

1.	W0113	Top Nut	29.	W2702	Fastening Set - PTO	51.	W3779	Wing Fabrication RH
2.	W0515	Top Washer	30.	W0380	Tow Jaw	52.	W3579	Mainframe
3.	W0166	Locking Nut	31.	W2802	Fastening Set - Tow	53.	W0128	Wing Hinge Bolt & Nuts
4.	W0120	Tab Washer			Jaw			
5.	W0266	Spacer	32.	W0280	Towing Bracket	54.	W0929	Adjustable Link
6.	W0101	Fastening Set	33.	W2902	Fastening Set -	55.	W0352	Wheel Complete
7.	W0145	Oil Seal			Towing Bracket	56.	W0151	Hub Assembly
8.	W0766	Oil Seal Housing	34.	W6057	Gearbox Mounting	57.	W0251	Stub Axle
9.	W0146	Grease Nipple			Bracket	58.	W0140	Wheel Bearing Inner
10.	W0338	Top Bearing	35.	W0801	Fastening Set -	59.	W0240	Wheel Bearing Outer
11.	W0666	Spindle Housing			Gearbox Mounting	60.	W0345	Wheel Oil Seal
12.	W2938	Bottom Bearing	36.	W5857	Gearbox Complete	61.	W0451	Hub Cap
13.	W0147	Key	37.	W4762	Drive Pulley	62.	W4866	Jockey Bracket RH
14.	W6666	Spindle	38.	W0647	Key - Drive Pulley	63.	W4766 NS	Jockey Bracket LH
15.	W1439	Fastening Set	39.	W0134	Main Drive Belt	64.	W1725	Wing Assister Spring
16.	W5570	Blade	40.	W8377	Main Belt Cover	65.	W1951	Axle Bracket
17.	W5670	Mounting Bar			Fastening Set - Belt	66.	W0201	Fastening Set - Axle Bracket
18.	W2325	Disc Spring	41.	W3002	Fastening Set - Belt			
19.	W1539	Special LH Thread			Cover	67.	W0146	Grease Nipple
		Bolt	42.	W0362	4 Row Secondary	68.	W8677	Wing Guard Support
20.	W8477	Belt Cover LH			Pulley	69.	W1851	Axle Fabrication
21.	W0462	2 Row Pulley LH	43.	W0201	Fastening Set -	70.	W0256	Height Adjustment
22.	W0127	Linch Pin			Spindle Housing			Handle Assy
23.	W3679	Wing Fabrication LH	44.	W3262	Jockey Pulley	71.	W0356	Height Adjustment
24.	W1878	Cone Guard	45.	W0938	Jockey Bearing			Nut
25.	W3101	Fastening Set - Cone	46.	W4966	Jockey Bearing	72.	W2328	Height Adjustment
		Guard			Spacer			Washer
26.	W0156	Parking Jack	47.	W0234	Wing Drive Belt	73.	W6956	Height Adjustment
27.	W1901	Fastening Set -	48.	W8577	Belt Cover RH			Height Adjustment
		Parking Jack	49.	W0562	2 Row Pulley RH			Nut Retainer
28.	W5680	PTO Stand	50.	W0426	Pin			PTO Shaft Complete

# GEARBOX COMPLETE – PART NO. W5857

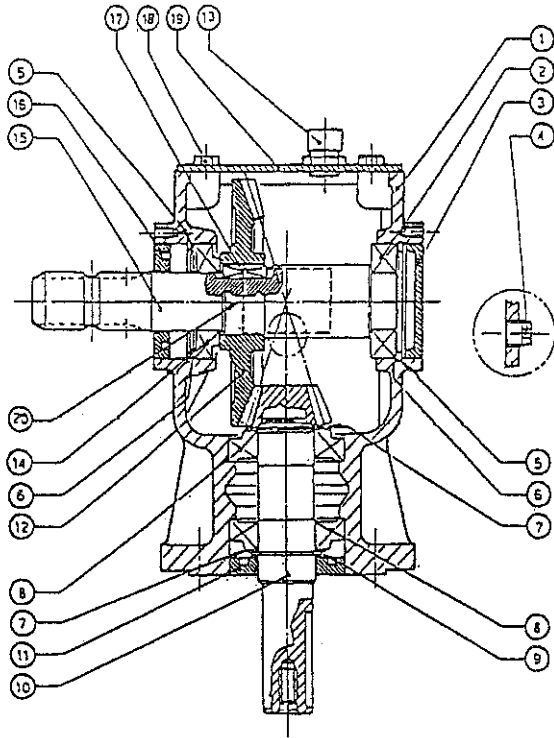

Pos.	Part No.	Piece	Description
1	0.151.0300.00	1	Casing
2	8.0.1.00870	1	Bearing
3	8.7.0.00744	1	Cap
4	8.6.5.00006	1	Plug
5	8.5.2.00131	2	Snap Ring
6	0.248.7500.00	2	Shim
7	0.244.7500.00	2	Shim
8	8.0.9.00024	2	Bearing
9	8.5.1.00680	1	Snap Ring
10	0.151.6001.00	2	Pinion Shaft
11	8.7.3.00027	1	Oil Seal
12	0.253.6201.00	2	Gear Z36
13	8.6.7.00269	1	Oil Filler Plug
14	8.0.9.00026	1	Bearing
15	0.151.2002.00	1	Shaft
16	8.7.3.00055	1	Oil Seal
17	8.4.1.00993	1	Parallel Key
18	8.1.1.00343	4	Bolt
19	0.140.1300.00	1	Cover
20	0.124.7101.00	1	Plate



# P.T.O. SHAFT COMPLETE – PART NO. W1281

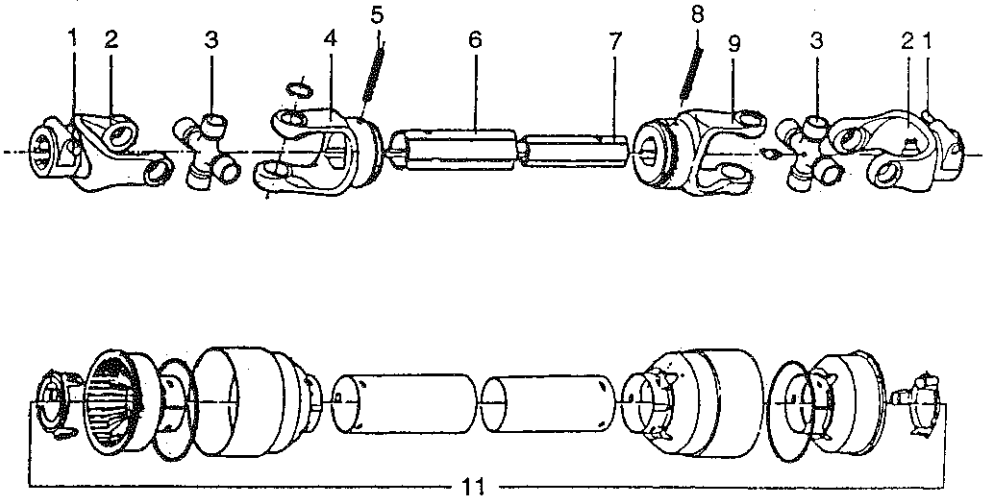

REF.	PART NO.	DESCRIPTION	QTY
1	166.026.004	Push Pin Set	2
2	141.025.001	Push Pin Yoke	2
3	180.015.130	Cross Journal Set	2
4	151.015.011	Outer Yoke	1
5	190.000.015	Roll Pin for Outer Tube	1
6	152.150.209	Outer Tube	1
7	153.150.109	Inner Tube	1
8	190.000.014	Roll Pin for Inner Tube	1
9	151.015.012	Inner Yoke	1
10	180.016.025F	Safety Chain	2
11	142.250.212F	Complete Shield Type F	1

# P.T.O SHAFT – OPERATION AND MAINTENANCE

**PTO drive shafts must only be used for their intended purpose.**

PTO drive shafts are designed for specific machine types and power requirements.

They must not be replaced by other models.

Ensure that the PTO drive shaft is securely connected.

**Only use a completely protected drive system:**

PTO drive shaft with complete guard and complementary guard on tractor and implement. A complete guard is essential in all working positions.

## LUBRICATION

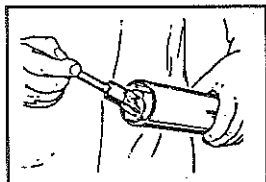

Lubricate with quality grease before starting work and every 8 operating hours.

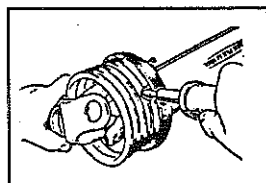

Clean and grease the PTO drive shaft before each prolonged period of non-use.

\* Grease the guard tubes in winter to prevent freezing.

## COUPLING THE PTO SHAFT

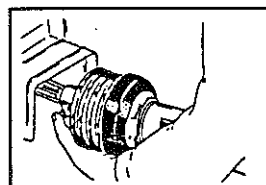

Clean and grease the PTO and PIC.

**Q.-d. pin**

Press q.-d. pin and simultaneously push PTO drive shaft onto PTO shaft until pin engages.

## LENGTH ADJUSTMENT

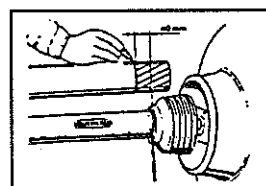

To adjust the length, hold the half-shafts next to each other in the shortest working position and mark them.

## LENGTH ADJUSTMENT

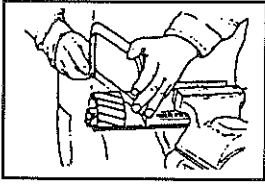

Shorten inner and outer guard tubes equally.

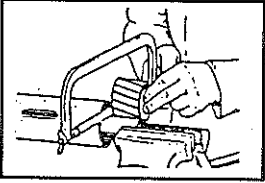

Shorten inner and outer sliding profiles by the same length as the guard tubes.

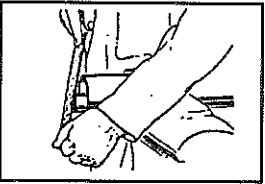

Round off all sharp edges and remove burrs.  
Grease sliding profiles.

No other changes may be made to the PTO drive shaft and guard.

## CHAINS

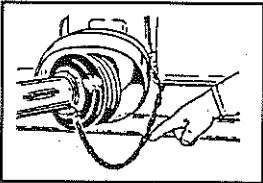

Chains must be fitted so as to allow sufficient articulation of the shaft in all working positions.

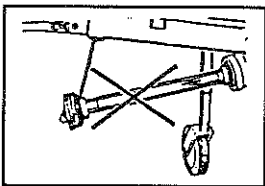

The PTO drive shaft must not be suspended from the chains!