

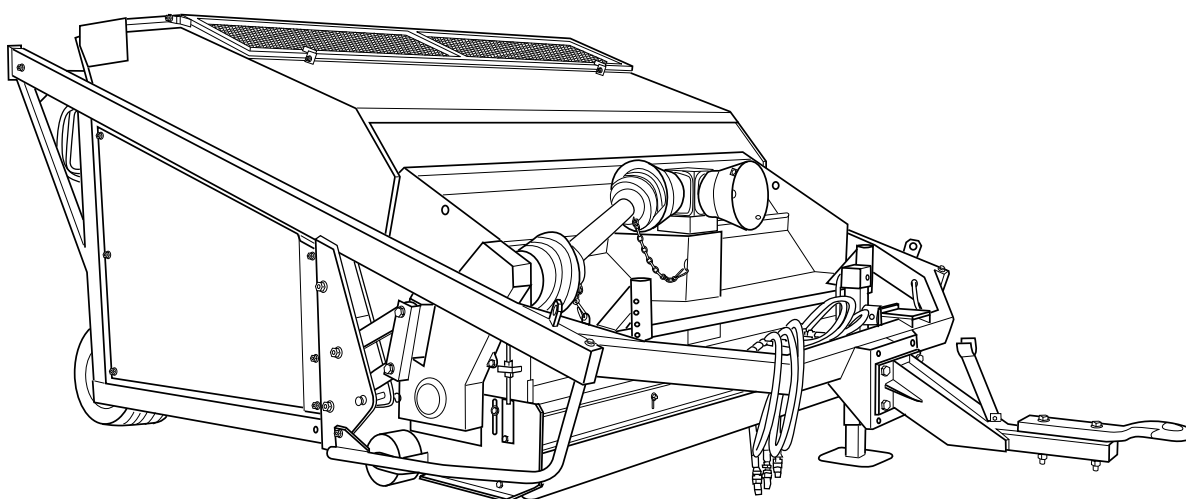

A Broadwood International Product

Operation Manual and Parts Book

Wessex ProLine HTC 18 MULTI-FUNCTION COLLECTOR



Product Code: L2040



Manufacturers and Distributors of Quality Equipment



Issue April 2012

CONTENTS

Welcome to your new Wessex Product	2
Safety Decals	3, 4
Important Safety Warnings	5
Warranty	6
Setting up your Wessex Multi-Function Collector	7
Adjusting the Rotor Height	7
Adjusting the Front Brush Strip / Emptying the Hopper	8
Chain Adjustment / Compensating for Brush Wear / Routine Maintenance	9
Change Over Procedure from Sweeping to Scarifying / Mowing	10
Fitting Blades for Scarifying	10
Fitting Blades for Mowing / Setting up for Flail Mowing and Scarifying	11
Troubleshooting / Specification	12
Function Change Kits	13
Parts Illustration - Mainframe Assembly - Plate 1	14, 16
Parts List - Mainframe Assembly - Plate 1	15, 17
Parts Illustration / Rear Assembly - Plate 2	18
Parts List / Rear Assembly - Plate 2	19
Parts Illustration / Hopper - Plate 3	20
Parts List / Hopper - Plate 3	21
Parts Illustration / Rotor Assembly - Plate 4	22
Parts List / Rotor Assembly - Plate 4	23
Parts Illustration / Parts List - Roller & Skid Assembly - Plate 5	24
Parts Illustration / Parts List - Gearbox - Plate 6	25
Parts Illustration - PTO Shaft - Plate 7	26
Parts List - PTO Shaft - Plate 7	27
PTO Shaft - Operation and Maintenance	28, 29
Safety Training Induction	30
Daily Inspection Record	31
CE Certificate	32

WELCOME TO YOUR NEW WESSEX HTC 18 MULTI-FUNCTION COLLECTOR

Thank you for purchasing a Wessex Proline HTC 18 Multi-Function Collector. As a Broadwood customer, you now number among the most important people of our business and we will endeavour to give you the best service available through our dealer network.

Please read this Manual carefully and familiarise yourself and other persons that will be using the machine with its contents, to ensure the optimum performance and working life of your machine. It is advisable that a copy of this Manual is kept in the workshop and one copy with the machine. Further copies are available through your dealer.

On delivery, your dealer should go through the workings of the machine with you, explaining the setting up procedures, all of which are contained in this manual for further reference. The Warranty Registration Form must also be completed and returned to us **within 7 days of delivery** in order to validate the Warranty.

**PLEASE READ THE FOLLOWING PAGES CAREFULLY BEFORE USING YOUR MACHINE
AND KEEP THIS MANUAL IN A SAFE PLACE.**



**THIS SAFETY SYMBOL IS TO ALERT OPERATORS OF A HAZARD
THAT MAY RESULT IN INJURY.
ALWAYS FOLLOW INSTRUCTIONS CAREFULLY**

SAFETY DECALS



- GB **ATTENTION** Description of pictograms.
 F **ATTENTION** Description des pictogrammes.
 D **VORSICH** Beschreibung der Piktogramme.

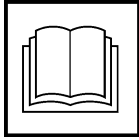

- GB Read Operating manual before use.
 F Lisez Manual D'Opération avant l'utilisation.
 D Vor der Benutzung, Betriebshandbuch lesen.



- GB Do not use without pto shaft guard.
 F Ne pas utiliser sans le dispositif de sécurité de l'arbre (arbre d'entraînement).
 D Nicht benutzen ohne p.t.o. (antriebswelle) Schutzvorrichtung.



- GB Ear defenders must be worn.
 F Défenseurs des oreilles doivent être portés.
 D Gehörschutz getragen werden.

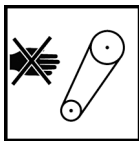

- GB Never remove guards or attempt adjustment until rotor has stopped.
 F Ne retirez jamais les gardes ou d'ajustement tentative jusqu'à ce que toutes les pièces mobiles ont été interrompus.
 D Schutzvorrichtung niemals abnehmen oder einstellung versuchen, bevor der rotor abstellt.



- GB Bystanders must be at least 20 metres from machine range of action.
 F Des spectateurs doivent s'écarter au moins 20 mètres du rayon d'action de la machine.
 D Umstehenden müssen sich mindestens 20 Meter vom Maschinenbetriebsraum entfernen.



- GB Keep clear of unpropped body
 F Reculez de la machine élève.
 D Nicht in die ungeschützte Maschine fassen

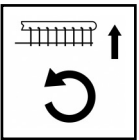

- GB When scarifying, lift rotor before turning.
 F À la course de rayer, élevez le rotor avant de tourner la machine.
 D Beim vertikutieren (Grasnarbe aufreißen) muss der Rotor vor Richtungsveränderungen (Kurven) angehoben werden.

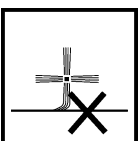

- GB Damage to brushes if set too low.
 F Ne montez pas la brosse très bas.
 D Bürsten können beschädigt werden, wenn sie zu tief eingestellt sind.

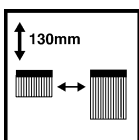

- GB Replace brushes when worn to 130mm of bristle.
 F Remplacez la brosse à 130 mm de longueur de poil.
 D Die Bürsten sind zu wechseln, wenn die Borsten nur noch 130mm lang sind.

SAFETY DECALS



GB Always stop rotor before emptying hopper.

F Arrêtez le rotor avant de vider la trémie.

D Rotor muss vor Entleerung des Behälters zum Stillstand kommen.



GB Keep hands and feet clear

F Garder les mains et les pieds.

D Halten Sie Ihre Hände und Füße.

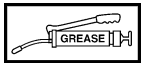

GB Grease points

F Les points de graissage

D Grease Punkte.

IMPORTANT SAFETY WARNINGS



Wessex Machines are guarded for your protection, but you must always observe certain elementary precautions. Machines are potentially **dangerous** and should be used with the greatest respect and **ALL OPERATORS MUST** read this manual and be aware of all safety precautions.

1. **NEVER** attempt any adjustment whatsoever, unless the machine is **COMPLETELY** at a standstill.
2. **NEVER** attempt to clear any obstructions around the machine unless the machine is **COMPLETELY** at a standstill.
3. **NEVER** remove belt guards unless the machine is **COMPLETELY** at a standstill.
4. **NEVER** remove safety guards which are provided for your protection.
5. **NEVER** operate the machine with people behind, keep everybody (especially children and animals) at a safe distance, **minimum 20 metres**.
6. Stand well back from the machine when cutters are spinning.
7. Regularly inspect the **BRUSHES OR BLADES AND FIXING BOLTS** to ensure that they are in tip-top condition. Replace blades **IMMEDIATELY** if any signs of fracture or excess wear becomes apparent. Serious damage, which is excluded from our warranty conditions, may result from using your mower with an unbalanced rotor. When replacing blades, always fit new mounting bolts and nuts to ensure that the rotor is balanced and running smoothly.

HEALTH AND SAFETY - Noise at Work Regulations

READING AT THE OPERATORS EAR

HTC 18 Multifunction Collector: 102 D.B.A.

Depending on conditions this may alter, it is therefore advisable for users to do their own assessment.



In compliance with the above regulations, Ear Protectors must be worn when operating machinery.

WARRANTY

Your Broadwood product or equipment is warranted free from defect in workmanship or manufacture for one year from date of purchase. Any parts which appear to us to be defective, either in material or workmanship shall be replaced or repaired at no cost to the purchaser, subject to the following conditions:

1. The registration card enclosed with this booklet must be returned to us within seven days of purchase.
2. Any failure in the machine should be reported in the first instance immediately to your dealer, who will act on your behalf to resolve the matter to your satisfaction.
3. The defective parts will be returned by your dealer to us, accompanied by a full statement describing the failure and the circumstances and conditions in which the failure occurred.
4. The following are specifically excluded from our terms of warranty:
 - a) Fair wear and tear, especially to belts, brushes, blades and spinners.
 - b) Damage to blades or brushes caused through incorrect positioning of the rotor (see instructions).
 - c) Damage caused by neglect or lack of lubrication.
 - d) Damage caused by misuse or abuse.
 - e) Damage caused whilst the machine is in transit.
 - f) Damage caused to the frame of the machine by running the machine with unbalanced rotors, blades or spinners.
 - g) Damage caused to the machine by use with loose nuts, bolts, screws or any other type of fittings.
5. The warranty is for the benefit of the first user only.
6. Broadwood International decisions will be final and binding.

Note:

It is recommended that every machine is inspected after one hour of operation to check that all nuts, bolts, screws or any other types of fixings are tight and any loose fixings or components should be rectified as appropriate.

Further inspections should be carried out at regular intervals thereafter.

SETTING UP YOUR WESSEX HTC18 MULTI-FUNCTION COLLECTOR

Your Wessex HTC 18 has been designed to work in a wide variety of conditions, and is a very simple machine to use. There are one or two adjustments which ensure optimum performance in all conditions.

The drawbar has a ring hitch coupling and should be coupled to your tractor as follows:-

1. If the tractor has an automatic pick-up hitch, lift up the machine with the hitch, and screw up the parking jack tightly. If the tractor has a clevis hitch, reverse the tractor up to the hitch and couple up with the drawbar pin (not supplied) and retain with a lynch pin.

2. Connect the P.T.O. shaft, **taking particular care that the shaft is not too long for the tractor**. When the shaft is in its working position it should **not** be fully compressed. To check this, ensure that it is possible to compress the shaft further in order to remove it. If necessary, the shaft, which is of tubular section, may be easily cut with a hacksaw, ensuring that an equal amount is cut from both male and female sections.

Never make any adjustments to the machine until the tractor engine is switched off and at a standstill.

3. Connect the sweeping head height adjustment hose to the tractors' single acting spool valve.

4. Connect the main hopper lift ram hose to the tractors' double acting spool valve. A Hydraulics Option Kit is available for tractors without a double spool valve.

5. When setting up your HTC 18, it is important that the main frame is approximately 280mm off the ground at the lowest point of the machine. This ensures that the head follows the ground contours.

ADJUSTING THE ROTOR HEIGHT

When sweeping or mowing, the weight of the sweeping head is carried on the two casting wheels, which are on adjustable mounting bars, allowing the head to be raised or lowered in increments of 6mm according to conditions.

The bristle should be in gentle contact with the ground for maximum pick up action (see diagram). If there is a drumming sound as the brush rotates, the brushes are set too low and should be raised immediately to avoid damage to the brushes.

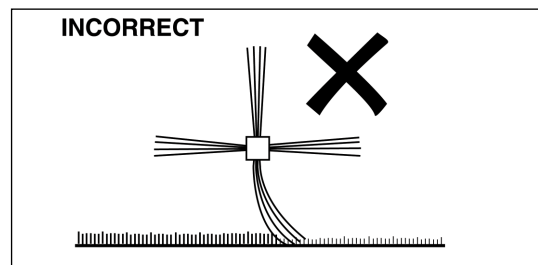
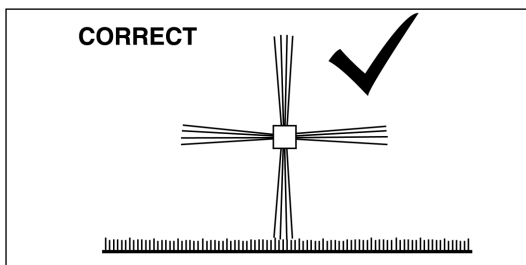

The brushes alone are not designed for scarifying or thatch removal, and damage to the brushes will quickly occur if it is used for this purpose.

When using the Sweeper it is a good idea to start off with the rotor fully raised, and to lower it if necessary until a satisfactory result is achieved. If leaves are blown away from the rotor by excessive air turbulence, lower the adjustable front brush strip fully (see next section) and only then lower the rotor.

ADJUSTING THE FRONT BRUSH STRIP

At the front of the Sweeper, there is an adjustable brush strip bolted to the frame through a series of adjustment holes.

When sweeping grass clippings, or autumn leaves on turf areas, the brush strip should normally be in the lowest position. For a heavy fall of leaves, the strip can be raised to prevent a build-up in front of the machine.

When sweeping on hard surfaces it is usually necessary to lower the strip to reduce air turbulence at the front of the Sweeper. Because there is less resistance on hard surfaces to air turbulence, it is often advantageous to reduce the rotor speed by throttling back the engine.

Conditions will vary on the same site from day to day, dependent on weather conditions. There are sufficient adjustments of the brush strip and of the rotor position to ensure that your HTC 18 does a good job in all conditions. By experimenting with different adjustments you will quickly find the optimum setting to suit your conditions.

EMPTYING THE HOPPER

1. When sweeping light, dry leaves, the hopper may be filled to its capacity. When sweeping very wet leaves or heavy material, **DO NOT FILL** to maximum capacity, as this will overload the hydraulics (See diagram below). Observe maximum fill line in these conditions.

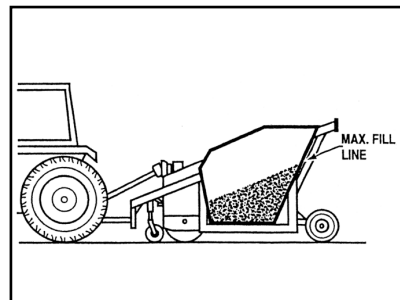
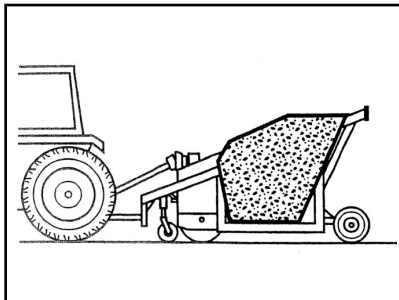

2. When tipping, reverse as near as possible to trailer or skip and fully raise hopper. The raise and lower speed of the hopper can be adjusted using the flow regulators located on the main frame behind the drawbar.

3. **ALWAYS** return the hopper to its down position before driving away.

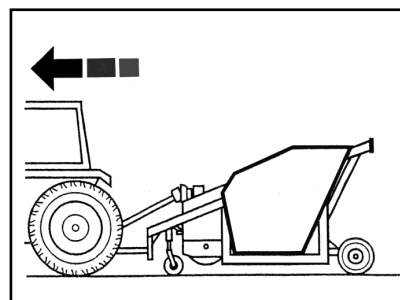
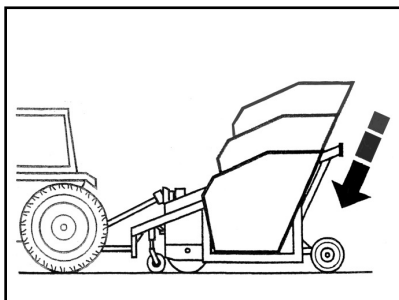

4. When travelling out of work, the sweeping head should be secured in the up position with the two locking pins on the lower lift lever.

CHAIN ADJUSTMENT (See Plate 4)

- To adjust the drive chain, first remove the chain guard, loosen the two nuts and bolts that hold the cast iron drive housing and loosen the locking nut on adjusting screw (item No. 21), turning the adjuster clockwise to tighten and anti-clockwise to loosen.
- Correct tension is when the chain can be deflected 8mm under thumb pressure.
- Tighten all nuts and bolts and replace chain guard.

COMPENSATING FOR BRUSH WEAR

- The bristles on your Sweeper Rotor will wear in due course, and it will be necessary to raise the front wheels to take account of this.
- The Sweeper has been designed to work effectively until the bristles are approximately half their original length. When the bristles wear beyond this point there is insufficient momentum to throw leaves and debris into the hopper, and it will be necessary to replace the brushes on your machine.

ROUTINE MAINTENANCE

DAILY (8-10 Working Hours)

- Grease PTO Shaft and Cross Shaft Universal Joint

REGULARLY

- Check Gearbox oil level and top up with EP90 gear oil
- Grease Parking Jack

PERIODICALLY (50+ Hours)

- Grease Wheel Bearings
- Grease Hopper Pivot Points
- Grease Chain and Sprocket - use adhesive grease SINIT III
- Grease Hopper Guide Channels
- Grease Wheel Adjustment Bars to avoid corrosion
- Grease Rotor Bearings and Cross Shaft End Bearings every 150 hours
- Check Tyre Pressure - according to the tyre manufacturers recommendation

CHANGE OVER PROCEDURE FROM SWEEPING TO SCARIFYING / MOWING

(See Plates 4 and 5)

1. Remove chain case. Slacken chain tensioner bolt (21). Lift off chain.
2. Remove front brush strip and jockey wheels.
3. Lower mainframe to ground. Remove all skid retaining bolts (39 and 40) Remove M12 fastening set (9) from rotor retaining brackets (10).
4. Remove 'R' clip (20) from retaining pin.
5. Jack up front of mainframe and slide rotor forward, clear of brush head.
6. Refit flail rotor. Lever rotor assembly into place, lower mainframe, aligning skid adjustment stems (41). Secure with 'R' clip (20) and M16 nuts and washers (40). Fit M10 skid retaining bolts (39).
7. Replace front brush strip with roller scraper and remove jockey wheels.
8. Change top 19T sprocket for 27T as supplied.
9. Refit chain and tension. Replace chain case.
10. Run and test.

FITTING BLADES FOR SCARIFYING

IMPORTANT: ALL DIRECTIONS START FROM DRIVE END OF ROTOR.

ROW A - Scarifying tine in 2nd clevis and every other.

ROW B - Fan blade **only**. Every clevis.

ROW C - Scarifying tine in 2nd clevis and every other.

ROW D - Scarifying tine in 1st clevis and every other.

ROW E - Fan blade **only**. Every clevis.

ROW F - Scarifying tine in 1st clevis and every other.

If required, mowing blades can be fitted with scarifying knives, but it is very important that the correct pattern is used for the scarifying knives and that all mowing flails are kept in a symmetrical pattern so as not to put the rotor out of balance.

FITTING BLADES FOR MOWING

Attach machine to tractor, tip hopper and locate hopper prop. Rotor is now accessible for fitting blades.

Fit pairs of flails back to back in rows A, C, D and F with axles and pins.

In rows B and E, fit fan blades only.

IMPORTANT: BLADES MUST BE IN STRICT PATTERN AS INDICATED

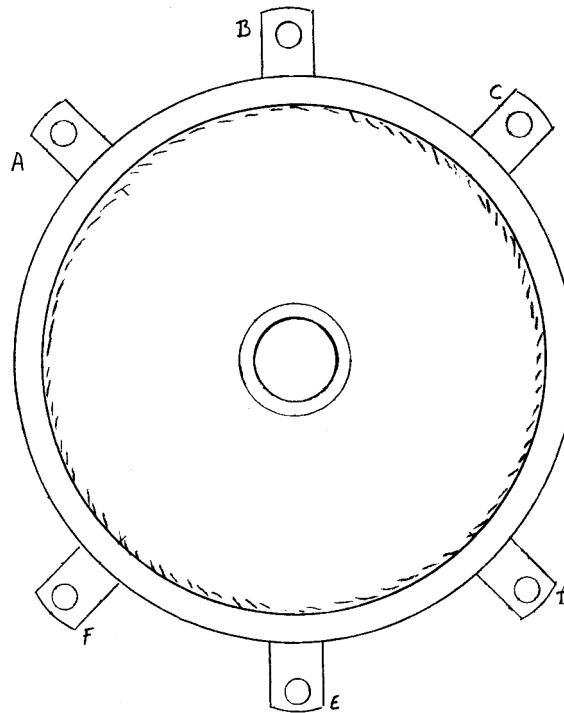

SETTING UP FOR FLAIL MOWING AND SCARIFYING

The floating head is designed to run on the front roller. The two small wheels at the rear of the head are anti-scalping wheels only.

Height adjustment is achieved by raising or lowering the side skids, using the adjuster see item A on diagram.

When setting up for mowing for scarifying, these anti-scalping wheels should be 20-30mm off the ground on the flat. To adjust the roller height, simply adjust on the skid adjuster with a 24mm spanner. Ensure that both sides of the machine are adjusted the same. See depth gauge at the front of the head.

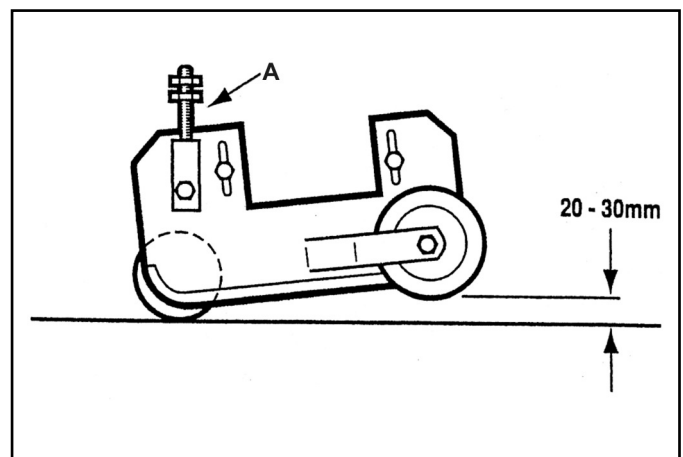

TROUBLESHOOTING

FAULT	CAUSE	REMEDY
Not sweeping correctly	1. Worn brushes 2. Belts slipping 3. Brushes set too high	1. Replace brushes 2. Adjust belt tension 3. Lower brush to the ground
Blowing dry leaves away and not collecting	1. Engine revs too high 2. Front brush worn or missing	1. Reduce engine revs 2. Replace front brush bar
Drumming noise	1. Brushes set too low	1. Raise sweeping height
Vibration	1. Brushes set too low 2. Brushes loose on main rotor 3. Brush broken	1. Raise sweeping height 2. Tighten up brushes 3. Replace brush
Uneven lines when scarifying	1. Scarifying tines fitted incorrectly	1. Fit according to instruction book
Vibration	1. Blades missing 2. Bent Rotor	1. Check blades and fit as necessary 2. Fit new rotor

SPECIFICATION

MODEL	HTC18 Multi Function Collector
Weight (approx) Fitted with Brush option	942kg
Weight (approx) Fitted with Flail option	996kg
Working Width:	1.8m
Overall Width:	2.25m
Overall Length (excl. drawbar):	3m
Rear Tyre Size:	18.5 x 8.5.8
Hopper Capacity (approx):	2.5m ³
Discharge Height:	1.8m
Power Requirement:	30hp+

FUNCTION CHANGE KITS

<u>FROM</u>	<u>TO</u>	<u>KITS REQUIRED</u>
Scarifier	Flail mower (flails only)	FCK 5 + 7
Scarifier	Flail mower (rotor change)	FCK 5 + 8
Scarifier	Sweeper	FCK 3 + 5
Flail mower	Scarifier (flails only)	FCK 4 + 6
Flail mower	Scarifier (rotor change)	FCK 4 + 9
Flail mower	Sweeper	FCK 3
Sweeper	Scarifier	FCK 1 + 4
Sweeper	Flail mower	FCK 2

For your information, the list below details what comprises each kit:-

FCK 1	-	Steel rotor, clockwise scarifying knives and paddles, sprocket, bearing brackets, side plates, clockwise anti-scalp wheels and front roller guard.
FCK 2	-	Steel rotor, clockwise grass flails and paddles, sprocket, bearing brackets, side plates, clockwise wheels and roller guard.
FCK 3	-	Brush rotor assembly, sprocket, side plates and front brush strip.
FCK 4	-	Front roller and clockwise bearings.
FCK 5	-	Front castoring wheel assemblies.
FCK 6	-	Set of scarifying knives and paddles.
FCK 7	-	Set of grass flails and paddles.
FCK 8	-	Steel rotor, clockwise grass flails and paddles, sprocket and bearing brackets.
FCK 9	-	Steel rotor, clockwise scarifying knives and paddles, sprocket and bearing brackets.

PARTS ILLUSTRATION - MAINFRAME ASSEMBLY - PLATE 1

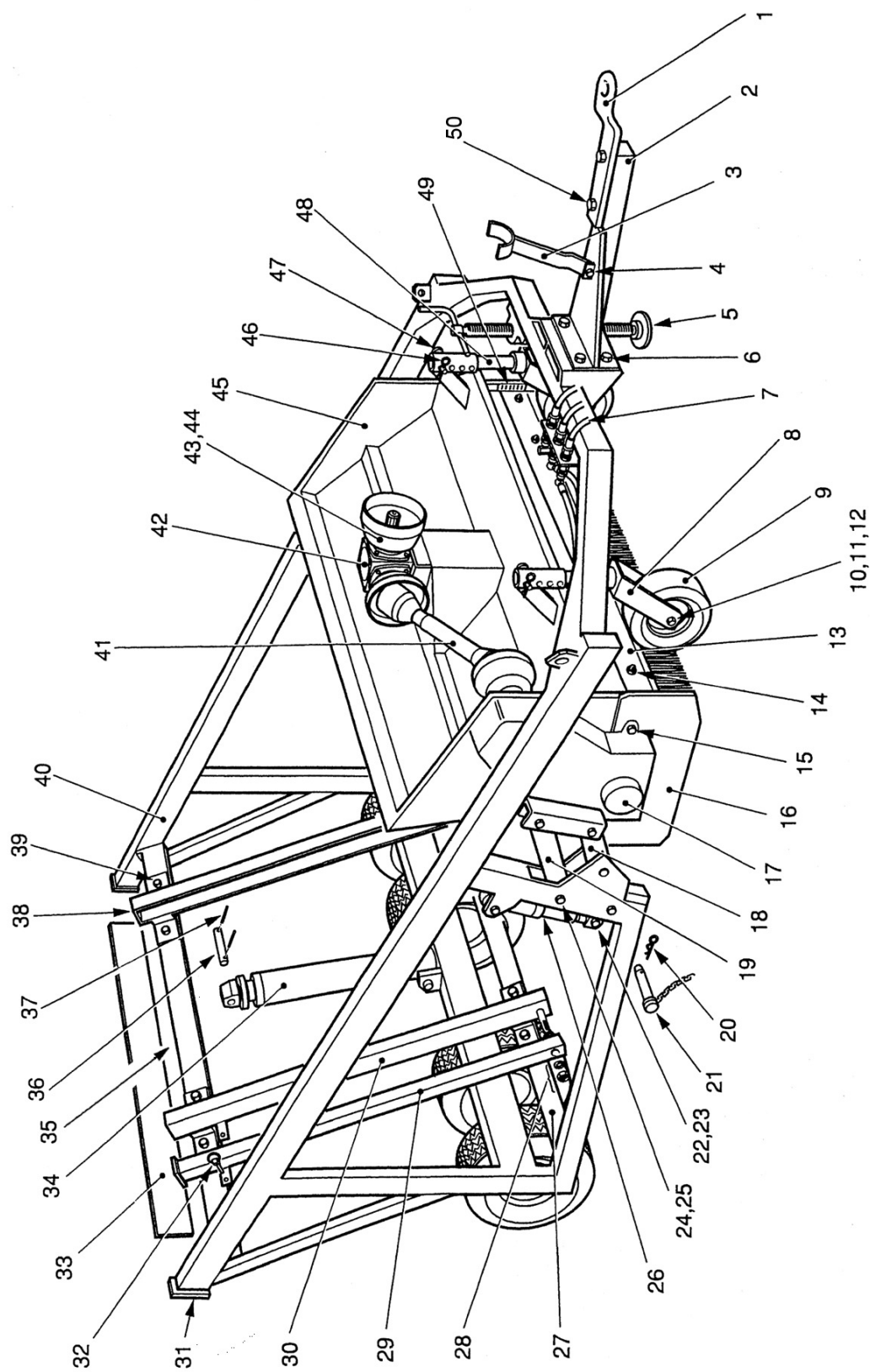

PLATE 1

PARTS LIST - MAINFRAME ASSEMBLY - PLATE 1

Item No.	Part No.	Description	Qty. per Machine
1	WX-2330	Ring Hitch	1
2	WX-5980	Drawbar Bracket	1
3	WX-5680	PTO Prop	1
4	WX-2702	Prop Fastening Set	1
5	WX-10756	Jack Assembly	1
6	WX-12101	Drawbar Fastening Set	1
7	WX-8056	Hydraulic Hose Kit	1
8	WX-4251	Wheel Fork	2
9	WX-1552	Wheel Assembly	2
10	WX-0838	Wheel Bearing	4
11	WX-6303	Axle	2
12	WX-4551	Wheel Spacer (2152 Wheel Only)	4
13	WX-1776	Front Brush	1
14	WX-9701	Front Brush Fastening Set	1
15	WX-13401	Chain Guard Fastening Set	1
16	WX-4178	Drive Rotor Guard	1
N/S	WX-4078	Non Drive Rotor Guard	1
17	WX-3878	Chain Guard	1
18	WX-1458	Lower Lift Arm	2
19	WX-1358	Upper Lift Arm	2
20	WX-0421	'R' Clip	2
21	WX-0826	Pin	2
22	WX-9356	Ram Clevis	2
23	WX-4928	Ram Clevis Pin	2
24	WX-12301	Lift Arm Fastening Set	8
25	WX-0741	Lift Arm Bush	8
25A	WX-2838	Lift Arm Nylon Bush	16
26	WX-6356	Head Lift Ram	2
27	WX-3676	Guide Channel Support Lower	1
28	WX-12501	Safety Prop Fastening Set	1
29	WX-8780	Safety Prop	1
30	WX-1958	Right Hand Guide Channel	1
31	WX-3380	Buffer	4
32	WX-0227	Lynch Pin	1
33	WT-LB/25	Optional Road Light Kit	1
34	WX-6256	Hopper Ram	1
35	WX-3776	Guide Channel Support Upper	1
36	WX-3628	Hopper Ram Pin	2
37	WX-2022	Roll Pin	4
38	WX-2058	Left Hand Guide Channel	1
39	WX-12701	Guide Channel Fastening Set	1

PARTS ILLUSTRATION - MAINFRAME ASSEMBLY - PLATE 1

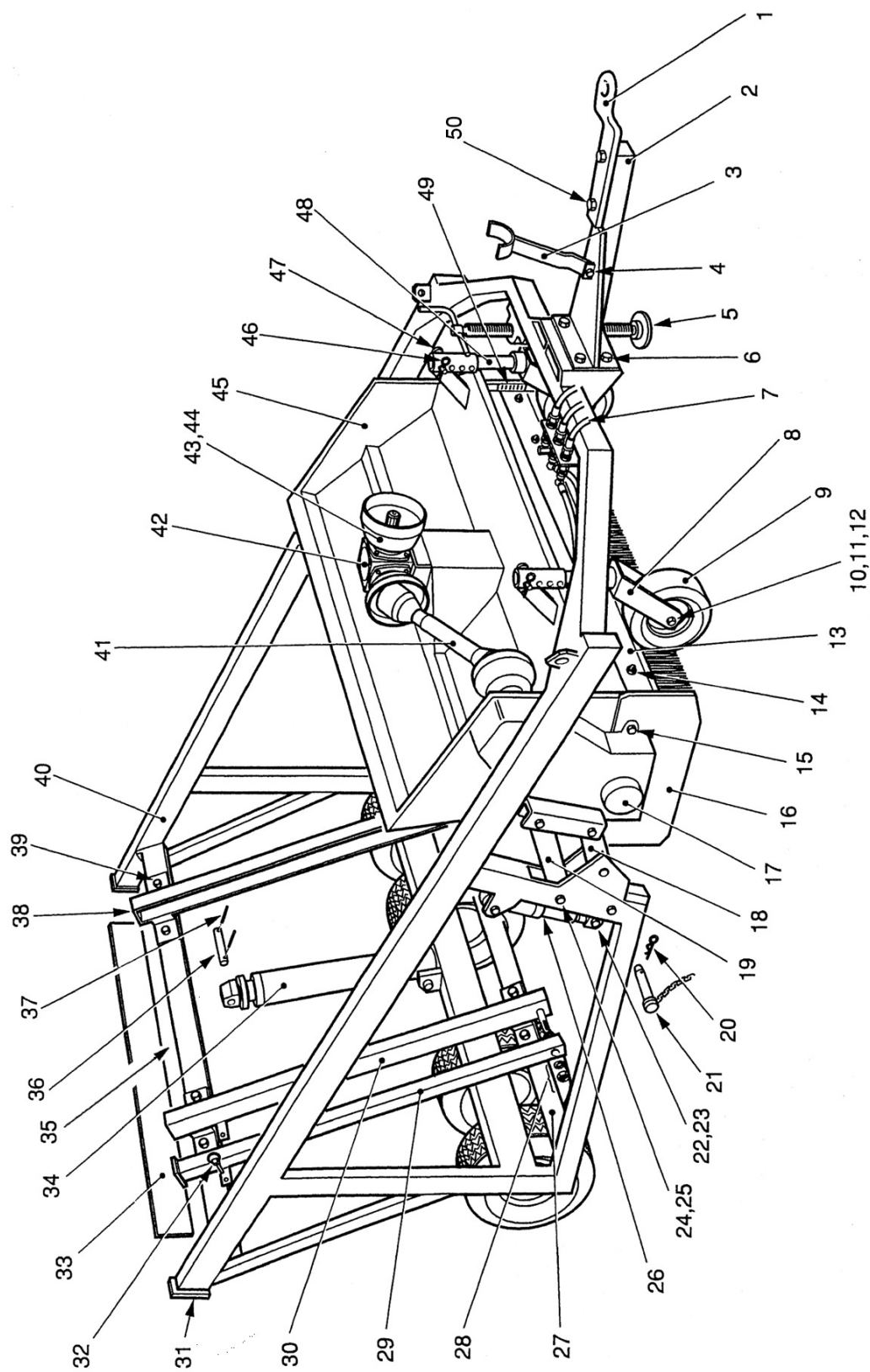

PLATE 1

PARTS LIST - MAINFRAME ASSEMBLY - PLATE 1

Item No.	Part No.	Description	Qty. per Machine
40	WX-6879	Main Frame	1
41	WX-4181	Cross-Shaft	1
42	WX-7557	Gearbox	1
43	WX-10178	Cone Guard	3
44	WX-3103	Cone Guard Fastening Set	1
45	WX-7079	Rotor Housing	1
46	WX-0121	'R' Clip	2
47	WX-0628	Height Adjustment Pin	2
48	WX-5753	Height Adjustment Stem	2
49	WX-8880	Depth Control Plate	2
50	WX-12201	Ring Hitch Fastening Set	1
N/S	WX-1245	Ram Seal Kit	1
N/S	WX-1345	Head Lift Ram Seal Kit	1
N/S	WX-9178	Left Hand Leg Guard	1
N/S	WX-9278	Right Hand Leg Guard	1
N/S	WX-0640	Channel Buffer	4

PARTS ILLUSTRATION - REAR ASSEMBLY - PLATE 2

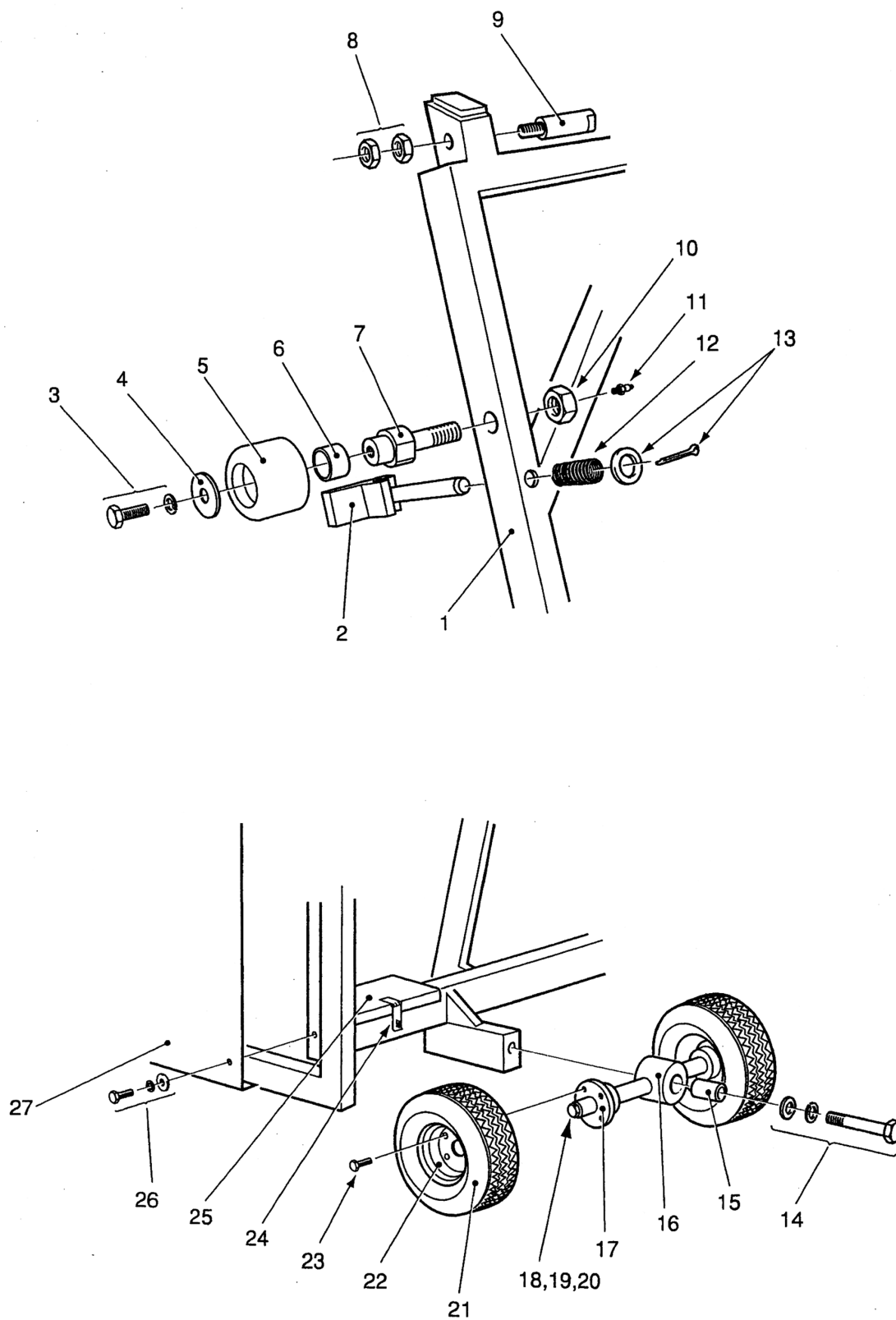
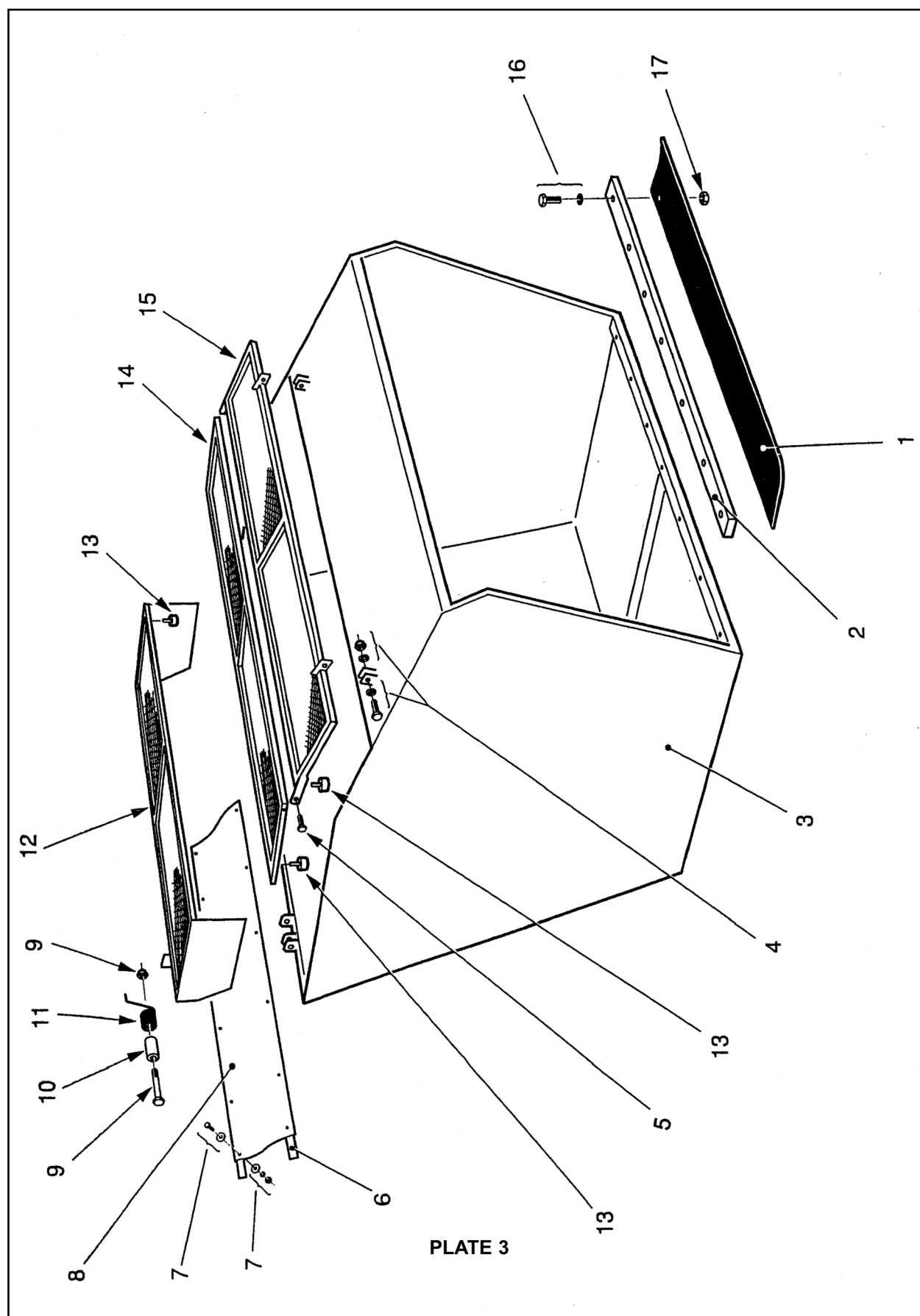

PLATE 2

PARTS LIST - REAR ASSEMBLY - PLATE 2

Item No.	Part No.	Description	Qty. per Spindle
1	WX-6080	Guide Frame	1
2	WX-9756	Hopper Catch	2
3	WX-20101	Roller Fastening Set	2
4	WX-1520	Washer	4
5	WX-2055	Roller	4
6	WX-4338	Bush	4
7	WX-6566	Guide Roller Spigot	4
8	WX-12901	Pivot Pin Fastening Set	2
9	WX-2628	Pivot Pin	2
10	WX-13001	Spigot Fastening Set	4
11	WX-0546	Grease Nipple	4
12	WX-1625	Spring	2
13	WX-20201	Hopper Catch Fastening Set	2
14	WX-20301	Axle Fastening Set	2
15	WX-6153	Axle Bush	2
16	WX-6053	Twin Swivel Axle	2
17	WX-13051	Wheel Hub	4
18	WX-4951	Hub Cap	4
19	WX-0838	Bearing Inner	4
20	WX-1538	Bearing Outer	4
21	WX-2652A	Tyre	4
22	WX-2652	Wheel Assembly	4
23	WX-4253	Wheel Stud	10
24	WX-6879HS	Hasp and Staple	1
25	WX-6879W	Toolbox	1
26	WX-20401	Side Panel Fastening Set	2
27	WX-6078	Left Hand Side Panel	1
N/S	WX-6178	Right Hand Side Panel	1

PARTS ILLUSTRATION - HOPPER - PLATE 3



PARTS LIST - HOPPER - PLATE 3

Item No.	Part No.	Description	Qty. per Machine
1	WX-4376	Front Flap	1
2	WX-3876	Flap Clamp Bar	1
3	WX-6779	Hopper	1
4	WX-20501	Front Cover Fastening Set	1
5	WX-20601	Middle Cover Fastening Set	1
6	WX-4476	Chute Clamp Bar	2
7	WX-20701	Clamp Bar Fastening Set	2
8	WX-4176	Discharge Chute Cover	1
9	WX-20801	Spring Fastening Kit	2
10	WX-4828	Spring Spacer	2
11	WX-2925	Left Hand Torsion Spring	1
N/S	WX-3025	Right Hand Torsion Spring	1
12	WX-9480	Hopper Discharge Chute	1
13	WX-8180	Cover Flap Buffer	6
14	WX-9580	Middle Cover	1
15	WX-10980	Forward Cover	1

PARTS ILLUSTRATION - ROTOR ASSEMBLY - PLATE 4

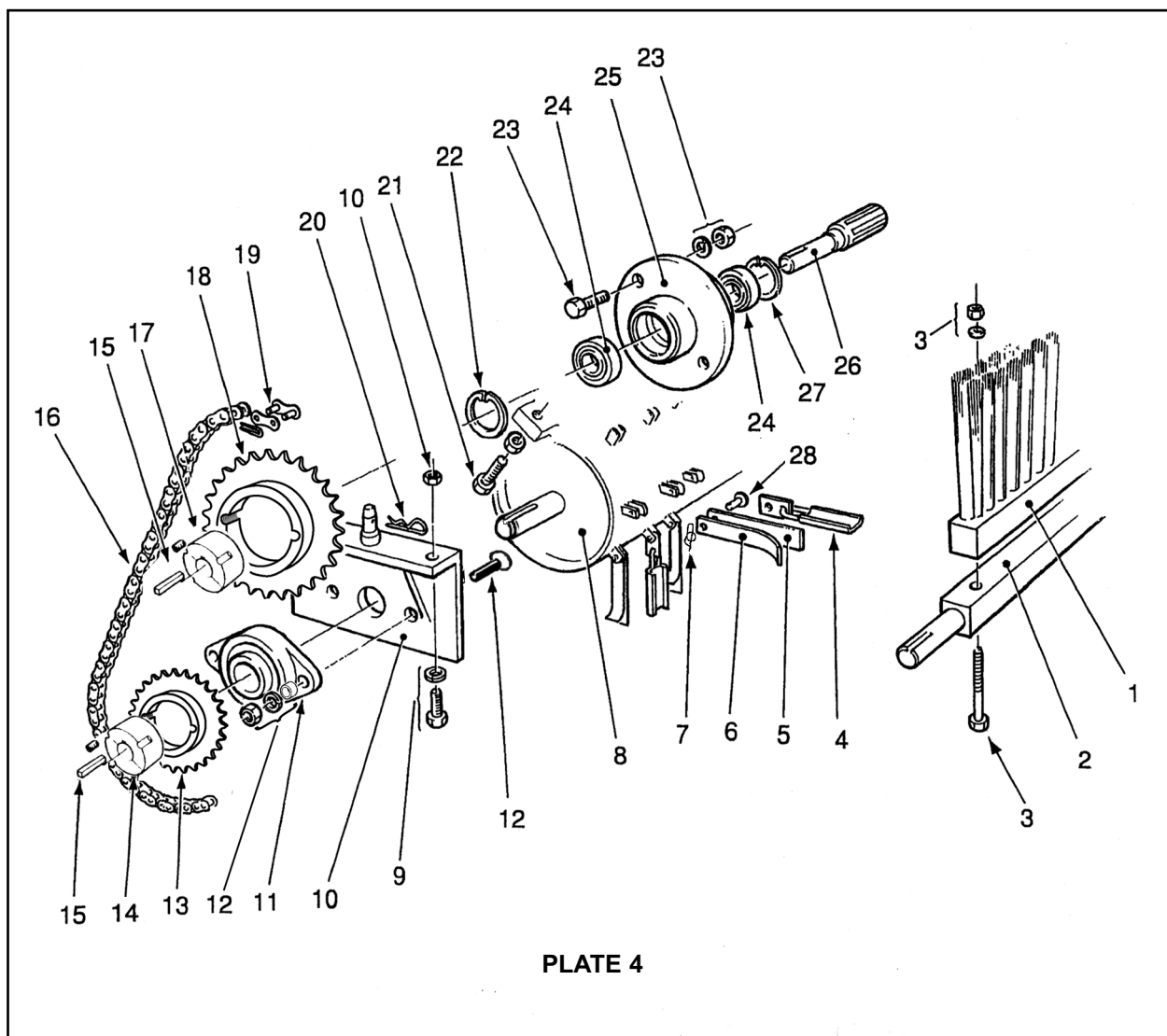

PLATE 4

PARTS LIST - ROTOR ASSEMBLY - PLATE 4

Item No.	Part No.	Description	Qty. per Machine
1	WX-2870	Brush Strip	12
2	WX-7366	Brush Rotor	1
3	WX-5001	Brush Fastening Set	6
4	WX-14061	Ventilation Blade	56
5	WX-17671	Scarifying Blade	56
6	WX-11020	Flail Blade	108 pairs
7	WX-6802	Axle Pin	164
8	WX-7266	Flail Rotor	1
8A	WX-7466	Scarifying Rotor	1
9	WX-13101	Bearing Bracket Fastening Set	2
10	WX-8656	Bearing Bracket	2
11	WX-0641	Rotor Bearing	2
12	WX-6301	Bearing Fastening Set	4
13	WX-9162	Brush Rotor Sprocket	1
13A	WX-8862	Scarify Rotor Sprocket	1
14	WX-5962	Brush Rotor Taper Lock	1
14A	WX-8962	Scarify Rotor Taper Lock	1
15	WX-0147	Key	2
16	WX-1534	Chain	1
17	WX-8762	Brush Drive Taper Lock	1
17A	WX-6562	Scarify Drive Taper Lock	1
18	WX-9062	Brush Drive Sprocket	1
18A	WX-9362	Scarify Drive Sprocket	1
19	WX-1634	Chain Link	1
20	WX-0121	'R' Clip	2
21	WX-2625	Chain Tensioner	1
22	WX-1722	Circlip	2
23	WX-7302	Bearing Housing Fastening Set	1
24	WX-0838	Bearing	2
25	WX-6166	Bearing Housing	1
26	WX-6266	Stub Shaft	1
27	WX-0922	Circlip	1
28	WX-10999	Flail Axle	164

PARTS ILLUSTRATION - ROLLER AND SKID ASSEMBLY - PLATE 5

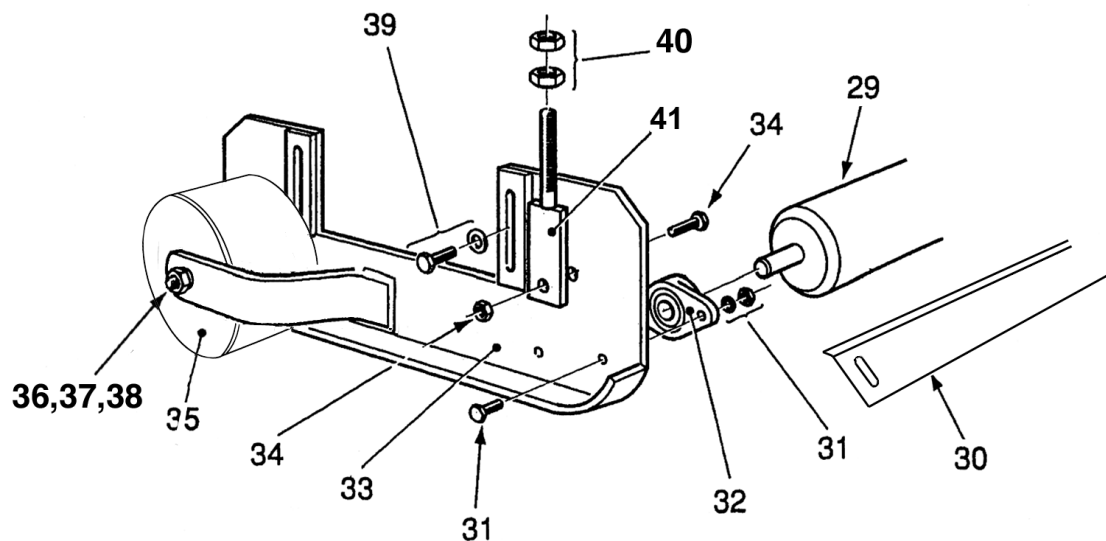
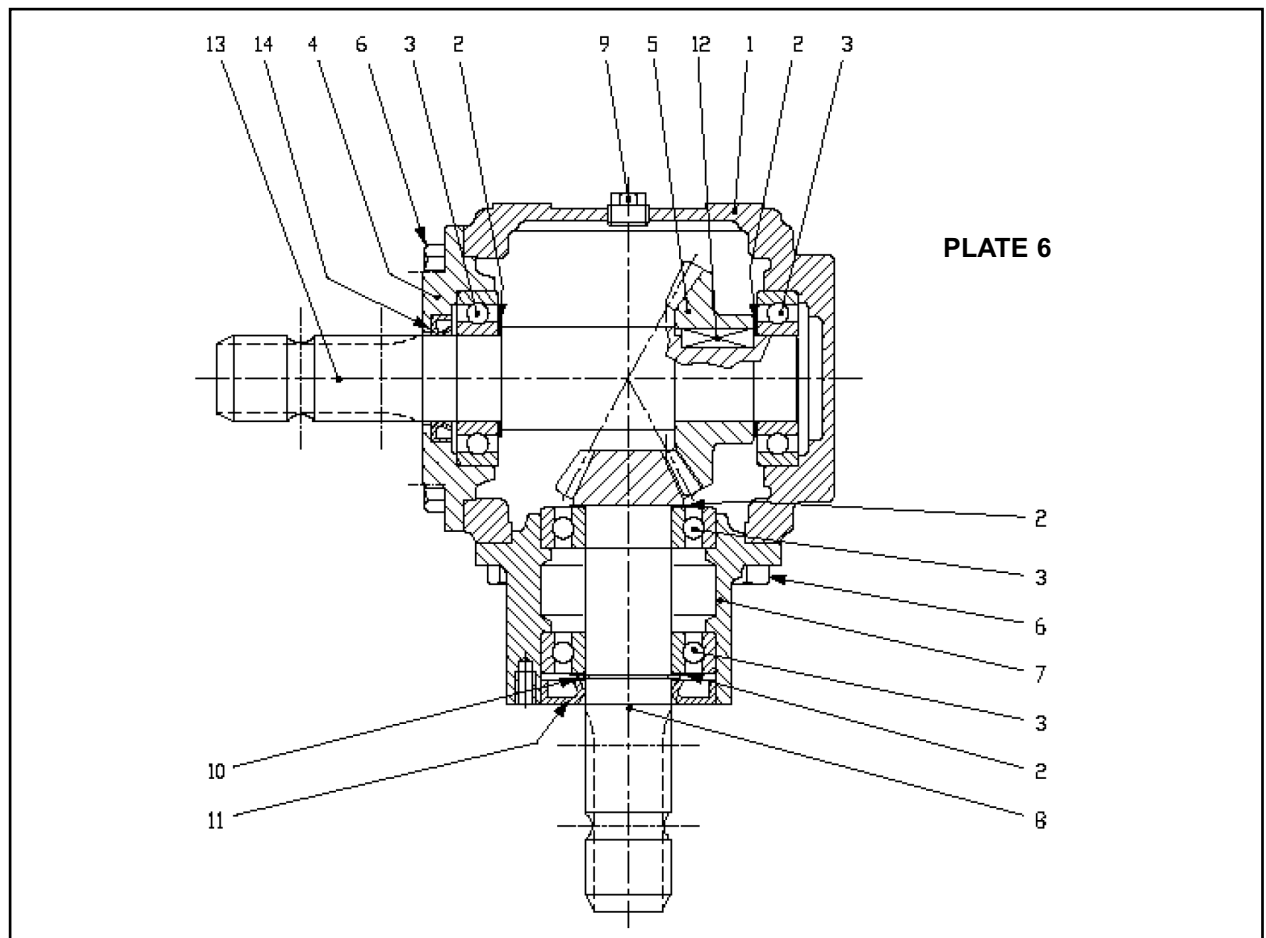

PLATE 5

PARTS LIST - ROLLER AND SKID ASSEMBLY - PLATE 5

Item No.	Part No.	Description	Qty. per Machine
29	WX-1555	Front Roller	1
30	WX-9556	Roller Scraper	1
31	WX-8403	Bearing Fastening Kit	4
32	WX-0541	Roller Bearing	2
33	WX-2874	Right Hand Adjusting Skid	1
33A	WX-3174	Left Hand Adjusting Skid	1
34	WX-13201	Adjuster Fastening Set	4
35	WX-2155	Anti-Scalp Roller	2
36	WX-1438	Wheel Bearing	4
37	WX-13501	Axle Fastening Set	2
38	WX-11851	Wheel Bush	2
39	WX-20901	Skid Fastening Set	2
40	WX-18101	Adjuster Lock Nut	8
41	WX-9456	Adjuster	4

PARTS ILLUSTRATION - GEARBOX - PLATE 6



PARTS ILLUSTRATION - GEARBOX - PLATE 6

Item No.	Part No.	Description	Qty. per Machine
1	0.259.0300.00	Casing	1
2	0.259.7500.00	Shim	4
3	8.0.1.00025	Bearing	4
4	0.259.1305.00	Cover	1
5	0.259.6001.00	Crown Wheel	1
6	8.1.1.00090	Bolt	8
7	0.259.1300.00	Extension	1
8	0.259.5003.00	Pinion	1
9	8.6.5.00006	Plug	1
10	8.5.1.00005	Snap Ring	1
11	8.7.3.00055	Oil Seal	1
12	8.4.1.00057	Parallel Key	1
13	0.259.3101.00	Shaft	1
14	8.7.3.00028	Oil Seal	1

PARTS ILLUSTRATION - TRACTOR PTO SHAFT - PLATE 7

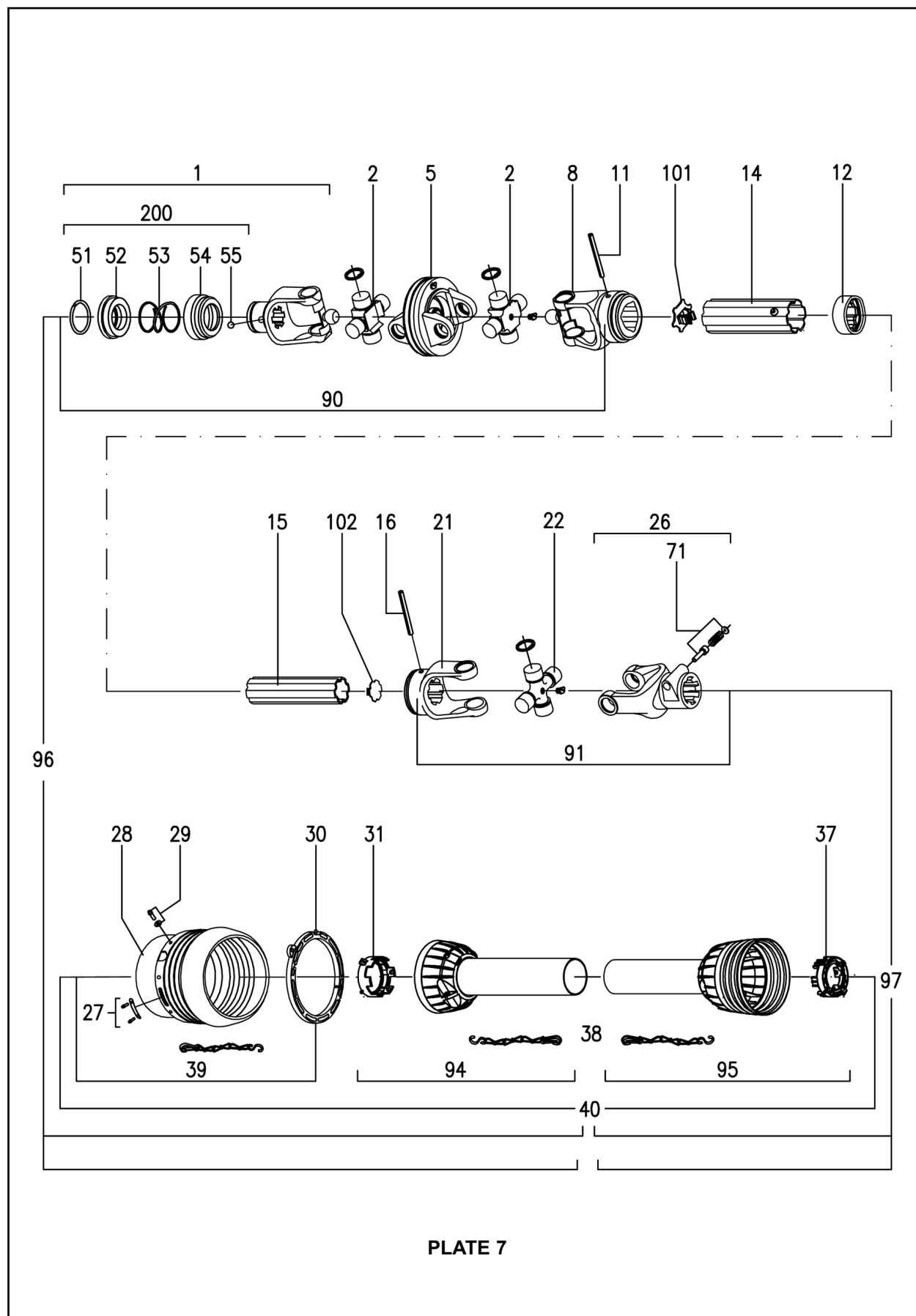

PLATE 7

PARTS LIST - TRACTOR PTO SHAFT - PLATE 7

Item No.	Part No.	Description	Qty.
0	WX-4081	Complete PTO Shaft	1
1	141.026.503	Complete Collar Yoke	1
2	180.016.228	Cross Journal Set	2
5	141.026.617	Wide Angle Yoke	1
8	141.026.390	Outer Yoke	1
11	190.000.018	Roll Pin	2
12	180.016.573	Wiper	1
14	150.261.507.7830	Complete Outer Tube	1
15	159.260.142	Inner Tube	1
21	151.016.389	Inner Yoke	1
22	180.016.004	Cross Journal Set	1
26	141.026.001	Complete Push-Pin Yoke	1
27	165.000.790	Set Sheet & Screw	1
28	180.026.611	Guard Cone For Wide Angle CV Joint	1
29	165.000.694	Set Screw	6
30	158.016.613	Cone For CV Joint	1
31	180.016.596	Guard Retaining Collar For Outer Tube	1
37	180.016.595	Guard Retaining Collar For Inner Tube	1
38	180.016.790	Safety Chains	3
39	165.000.750	Guard Cone Set	1
40	142.961.544.2650	Complete Guard	1
51	190.000.451	Circlip	1
52	151.016.486	Sliding Sleeve Collar	1
53	180.016.487	Spring	1
54	180.016.483	Fixed Sleeve	1
55	190.000.078	Ball	3
71	166.026.004	Push-Pin Set	1
90	121.026.102.00	Wide Angle CV Joint For Outer Tube	1
91	121.026.185.00	U Joint For Inner Tube	1
94	142.366.086.2650	Half Female Guard	1
95	142.367.117.2650	Half Male Guard	1
96	199611610EN02700	Half Female Shaft With Guarding	1
97	123.666.175.00	Half Male Shaft With Guarding	1
100	190.000.692	Instruction Manual	1
101	180.016.474	Outer Cap	1
102	180.016.575	Inner Cap	1
200	165.000.628	Kit Collar	1

PTO SHAFT OPERATION AND MAINTENANCE

IMPORTANT!

PTO drive shafts must only be used for their intended purpose.

PTO drive shafts are designed for specific machine types and power requirements.

They must not be replaced by other models.

Ensure that the PTO drive shaft is securely connected.

Only use a completely protected drive system:

PTO drive shaft with complete guard and complementary guard on tractor and implement. A complete guard is essential in all working positions.

LUBRICATION

Lubricate with quality grease before starting work and every 8 operating hours.

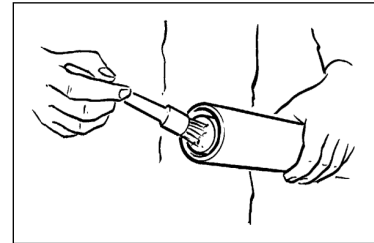

Clean and grease the PTO drive shaft before each prolonged period of non-use.

Grease the guard tubes in winter to prevent freezing.

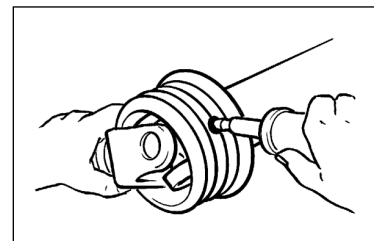

COUPLING THE PTO SHAFT

Clean and grease the PTO and PIN

Q.-d pin

Press q.-d. pin and simultaneously push PTO drive shaft onto PTO until pin engages.

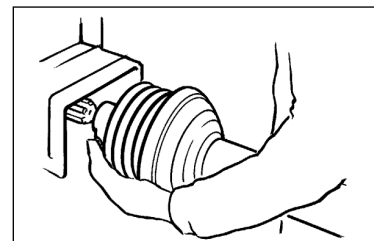

PTO SHAFT OPERATION AND MAINTENANCE

LENGTH ADJUSTMENT

To adjust the length, hold the half-shafts next to each other in the shortest working position and mark them.

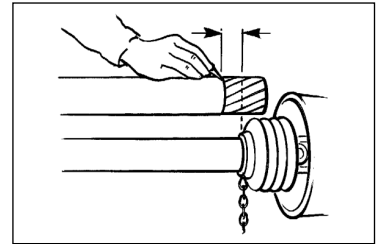

Shorten inner and outer guard tubes equally.

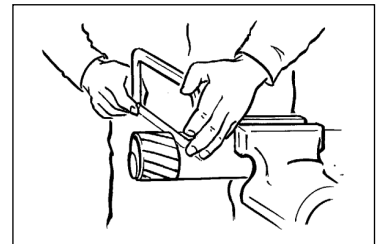

Shorten inner and outer sliding profiles by the same length as the guard tubes.

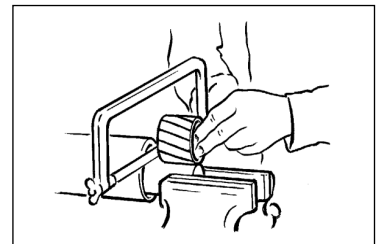

Round off all sharp edges and remove burrs.
Grease sliding profiles.

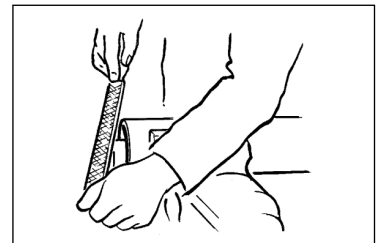

No other changes may be made to the PTO drive shaft and guard.

CHAINS

Chains must be fitted so as to allow sufficient articulation of the shaft in all working positions.

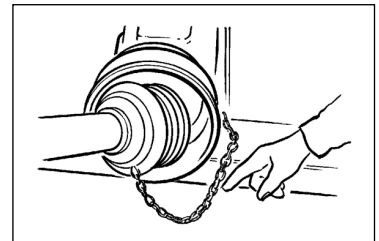

The PTO drive shaft must not be suspended from the chains!

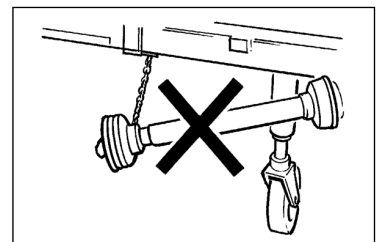

SAFETY TRAINING INDUCTION

The undersigned personnel have been trained in the safe use of this Wessex Proline HTC 18 and have understood the contents of the Operator's Manual.

[illegible]

[illegible]



Certificate of CE Conformity

Machine Model:

HTC18

Description:

MULTI FUNCTION COLLECTOR

*I hereby certify that the machine detailed hereon
conforms to:*

**European Directives 2008/42/EC
Supply of Machinery Regulations 2008
As amended 91/368EEC – 93/44EEC – 93/68EEC**

Signed:

.....
Quality Manager

Date:

April 2012



Broadwood International

Trading Estate, Oakhanger Road, Bordon. Hampshire GU35 9HH
Telephone: 01420 478111 Fax: 01420 483000
e-mail: sales@broadwoodintl.co.uk

www.broadwoodintl.co.uk



Manufacturers and Distributors of Quality Equipment

Broadwood International
Trading Estate, Oakhanger Road, Bordon, Hampshire. GU35 9HH

Telephone: 01420 478111 Fax 01420 483000
e-mail: sales@broadwoodintl.co.uk

www.broadwoodintl.co.uk
