

Operation Manual and Parts Book

Wessex Brine Mixer 500L

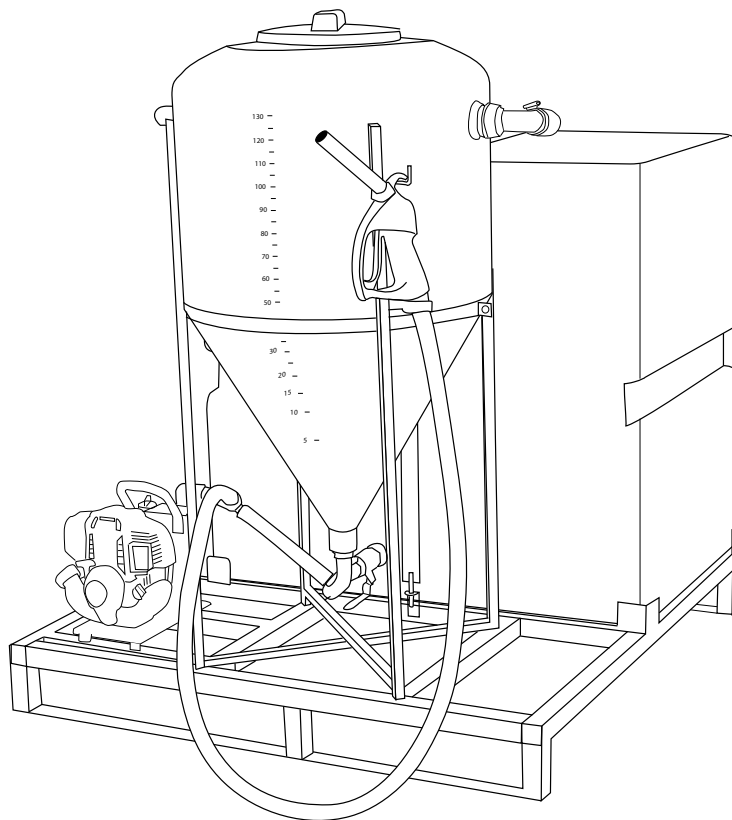

Product Code: L2038

CONTENTS

Welcome to your new Wessex Product2

Safety Decals3

Important Safety Warnings3

Warranty4

Mixing the Brine5

Dispensing the Brine Solution6

Cleaning your Mixer6

Maintenance7

Specifications7

Parts Illustration / Parts List8

CE Certificate9

WELCOME TO YOUR NEW WESSEX PRODUCT

Thank you for purchasing a Wessex product. As a Wessex customer, you now number among the most important people of our business and we will endeavour to give you the best service available through our dealer network.

Please read this Manual carefully and familiarise yourself and other persons that will be using the machine with its contents, to ensure the optimum performance and working life of your machine. It is advisable that a copy of this Manual is kept in the workshop and one copy with the machine. Further copies are available through your dealer.

On delivery, your dealer should go through the workings of the machine with you, explaining the setting up procedures, all of which are contained in this manual for further reference. The Warranty Registration Form must also be completed and returned to us **within 7 days of delivery** in order to validate the Warranty.

PLEASE READ THE FOLLOWING PAGES CAREFULLY BEFORE USING YOUR MACHINE AND KEEP THIS MANUAL IN A SAFE PLACE.



**THIS SAFETY SYMBOL IS TO ALERT OPERATORS OF A HAZARD
THAT MAY RESULT IN INJURY.
ALWAYS FOLLOW INSTRUCTIONS CAREFULLY**

SAFETY DECALS



- GB **ATTENTION** Description of pictograms.
F **ATTENTION** Description des pictogrames.
D **VORSICH** Beschreibung der piktogramme.

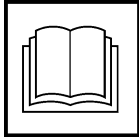

- GB Read Operating manual before use.
F Lisez Manual D'Opération avant l'utilisation.
D Vor der Benutzung, Betriebshandbuch lesen.



- GB Protective eyewear, footwear, gloves and ear protectors must be worn.
F Lunettes de protection, chaussures gants, protégés-oreilles doivent être portées.
D Schutzbrille, schuhe, handschuhe und Gehörschutz getragen werden muss.

IMPORTANT SAFETY WARNINGS



Wessex machines are guarded for your protection, but you must always observe certain elementary precautions. Machines are potentially **dangerous** and should be used with the greatest respect and **ALL OPERATORS MUST** read this manual and be aware of all safety precautions.

1. **NEVER** run pump dry.
2. **ALWAYS** operate in a well ventilated area.
3. Operate on a level surface.
4. **ALWAYS** drain pump and remove the breather plug if likely to freeze.
5. **ALWAYS** flush with clean water after use.
6. Be aware of hot exhaust.
7. Salt water should not be left in the pump for extended periods.
8. The mixer is not suitable for brown rock salt.
9. **ONLY** use granular salt.
10. **ALWAYS** use suitable protective clothing.

WARRANTY

Your Wessex product or equipment is warranted free from defect in workmanship or manufacture for one year from date of purchase. Any parts which appear to us to be defective, either in material or workmanship shall be replaced or repaired at no cost to the purchaser, subject to the following conditions:

1. The registration card enclosed with this booklet must be returned to us within seven days of purchase.
2. Any failure in the machine should be reported in the first instance immediately to your dealer, who will act on your behalf to resolve the matter to your satisfaction.
3. The defective parts will be returned by your dealer to us, accompanied by a full statement describing the failure and the circumstances and conditions in which the failure occurred.
4. The following are specifically excluded from our terms of warranty:
 - a) Fair wear and tear, especially to belts, brushes, blades and spinners.
 - b) Damage to blades or brushes caused through incorrect positioning of the rotor (see instructions).
 - c) Damage caused by neglect or lack of lubrication.
 - d) Damage caused by misuse or abuse.
 - e) Damage caused whilst the machine is in transit.
 - f) Damage caused to the frame of the machine by running the machine with unbalanced rotors, blades or spinners.
 - g) Damage caused to the machine by use with loose nuts, bolts, screws or any other type of fittings.
5. The warranty is for the benefit of the first user only.
6. Wessex International decisions will be final and binding.

Note:

It is recommended that every machine is inspected after one hour of operation to check that all nuts, bolts, screws or any other types of fixings are tight and any loose fixings or components should be rectified as appropriate.

Further inspections should be carried out at regular intervals thereafter.

MIXING THE BRINE

- The mixing ratio of the salt and water will be recommended by the salt supplier/manufacturer.
- Having arrived at the correct mixing percentage, fill the salt tank to the desired level, on the guide marker on the tank.
- **IMPORTANT** only use Granular Salt never use Rock Salt.
- Close the balance tap at the bottom of the water tank before filling with water, then fill to the desired level to achieve the recommended mixture.
- Having filled both tanks you are now ready to mix.
- Before starting the engine / pump make sure that you are in a well ventilated area to avoid a build up of harmful fumes from the engine.
- Start the engine following the Engine Manufacturers Instructions (see Owners Manual).
- Once the engine / pump is operating, the water will circulate through the salt tank, and back into the water tank until the salt is completely dissolved, this process may take up to 50-60 minutes.
- To be 100% sure of the strength of the mixture, you may decide to buy a Refractometer to check the solution strength.
- Before refilling the salt tank, open the balance tap to drain all fluid from the salt tank, then close before mixing.
- Keep the balance tap closed while mixing.

DISPENSING THE BRINE SOLUTION

- Having mixed the brine solution to your desired strength, you are now ready to dispense it into your sprayer.
- Insert the dispensing nozzle into your sprayer and pull the trigger until you have your desired quantity of brine mixture in your sprayer tank.
- Having dispensed the mixture into your sprayer you do not need to leave the engine / pump running, stop the engine.
- To dispense the next lot of brine simply restart the engine / pump and dispense into your sprayer.

CLEANING YOUR MIXER

- Do not leave brine mixture in the pump for extended periods of time.
- To clean the mixer, simply fill with clean water and circulate for a few minutes to flush the mixer through, then drain out completely.
- Wash off any salt or salt water with clean water.
- In freezing conditions never leave water in the pump, always remove the breather plug from the pump.
- To drain the mixer, disconnect the pump intake and open the balance tap, and it will drain completely.

MAINTENANCE

- See Honda Owners Manual for Engine and Pump maintenance.
- Wash all salt and salt water off brine mixer with plenty of clean water.
- Flush through brine mixer with clean water after use.
- Remove the breather plug from the pump if likely to freeze.

SPECIFICATIONS

Tank Capacity	500 Litres
Salt Capacity	130 Litres
Width	1150mm
Length	1150mm
Height	1360mm
Weight (empty)	89kg
Mixing Cycle Time: Full tank	50 to 60 mins
Half tank	25 to 30 mins

PARTS ILLUSTRATION

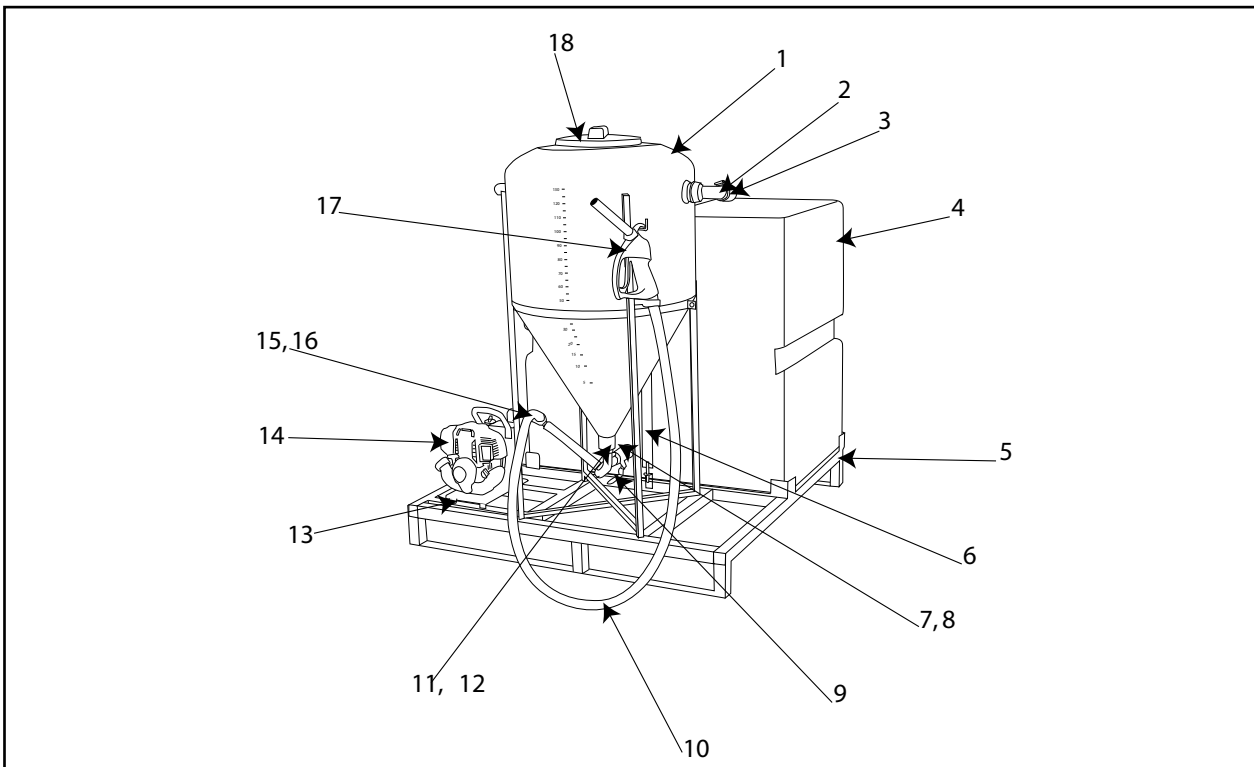

PARTS LIST

Item No.	Part No.	Description	Qty. per Machine
1	WX-AP3001	Salt Tank	1
2	WX-AP3017	1½" Hose Clamp	4
3	WX-AP3006	Overflow Hose Complete With Fittings	2
4	WX-AP3002	Water Tank	1
5	WX-AP3009	Main Frame	1
6	WX-AP3003	Tank Strap	1
7	WX-AP3012	1½" Tank Outlet (Water)	1
8	WX-AP3013	1½" Back Nut	1
9	WX-AP3010	Balance Tap	1
10	WX-AP3007	Discharge Hose	1
11	WX-AP3014	1" Tank Connector / Tail Piece	3
12	WX-AP3015	Seal	3
13	WX-23380	Anti-Vibration Mount	4
14	WX-5960	Engine / Pump	1
15	WX-AP3011	T Connector	2
16	WX-AP3016	1" Hose Clamp	12
17	WX-AP3008	Discharge Nozzle	1
18	WX-AP3004	Salt Tank Lid	1
N / S	WX-AP3005	Water Tank Lid	1



Certificate of CE Conformity

Machine Model:

500L

Description:

Brine Mixer

*I hereby certify that the machine detailed hereon
conforms to:*

**European Directives 2008/42/EC
Supply of Machinery Regulations 2008
As amended 91/368EEC – 93/44EEC – 93/68EEC**

Signed:

A handwritten signature in black ink, consisting of a large, stylized 'R' followed by a horizontal line and a flourish.

.....
Quality Manager

Date:

December 2011

Wessex International

Charlton House, Caxton Place, East Portway Industrial Estate, Andover, Hampshire SP10 3QN
Telephone: 01264 345870 Fax: 01264 345 880

www.wessexintl.com



Wessex International
Charlton House, Caxton Close, East Portway Industrial Estate, Andover Hampshire. SP10 3QN
Telephone: 01264 345870 Fax 01264 345880
e-mail: sales@wessexintl.com

www.wessexintl.com
