

# Operation Manual and Parts Book

Wessex Scrubmaster SM48 & SM66 Rotary Slashers

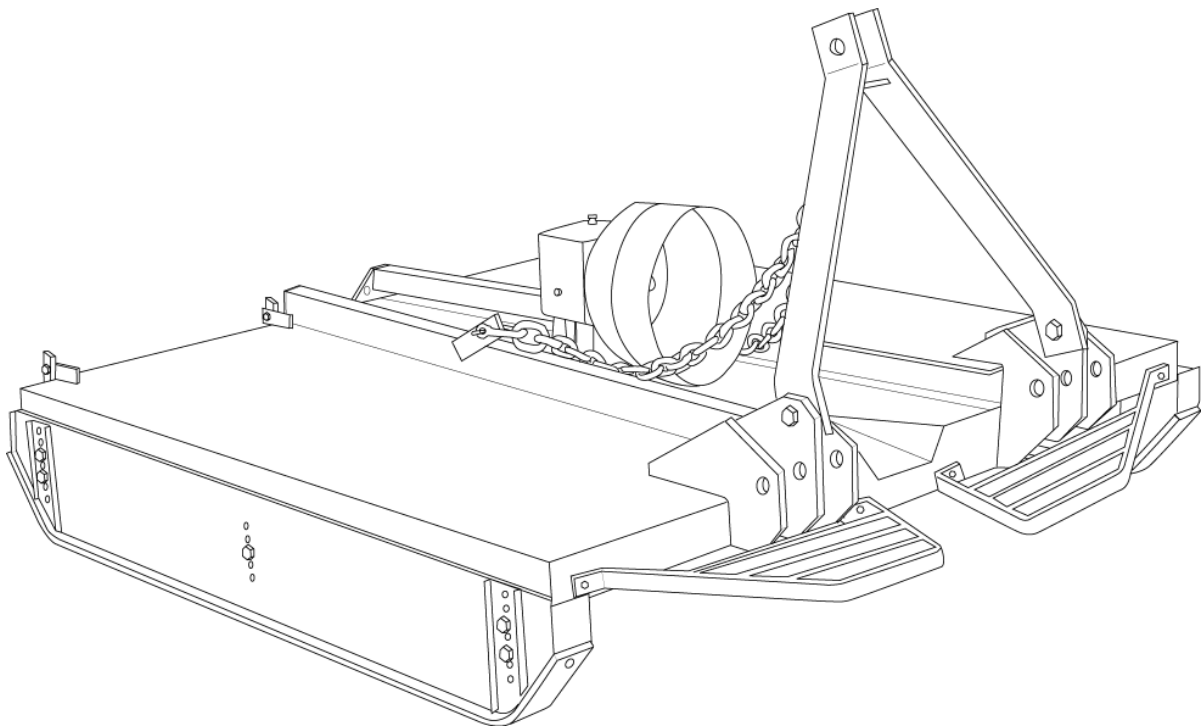

---

Product Code: L2041



# CONTENTS

---

Welcome to your new Wessex Product .....	2
Safety Decals .....	3
Important Safety Warnings .....	4
Warranty .....	5
Setting up your Mower .....	6
Cutting Height Adjustment .....	6
Using your Wessex Mower .....	6
Maintenance .....	7
Specifications .....	7
Parts Illustration - Main Deck Assembly .....	8
Parts Illustration - Chain Conversion .....	8
Parts List - Main Deck Assembly .....	9
Parts List - Chain Conversion .....	9
Parts Illustration / Parts List - Wheel Option Kit .....	10
Parts Illustration / Parts List - P. T. O. Shaft .....	11
Parts Illustration - Gearbox Assembly .....	12
Parts List - Gearbox Assembly .....	13
P.T.O. Shaft Operation and Maintenance .....	14, 15
Notes .....	16
CE Certificate .....	17

## **WELCOME TO YOUR NEW WESSEX PRODUCT**

---

Thank you for purchasing a Wessex product. As a Wessex customer, you now number among the most important people of our business and we will endeavour to give you the best service available through our dealer network.

Please read this Manual carefully and familiarise yourself and other persons that will be using the machine with its contents, to ensure the optimum performance and working life of your machine. It is advisable that a copy of this Manual is kept in the workshop and one copy with the machine. Further copies are available through your dealer.

On delivery, your dealer should go through the workings of the machine with you, explaining the setting up procedures, all of which are contained in this manual for further reference. The Warranty Registration Form must also be completed and returned to us **within 7 days of delivery** in order to validate the Warranty.

**PLEASE READ THE FOLLOWING PAGES CAREFULLY BEFORE USING YOUR MACHINE  
AND KEEP THIS MANUAL IN A SAFE PLACE.**



**THIS SAFETY SYMBOL IS TO ALERT OPERATORS OF A HAZARD  
THAT MAY RESULT IN INJURY.  
ALWAYS FOLLOW INSTRUCTIONS CAREFULLY**

## SAFETY DECALS

---



- GB **ATTENTION** Description of pictograms.  
 F **ATTENTION** Description des pictogrames.  
 D **VORSICH** Beschreibung der piktogramme.

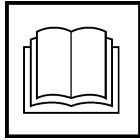

- GB Read Operating manual before use.  
 F Lisez Manual D'Opération avant l'utilisation.  
 D Vor der Benutzung, Betriebshandbuch lesen.



- GB Ear defenders must be worn.  
 F Défenseurs des oreilles doivent être portés.  
 D Gehörschutz getragen werden.

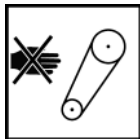

- GB Never remove guards or attempt adjustment until rotor has stopped.  
 F Ne retirez jamais les gardes ou d'ajustement tentative jusqu'à ce que toutes les pièces mobiles ont été interrompus.  
 D Schutzvorrichtung niemals abnehmen oder einstellung versuchen, bevore der rotor abstellt.



- GB Bystanders must be at least 20 metres from machine range of action.  
 F Des spectateurs doivent s'écarter au moins 20 mètres du rayon d'action de la machine.  
 D Umstehenden müssen sich mindestens 20 meter vom maschinenbetriebsraum entfernen.



- GB Stand clear. Flying objects possible.  
 F S'écarter! Possibilité d'objets volants.  
 D Zurückbleiben! Herumfliegende objekte möglich

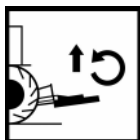

- GB Lift Machine before turning  
 F Levez la machine avant de la tourner  
 D Maschine aufheben, bevor man sie umdreht.

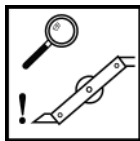

- GB Examine blades regularly. The operator is responsible for machine damage caused by unbalanced rotors.  
 F Examinez des lames régulièrement. L'opérateur est responsable des dommages à la machine provoqués par des rotors mal équilibrés  
 D Klingen regelmäßig kontrollieren. Der abeiter ist an den durch unausgewogenen rotoren maschinenschäden verantwortlich.



- GB Keep hands and feet clear  
 F Garder les mains et les pieds.  
 D Halten Sie Ihre Hände und Füße.

## IMPORTANT SAFETY WARNINGS

---



Wessex machines are guarded for your protection, but you must always observe certain elementary precautions. Machines are potentially **dangerous** and should be used with the greatest respect and **ALL OPERATORS MUST** read this manual and be aware of all safety precautions.

1. **NEVER** attempt any adjustment whatsoever, unless the machine is **COMPLETELY** at a standstill.
2. **NEVER** attempt to clear any obstructions around the mower unless the machine is **COMPLETELY** at a standstill.
3. **NEVER** remove belt guards unless the machine is **COMPLETELY** at a standstill.
4. **NEVER** remove safety guards which are provided for your protection.
5. **NEVER** operate the mower with people behind, keep everybody (especially children and animals) at a safe distance, **minimum 20 metres**.
6. Stand well back from the machine when cutters are spinning.
7. Regularly inspect the **BLADES AND FIXING BOLTS** to ensure that they are in tip-top condition. Replace blades **IMMEDIATELY** if any signs of fracture or excess wear becomes apparent. Serious damage, which is excluded from our warranty conditions, may result from using your mower with an unbalanced rotor. When replacing blades, always fit new mounting bolts and nuts to ensure that the rotor is balanced and running smoothly.

### HEALTH AND SAFETY - Noise at Work Regulations

#### READING AT THE OPERATORS EAR

**Wessex Scrubmaster Rotary Slasher : With Blades Approximately 98.5 D.B.A.  
With Chains Approximately 90.5 D.B.A.**

Depending on conditions and material being cut, this reading may alter, it is therefore advisable for users to do their own assessment.



In compliance with the above regulations, Ear Protectors must be worn when operating machinery.

## WARRANTY

---

Your Wessex product or equipment is warranted free from defect in workmanship or manufacture for one year from date of purchase. Any parts which appear to us to be defective, either in material or workmanship shall be replaced or repaired at no cost to the purchaser, subject to the following conditions:

1. The registration card enclosed with this booklet must be returned to us within seven days of purchase.
2. Any failure in the machine should be reported in the first instance immediately to your dealer, who will act on your behalf to resolve the matter to your satisfaction.
3. The defective parts will be returned by your dealer to us, accompanied by a full statement describing the failure and the circumstances and conditions in which the failure occurred.
4. The following are specifically excluded from our terms of warranty:
  - a) Fair wear and tear, especially to belts, brushes, blades and spinners.
  - b) Damage to blades or brushes caused through incorrect positioning of the rotor (see instructions).
  - c) Damage caused by neglect or lack of lubrication.
  - d) Damage caused by misuse or abuse.
  - e) Damage caused whilst the machine is in transit.
  - f) Damage caused to the frame of the machine by running the machine with unbalanced rotors, blades or spinners.
  - g) Damage caused to the machine by use with loose nuts, bolts, screws or any other type of fittings.
5. The warranty is for the benefit of the first user only.
6. Wessex International decisions will be final and binding.

**Note:**

**It is recommended that every machine is inspected after one hour of operation to check that all nuts, bolts, screws or any other types of fixings are tight and any loose fixings or components should be rectified as appropriate.**

**Further inspections should be carried out at regular intervals thereafter.**

## SETTING UP YOUR MOWER

---

- The Wessex Scrubmaster will give excellent results on a wide variety of conditions, but it is important to set the machine up correctly to achieve this.
- Reverse your tractor up to your mower, and connect the bottom link arms onto the bottom link pins and secure with lynch pins.
- Adjust the right hand link arm so that both bottom link pins are at the same level.
- Connect the top link and adjust so that when in work the 'A' frame can float backwards and forwards to follow the ground contours.
- Connect the P.T.O. shaft, ensuring that the shaft is not too long for your tractor. If necessary, the shaft, which is of tubular section, may be easily cut with a hacksaw. See P.T.O. instructions on pages 14 and 15.
- Ensure that the front leg guards are fitted before operating the machine.

## CUTTING HEIGHT ADJUSTMENT

---

- First stop the tractor before making any adjustments to the machine.
- Lift your Scubmaster up on the tractors hydraulics and simply raise or lower the side skids to adjust the cutting height.
- Once you have set the cutting height lower the machine onto the ground and set the top link so that the lifting chain is loose so that the machine can follow the ground contours well.
- Always ensure that the full length of the skids is in contact with the ground to avoid excessive scuff marks.

## USING YOUR WESSEX SCRUBMASTER

---

- The correct P.T.O. speed for your mower is 540 rpm. NEVER use the mower at a P.T.O. speed in excess of this.
- Before engaging the P.T.O. ensure that there are no bystanders within 10 metres.
- Having set the mower up in accordance with the instructions above, engage the P.T.O., and selecting a low forward speed, gently release the clutch.
- You will establish by experience what is the optimum forward speed for your conditions, but on regularly maintained grass, you should achieve a good finish at 5-6 mph.



## USING YOUR WESSEX SCRUBMASTER

---

- Long wet grass will have to be cut more slowly. In very difficult conditions better results are obtained by making two passes, in opposite directions - lowering the cutting height for the second pass.
- When cutting scrub i.e. gorse, bracken and saplings you will need to select a suitable forward speed and operate with caution as heavier material may exit the rear of the machine.
- It is advised that when working on heavy scrub application you should mount a weld mesh guard on the rear of the tractor to protect both the operator and the tractor.

## MAINTENANCE

---

### Periodically (Every 50 hours)

- Grease the P.T.O. shaft bearings.
- Grease the P.T.O. shaft sliding tube.
- Check the gearbox oil level, top up with EP90 gear oil.

### Regularly (Every 10 hours)

- Inspect the condition of the cutting blades or chains.
- Replace any chipped or broken blades or chains.
- **Do not run with unbalanced rotor this will damage your machine and is not covered by the warranty.**
- **The use of non Genuine Wessex Parts will invalidate Warranty.**

## SPECIFICATIONS

---

	<b><u>SM48</u></b>	<b><u>SM66</u></b>
Cutting Width (cm)	120	170
Overall Width (cm)	130	180
Weight (kg) Fitted with Chains	307	468
Weight (kg) Fitted with Blades	324	516
H.P. Requirement	30	45

## PARTS ILLUSTRATION - MAIN DECK

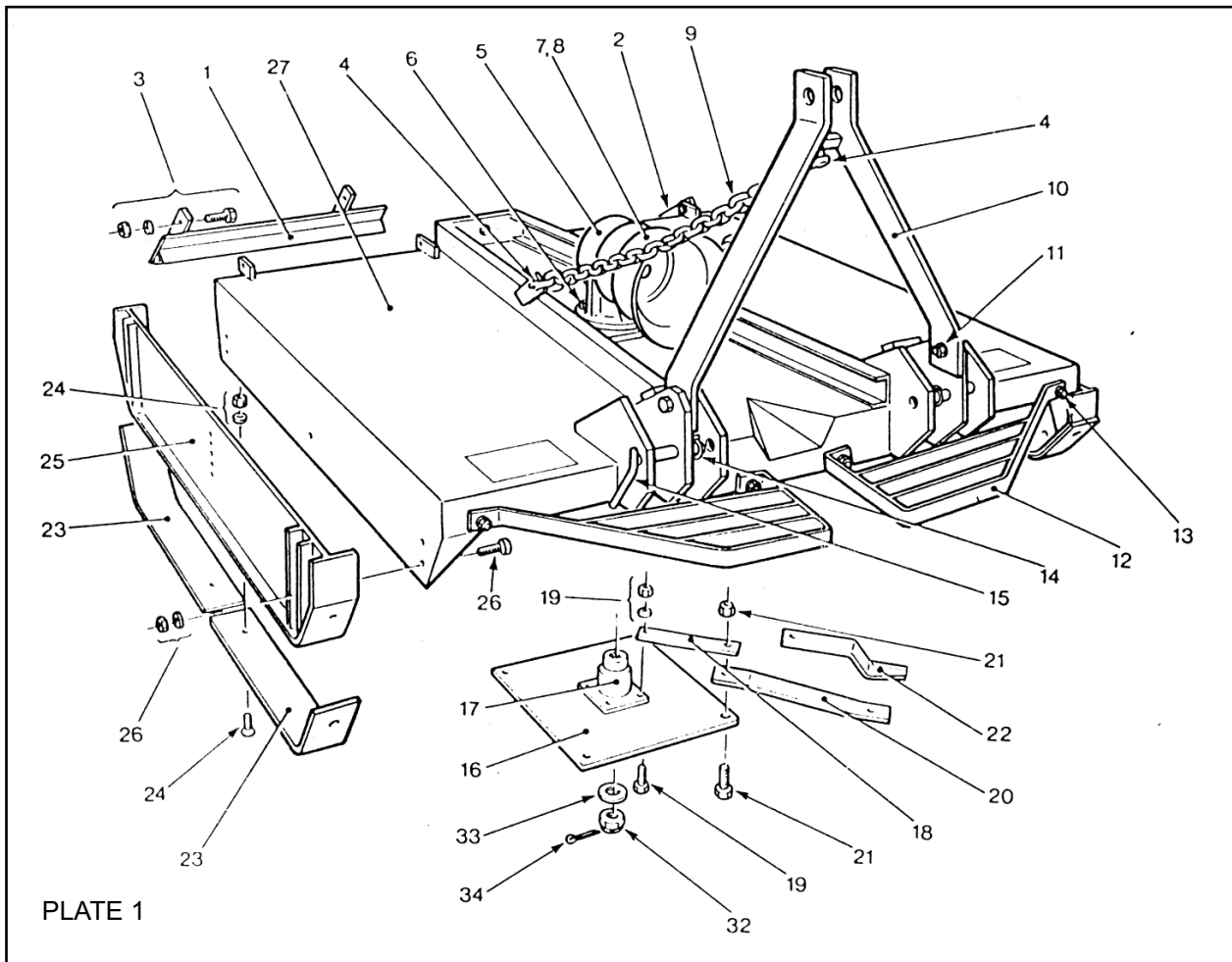

## PARTS ILLUSTRATION - CHAIN CONVERSION

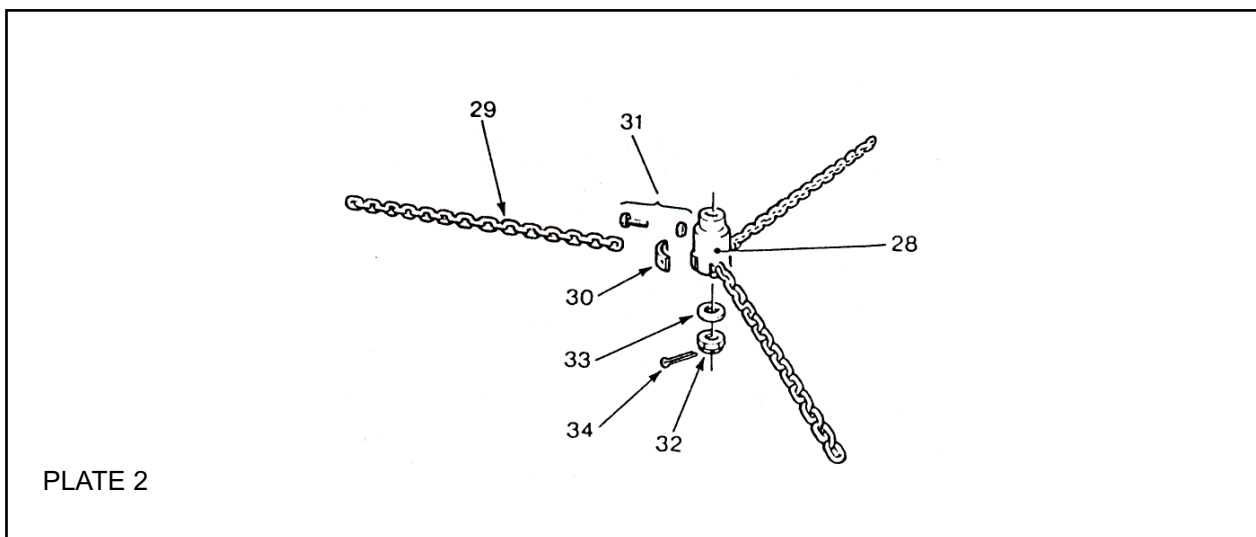

**PARTS LIST - MAIN DECK - PLATE 1**

Item No.	SM66 Part No.	Qty	SM48 Part No.	Qty	Description
1	WX-7577	1	WX-0778	1	Right Hand Tailgate
2	WX-7477	1	WX-0678	1	Left Hand Tailgate
3	WX-1901	2	WX-1901	1	Tailgate Fastening Set
4	WX-0629	2	WX-0129	2	Shackle
5	WX-0957	1	WX-0957	1	Complete Gearbox
6	WX-2301	1	WX-2301	1	Gearbox Fastening Set
7	WX-6477	1	WX-6477	1	Cone Guard
8	WX-3701	1	WX-3701	1	Cone Guard Fastening Set
9	WX-1930	1	WX-1130	1	Chain Assembly
10	WX-5080	1	WX-5880	1	'A' Frame
11	WX-3101	1	WX-3101	1	Fastening Set
12	WX-8777	2	-	-	Front Guard
13	WX-1701	2	-	-	Guard Fastening Set
14	WX-0127	2	WX0227	2	Linch Pin
15	WX-0428	2	WX-0326	2	Link Pin
16	WX-0870	1	WX-2770	1	Mounting Plate
17	WX-1070	1	WX-1070	1	Blade Hub
18	WX-0970	4	WX-3170	4	Clevis Plate
19	WX-0301	1	WX-0301	1	Mounting Plate Fastening Set
20	WX-1170	4	-	-	Blade
21	WX-1770	4	WX-1770	4	Blade Fastening Set
22	-	-	WX-3270	4	Blade
23	WX-0475	2	WX-0375	2	Skid Shoe Set
24	WX-2101	2	WX-2101	2	Side Shoe Fastening Set
25	WX-1274	2	WX-1474	2	Skid
26	WX-2201	2	WX2201	2	Skid Fastening Set
27	WX-3279	1	WX-1279	1	Mainframe

**PARTS ILLUSTRATION - CHAIN CONVERSION - PLATE 2**

Item No.	SM66 Part No.	Qty	SM48 Part No.	Qty	Description
28	WX-1270	1	WX-1270	1	Chain Hub
29	WX-1370	1	WX-1370	1	Chain Set
30	WX-1470	3	WX-1470	3	Chain Mounting Cleat
31	WX-2501	3	WX-2501	3	Cleat Fastening Set
32	GXS-8.2.2.00055	1	-	1	Nut
33	GXS-8.3.2.00764	1	-	1	Washer
34	GXS-8.4.7.00146	1	-	1	Split Cutter

## PARTS ILLUSTRATION - WHEEL OPTION KIT PLATE 3

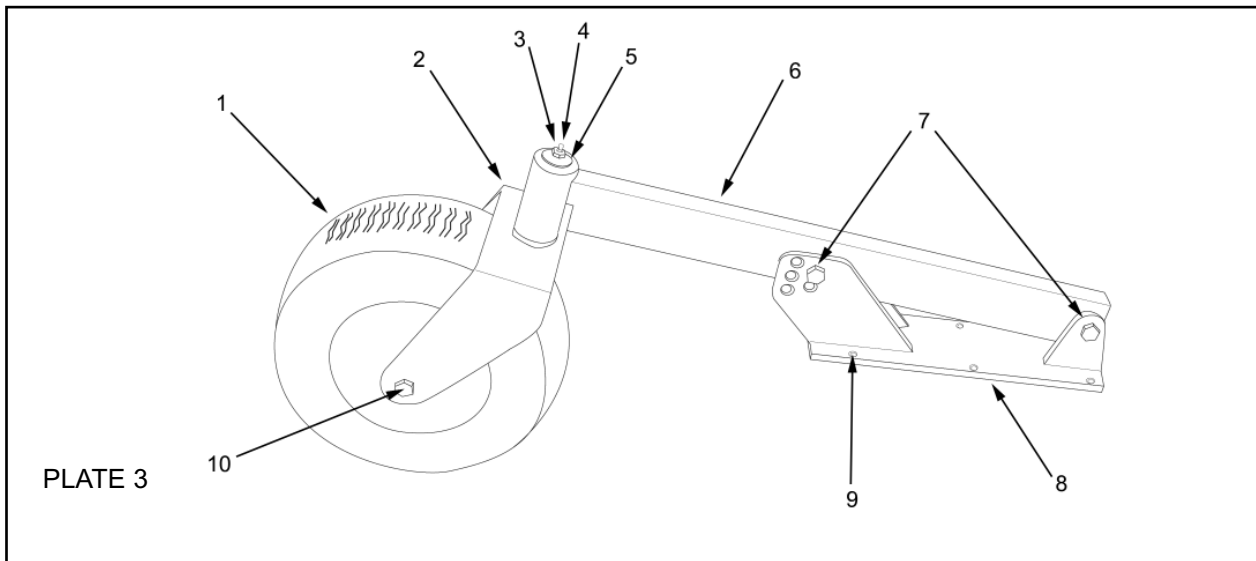

## PARTS LIST - WHEEL OPTION KIT - PLATE 3

Item No.	Part No.	Description	Qty. per Machine
1	WX-3152A	SM Solid Wheel (Foam Filled)	1
2	WX-5553	Wheel Fork	1
3	WX1520	Special Washer	1
4	WX-0246	Grease Nipple	1
5	WX-7102	Pivot Screw	1
6	WX-10951	Scrubmaster Wheel Arm	1
7	WX-5802	Wheel Arm Fastening Set	1
8	WX-5702	Wheel Arm Bracket Fastening Set	1
9	WX-11051	Wheel Arm Bracket	1
10	WX-2503	Wheel Axle	1

## PARTS ILLUSTRATION - P. T. O. SHAFT PLATE 4

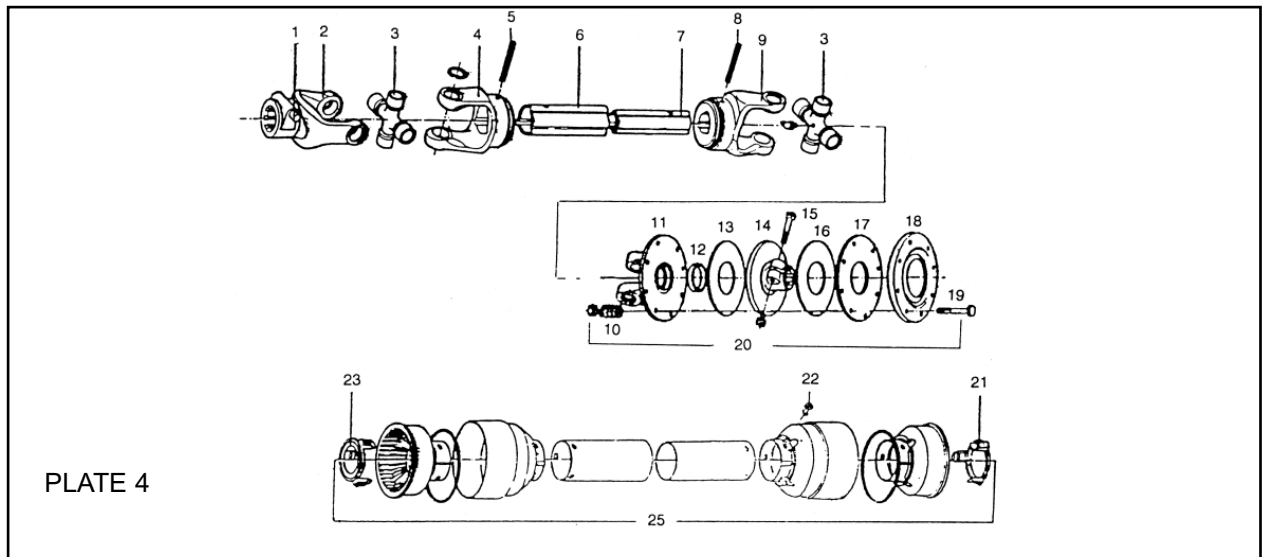

## PARTS LIST - P. T. O. SHAFT

Item No.	Part No.	Description	Qty. per Machine
1	PTO-026004	QR Pin Assembly	1
2	PTO-026001	Yoke 1 $\frac{3}{8}$ Z6	1
3	PTO-016004	Unit Package	2
4	PTO-016028	Yoke - Outer Disc	1
5	PTO-000017	Expansion Pin	1
6	PTO-160200	Profile Tube 3m	1
7	PTO-150100	Profile Tube 3m	1
8	PTO-000016	Expansion Pin	1
9	PTO-016029	Yoke - Inner Tube	1
10	PTO-019017	Spring	8
11	PTO-016037	Flanged Yoke	1
12	PTO-019019	Bush	1
13	PTO-019018	Friction Disc	1
14	PTO-0180018	Hub 1 $\frac{3}{8}$ Z6	1
15	PTO-000502	Bolt Complete With Nut	1
16	PTO-019018	Friction Disc	1
17	PTO-019014	Inner Plate	1
18	PTO-019116	Pressure Plate	1
19	PTO-000549	Bolt Complete With Nut	8
20	PTO-262011	Disc Clutch Assembly	1
21	PTO-016015	Inner Collar	1
22	PTO-000019	Lock Bolt	1
23	PTO-016016	Outer Collar	1
24	PTO-016025	Chain Assembly	1
25	PTO-260212F	Guard Assembly	1

# PARTS ILLUSTRATION - 'GEARBOX ASSEMBLY

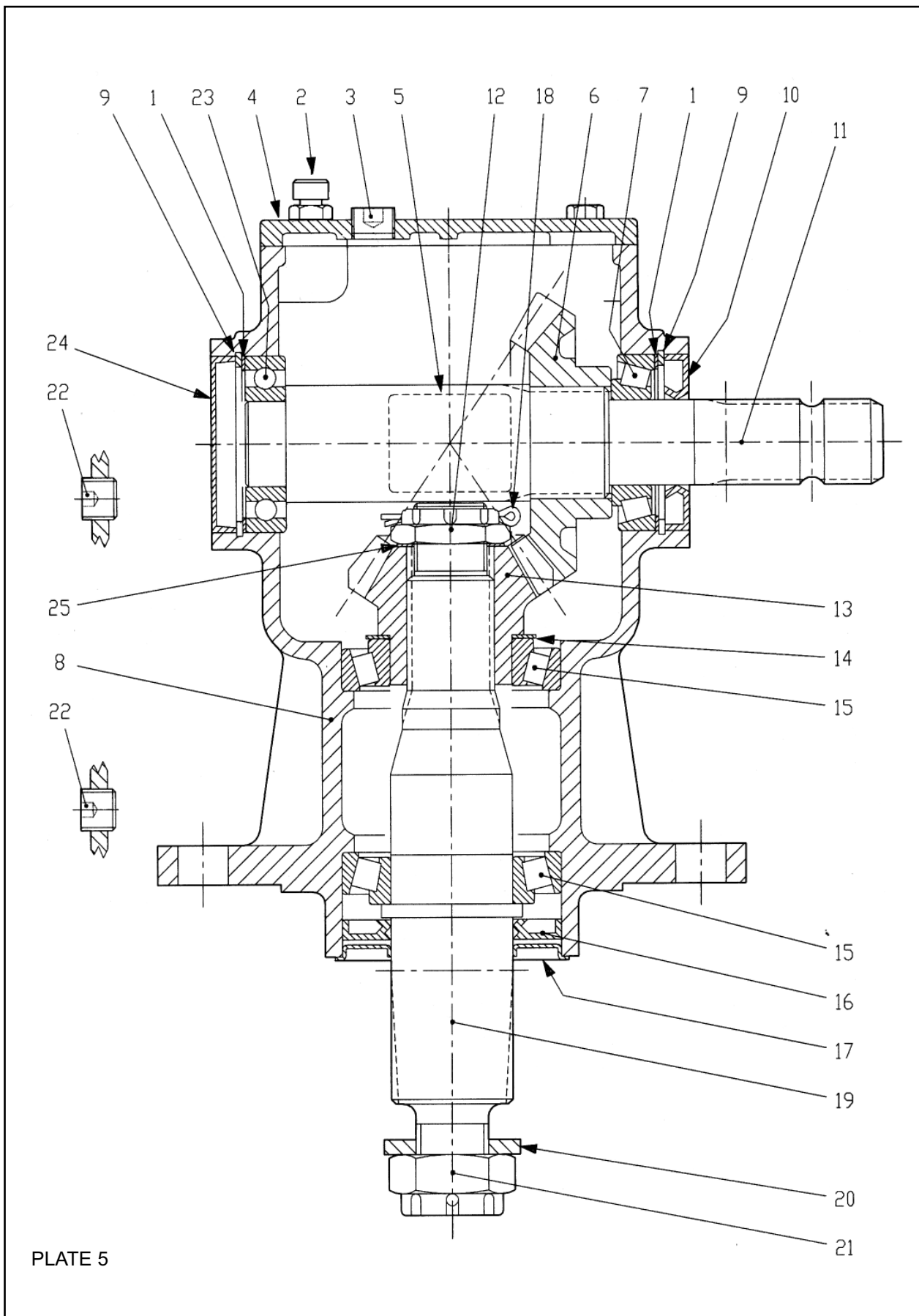

**PARTS LIST - GEARBOX ASSEMBLY - PLATE 5**

<b>Item No.</b>	<b>Part No.</b>	<b>Description</b>	<b>Qty</b>
1	GXS-0.248.7500.00	Shim Kit	2
2	GXS-8.6.7.00269	½" Gas Oil Filler Vent Plug	1
3	GXS-8.6.6.00088	½" Gas Oil Plug With Embedded Hex	1
4	GXS-0.140.1302.00	Cover	1
5	GXS-0.124.7135.00	Name Plate	1
6	GXS-0.132.6004.00	Crown Z21 M5.7	1
7	GXS-8.0.9.00026	Roller Bearing	1
8	GXS-0.140.0300.00	Casting & Maching	1
9	GXS-8.5.2.00131	Snap Ring	2
10	GXS-8.7.3.00055	Oil Seal	1
11	GXS-0.140.2000.00	Input Shaft	1
12	GXS-0.132.7106.00	Castle Nut	1
13	GXS-0.116.6204.00	Pinion Z14 M5.7	1
14	GXS-0.712.7500.00	Shim Kit	1
15	GXS-8.0.9.00469	Roller Bearing	2
16	GXS-8.7.1.01107	Dust Lip	1
17	GXS-0.139.7100.00	Protective Washer	1
18	GXS-8.4.7.01111	Cotter Pin	1
19	GXS-0.140.3002.00	Output Shaft	1
20	GXS-0.139.7101.00	Flat Washer	1
21	GXS-0.140.7102.00	Castle Nut	1
22	GXS-8.6.6.00201	¾" Gas Oil Plug With Embedded Hex	2
23	GXS-8.0.1.00870	Ball Bearing	1
24	GXS-8.7.0.00744	Oil Cap	1
25	GXS-0.102.7510.00	Shim	1

## PTO SHAFT OPERATION AND MAINTENANCE

---

### IMPORTANT!

**PTO drive shafts must only be used for their intended purpose.**

PTO drive shafts are designed for specific machine types and power requirements.

They must not be replaced by other models.

Ensure that the PTO drive shaft is securely connected.

**Only use a completely protected drive system:**

PTO drive shaft with complete guard and complementary guard on tractor and implement. A complete guard is essential in all working positions.

### LUBRICATION

---

Lubricate with quality grease before starting work and every 8 operating hours.

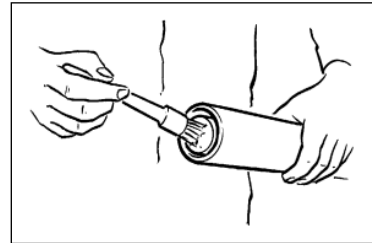

Clean and grease the PTO drive shaft before each prolonged period of non-use.

Grease the guard tubes in winter to prevent freezing.

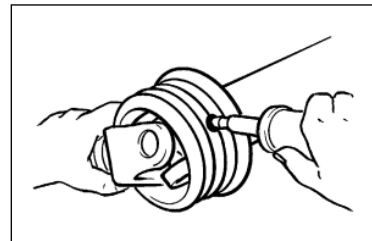

### COUPLING THE PTO SHAFT

---

Clean and grease the PTO and PIN

#### **Q.-d pin**

Press q.-d. pin and simultaneously push PTO drive shaft onto PTO until pin engages.

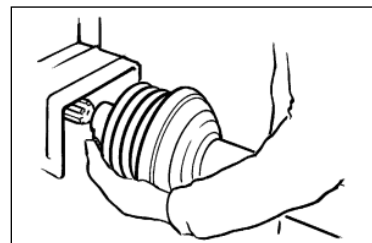



# PTO SHAFT OPERATION AND MAINTENANCE

---

## LENGTH ADJUSTMENT

---

To adjust the length, hold the half-shafts next to each other in the shortest working position and mark them.

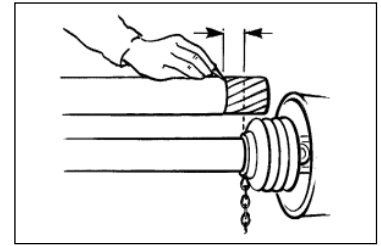

Shorten inner and outer guard tubes equally.

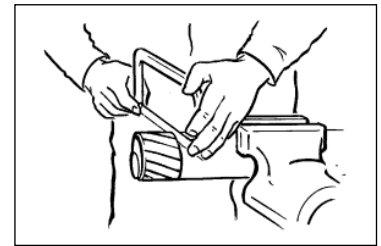

Shorten inner and outer sliding profiles by the same length as the guard tubes.

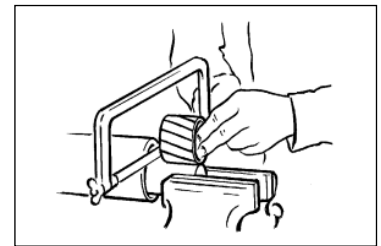

Round off all sharp edges and remove burrs.  
Grease sliding profiles.

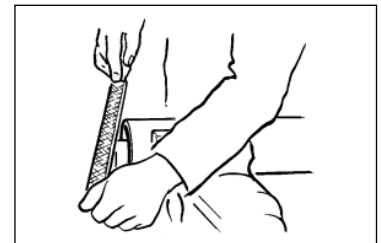

No other changes may be made to the PTO drive shaft and guard.

## CHAINS

---

Chains must be fitted so as to allow sufficient articulation of the shaft in all working positions.

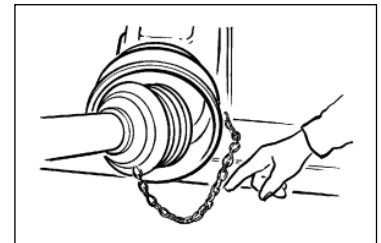

The PTO drive shaft must not be suspended from the chains!

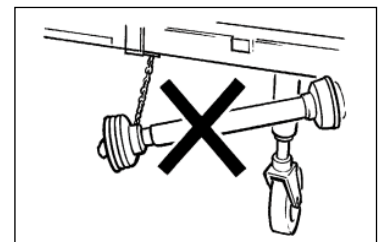

## NOTES

---



## *Certificate of CE Conformity*

**Machine Model:**

SM48, 66

**Description:**

Rotary Slasher

*I hereby certify that the machine detailed hereon  
conforms to:*

**European Directives 2008/42/EC  
Supply of Machinery Regulations 2008  
As amended 91/368EEC – 93/44EEC – 93/68EEC**

**Signed:**

.....  
Quality Manager

A handwritten signature in black ink, consisting of a large, stylized 'R' followed by a horizontal line and a small flourish.

Date:

September 2011

### **Wessex International**

Charlton House, Caxton Place, East Portway Industrial Estate, Andover, Hampshire SP10 3QN  
Telephone: 01264 345870 Fax: 01264 345 880

[www.wessexintl.com](http://www.wessexintl.com)



**Wessex International**  
**Charlton House, Caxton Close, East Portway Industrial Estate, Andover Hampshire. SP10 3QN**  
**Telephone: 01264 345870 Fax 01264 345880**  
**e-mail: [sales@wessexintl.com](mailto:sales@wessexintl.com)**

**[www.wessexintl.com](http://www.wessexintl.com)**

---